

### Features

- Quick response for surge.
- High impulse current capacity.
- It can withstand alternating current.
- Excellent insulation resistance and small capacitance.
- Recommendation of ITU-T conformity.

### Applications

- Telephone, PBX, Wireless base station, Optical transmission equipments, CATV transmission equipments, Fire alarm systems and Home security systems.

### Dimensions

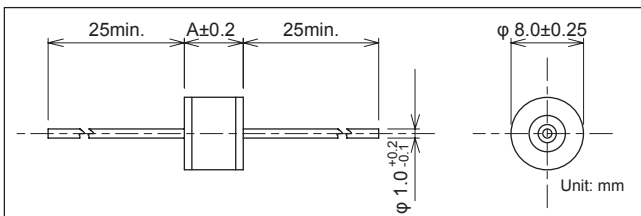

Model Number	A
R28-□□□-BHL	5.7
R28-□□□-BJL	6.05
R28-□□□-BKL	7.5



Safety Standard	File No.
UL :UL497B	E139599
:UL1449	E332107

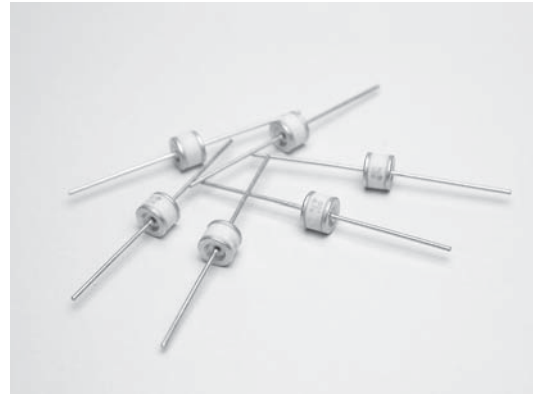

### Model numbering system

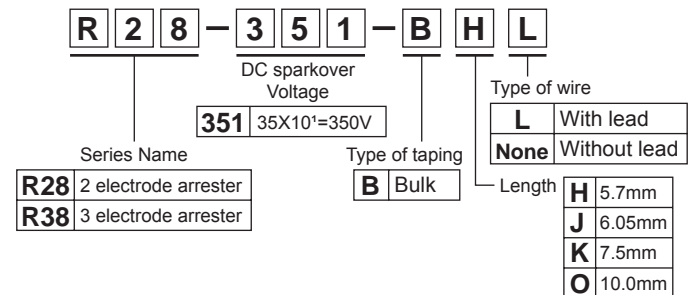

### Electrical Specifications (Low Voltage Type)

(Conforms to ITU-T)

Safety Standard	Model Number	DC Sparkover Voltage 100V/s~2,000V/s (V)	Impulse Sparkover Voltage 100V/μs (V)	Impulse Discharge Current 8/20ms (A)	Alternating Discharge Current 50Hz, 1s 10 times (A)	Impulse Life Test 10/1,000μs 100A (times)	Insulation Resistance min. (MΩ)	Capacitance max. (pF)
UL 497B	-							
UL 1449								
O	R28-900-BHL	90V±20%	450	10,000	10	300	10 <sup>4</sup>	1.5
O	R28-151-BHL	150V±20%	500					
O	R28-231-BHL	230V±20%	600					
O	R28-251-BHL	250V±20%						
O	R28-301-BHL	300V±20%	650					
O	R28-351-BHL	350V±20%	750					
O	R28-401-BHL	400V±20%	800					
O	R28-471-BHL	470V±20%	900					
O	R28-601-BHL	600V±20%	1,300					

### Electrical Specifications (High Voltage Type)

Safety Standard	Model Number	DC Sparkover Voltage 500V/s (V)	Impulse Discharge Current 8/20μs (A)	Impulse Life Test 8/20μs 1,000A (times)	Insulation Resistance min. (MΩ)	Capacitance max. (pF)	Withstand Voltage test
UL 1449							
O <sup>*1</sup> <sub>*2</sub>	R28-801-BHL	800V±20%	10,000	300	10 <sup>4</sup>	1.5	-
O <sup>*1</sup> <sub>*2</sub>	R28-102-BHL	1,000V±20%					
O <sup>*1</sup> <sub>*2</sub>	R28-152-BHL	1,500V±20%					
O <sup>*1</sup> <sub>*2</sub>	R28-242-BJL	2,400V±20%					
O <sup>*1</sup> <sub>*2</sub>	R28-302-BKL	3,000V±20%					
O <sup>*1</sup> <sub>*2</sub>	R28-362-BKL	3,600V±20%					
O <sup>*1</sup> <sub>*2</sub>	R28-402-BKL	4,000V±20%					
O <sup>*1</sup> <sub>*2</sub>	R28-452-BKL	4,500V±20%					

\*1 Rated voltage AC125V: Approved if it is connected to UL approved varistor (V1.0mA≥270V, D≥φ 14mm).

\*2 Rated voltage AC250V: Approved if it is connected to UL approved varistor (V1.0mA≥470V, D≥φ 14mm).