

TCP7330 Series

Plug (5P) $h = 9$ mm

Half Lock Type



TCP7335-010100

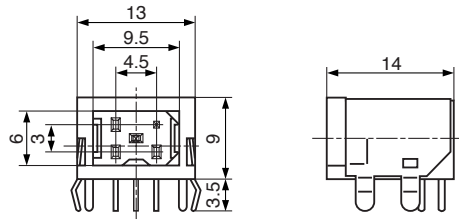

Contacts	Key Type I	Key Type II	Key Type III	Hole Layout (Bottom View)
3				
	TCP7333-010100	TCP7333-011100	TCP7333-012100	
4				
	TCP7334-010100	TCP7334-011100	TCP7334-012100	
5				
	TCP7335-010100	TCP7335-011100	TCP7335-012100	

Specifications

Rating	Pin Nos. 1~3	12 V DC 5 A Max.
	Pin Nos. 4, 5	12 V DC 1 A Max.
Insulation Resistance	50 MΩ Min. at 250 V DC	
Dielectric Strength	250 V AC/1 min	
Contact Resistance	30 mΩ Max.	
Insertion Force	49 N Max.	
Withdrawal Force	9.8 ~ 49 N	

Notes

- Socket Suitability.
The Sockets are suitable for use with the TCS7330 Series (see page 6).
- Color: Black
- : Upon your request (standard item).