

# Attenuators

## Continuously Variable

### 1 - 18 GHz - Level Set Types - Subminiature

#### Specifications

**Frequency Range:** 1 - 18 GHz as noted on chart

**Attenuation Range:** 0 - 40 dB as noted on chart

**Impedance:** 50 Ohms

**VSWR:** 1.50 max typical

**Insertion Loss:** 0.5 dB max

**Power:** 5 Watts average

**Peak Power:** 3 Kilowatts

**Operating Temperature Range:** -65 to +125C

**Resetability:** 0.1 dB max

**Finish :** Housing is painted grey per MIL-F-14072

Connectors are Passivated Stainless Steel



Midwest Microwave's series of Subminiature Continuously Variable Attenuators were designed to meet the most stringent environmental conditions. The units are available in a Standard simple locking type configuration, a Panel mount type with a knob, or a panel mount type with a Turns-counting dial for reference setting or calibration is also an available option. SMA connector configurations are standard, however Type N or TNC connector configurations are also available (see note).

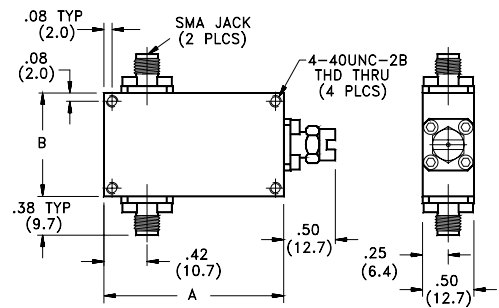

**S = Standard Locking Nut Type**

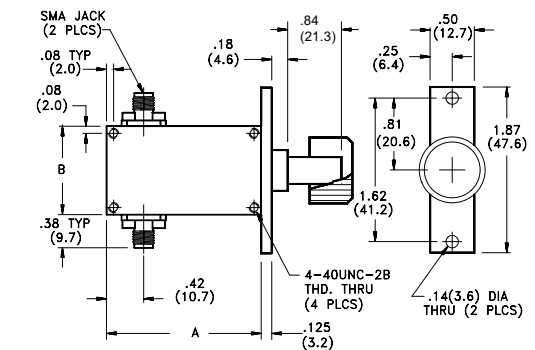

**P = Panel Mounting Type**

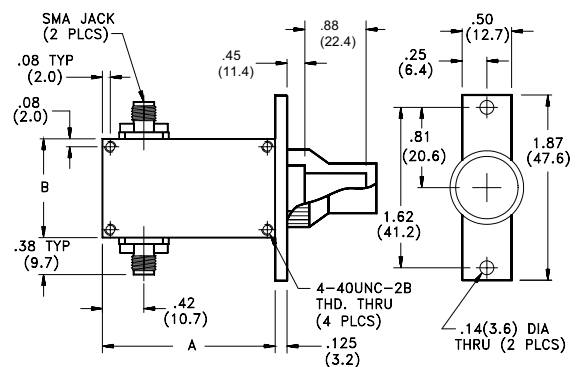

**T = Turns Counting Panel Mounting Type**

Level Set Models			
Frequency Range	Atten Range	Model Number	Case Style
1.0 - 2.0	10	CVA-LS81-10-SMA-79	2
	20	CVA-LS82-20-SMA-79	2
4.0 - 8.0	10	CVA-LS83-10-SMA-79	1
	20	CVA-LS83-20-SMA-79	1
	30	CVA-LS83-30-SMA-79	2
8.0 - 12.4	10	CVA-LS84-10-SMA-79	1
	20	CVA-LS84-20-SMA-79	1
	30	CVA-LS84-30-SMA-79	1
	40	CVA-LS84-40-SMA-79	2
7.0 - 18.0	10	CVA-LS85-10-SMA-79	1
	20	CVA-LS85-20-SMA-79	1
	30	CVA-LS85-30-SMA-79	1
	40	CVA-LS85-40-SMA-79	2
12.4 - 18.0	10	CVA-LS86-10-SMA-79	1
	20	CVA-LS86-20-SMA-79	1
	30	CVA-LS86-30-SMA-79	1
	40	CVA-LS86-40-SMA-79	2

#### Notes:

1. To designate a Panel type option, substitute "P" for "S" in the Model No..
2. To designate a Turns-Counting Dial option, substitute "T" for "S" in the Model No..
3. To designate Type N or TNC connectors, substitute "NNN" or "TNC" for "SMA" in the Model No.