

A

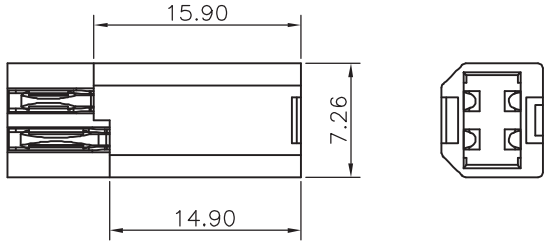
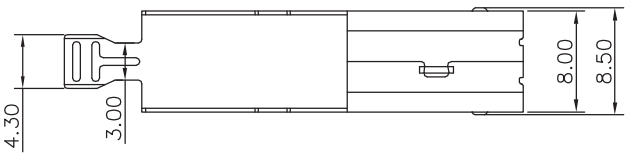

- Material:**
- Housing: PBT+30%GF UL 94V-0
 - Contact: Brass
 - Shell: SPCC
 - Contact: 5μ Gold Contact Plating over Nickel Plated
 - Shell: Nickel Over All Plating

A

B

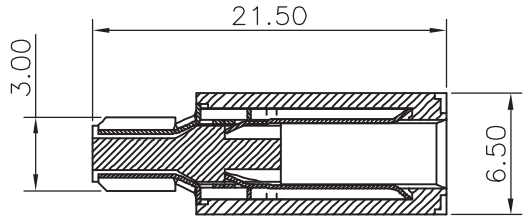
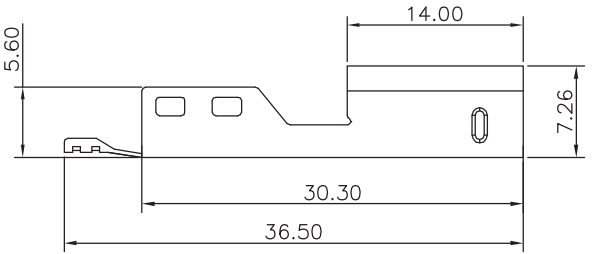

- Electrical:**
- Voltage Rating: 30V
 - Current Rating: 1.5A
 - Contact Resistance Terminal: 30MΩ Max
 - Dielectric Withstanding Voltage: 500V AC
 - Insulation Resistance: 1000MΩ Min

B

C

D

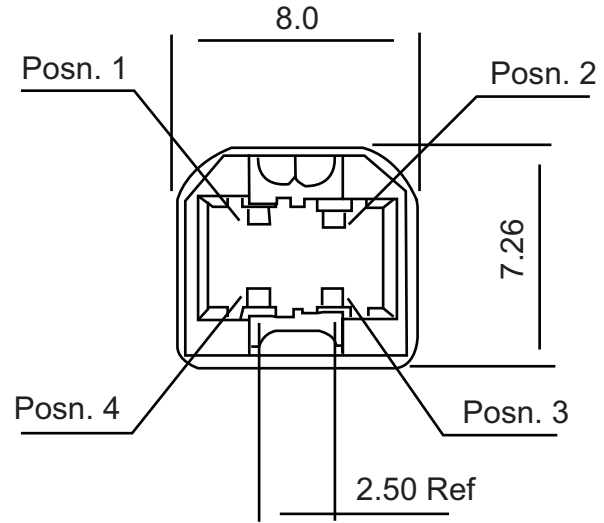
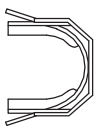
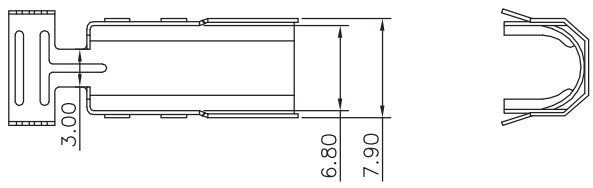

- Mechanical:**
- Mating: 35N Max
 - Withdrawl Force: 10N Min
 - Durability: 1500 Cycles Min

D

E

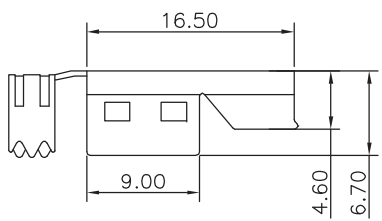

- Environmental:**
- Temperature Range: -20°~+85°C

E

F

Unit: MM±0.15MM

G

Scale	1:1						Name	Item No.
TOLERANCE						Drawn	10.19.11	A-USBPB-R Title USB, Type B, Assembly-Type, Version 1.1
X.X	±0.40					Approved		
X.XX	±0.25							
X.XXX	±0.15							
Angle	±3°							Drawing No.
								Replace
								Sheet
		Modification	Date	Name				



rev00

G

H

H