

| Rev | AWO # | Description | Date   | Appr |
|-----|-------|-------------|--------|------|
| -   |       | RELEASED    | 8/6/04 |      |

APPROVED: \_\_\_\_\_  
 DATE: \_\_\_\_\_ TITLE: \_\_\_\_\_

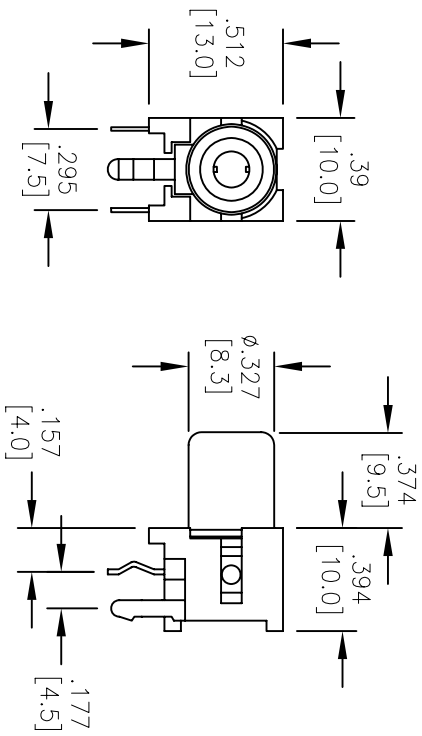

RECOMMENDED PCB LAYOUT  
 (BOTTOM VIEW)

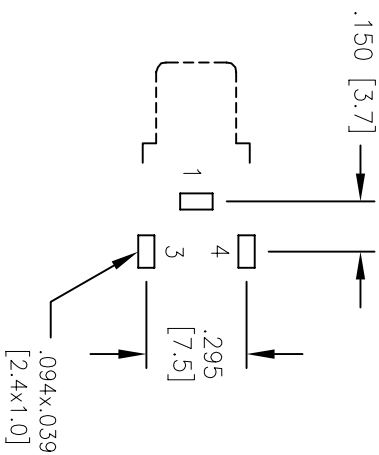

**SPECIFICATIONS:**

**Material:**

Insulator: PBT, glass reinforced thermoplastic, rated UL 94V-0

Insulator colors: Red, White, Black & Yellow

Bushing: Brass, Nickel plated

Contacts: Brass

**Plating:**

Tin or Silver over Copper underplate.

**Electrical:**

Operation voltage: 12V DC max.

Current rating: 1 Amp max

Contact resistance: 30 mohms max.

Insulation resistance: 100 Mohms min

Dielectric withstanding voltage: 500 VAC for 1 minute

**Environmental:**

Temperature rating:

Operating temperature: -25°C to +80°C

Lead free, RoHS compliant.

Recommended soldering temp: 235°C for 5 sec.

**Packaging:**

Anti-ESD plastic bags

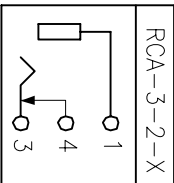

| COLOR  | P/N:      |
|--------|-----------|
| RED    | RCA-3-2-R |
| WHITE  | RCA-3-2-W |
| BLACK  | RCA-3-2-B |
| YELLOW | RCA-3-2-Y |



**ADAM TECH**

909 Rahway Avenue, Union, NJ 07083  
 Phone: 908-687-5000 Fax: 908-687-5710

RCA JACK, RIGHT ANGLE,  
 PCB MOUNT

| UNLESS OTHERWISE SPECIFIED<br>ALL DIMENSIONS ARE INCHES [MM]<br>TOLERANCES UNLESS NOTED |           | DRAWN     |        | DATE |        | TITLE                               |      |
|---|-----------|-----------|--------|------|--------|-------------------------------------|------|
| X   | ± .10     | Ø X       | ± .10  | SS   | 8/6/04 | RCA JACK, RIGHT ANGLE,<br>PCB MOUNT |      |
| .XX   | ± .020    | Ø XX      | ± .015 |      |        |                                     |      |
| .XXX  | ± .015    | Ø XXX     | ± .010 |      |        |                                     |      |
|   |           | Ø XXX     | ± .010 |      |        |                                     |      |
| APPROVED  |           | APPROVALS |        |      |        |                                     |      |
| CHECKED   |           |           |        |      |        |                                     |      |
| SIZE  | PART NO.  | REF:      | SCALE: | NTS  | SHEET  | 1 OF 1                              | REV. |
| X   | RCA-3-2-X |           |        |      |        |                                     | -    |



**ADAM TECH**

909 Rahway Avenue, Union, NJ 07083  
 Phone: 908-687-5000 Fax: 908-687-5710

RCA JACK, RIGHT ANGLE,  
 PCB MOUNT

| UNLESS OTHERWISE SPECIFIED<br>ALL DIMENSIONS ARE INCHES [MM]<br>TOLERANCES UNLESS NOTED |           | DRAWN     |        | DATE |        | TITLE                               |      |
|---|-----------|-----------|--------|------|--------|-------------------------------------|------|
| X   | ± .10     | Ø X       | ± .10  | SS   | 8/6/04 | RCA JACK, RIGHT ANGLE,<br>PCB MOUNT |      |
| .XX   | ± .020    | Ø XX      | ± .015 |      |        |                                     |      |
| .XXX  | ± .015    | Ø XXX     | ± .010 |      |        |                                     |      |
|   |           | Ø XXX     | ± .010 |      |        |                                     |      |
| APPROVED  |           | APPROVALS |        |      |        |                                     |      |
| CHECKED   |           |           |        |      |        |                                     |      |
| SIZE  | PART NO.  | REF:      | SCALE: | NTS  | SHEET  | 1 OF 1                              | REV. |
| X   | RCA-3-2-X |           |        |      |        |                                     | -    |