

Rev	AWO #	Description	Date	Appr
-		RELEASED	9/7/04	

APPROVED: \_\_\_\_\_  
 DATE: \_\_\_\_\_ TITLE: \_\_\_\_\_

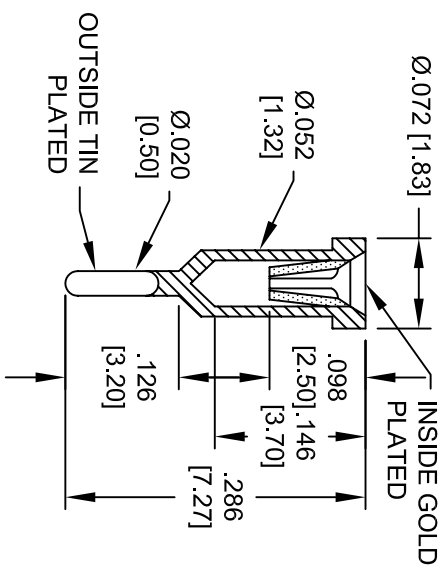
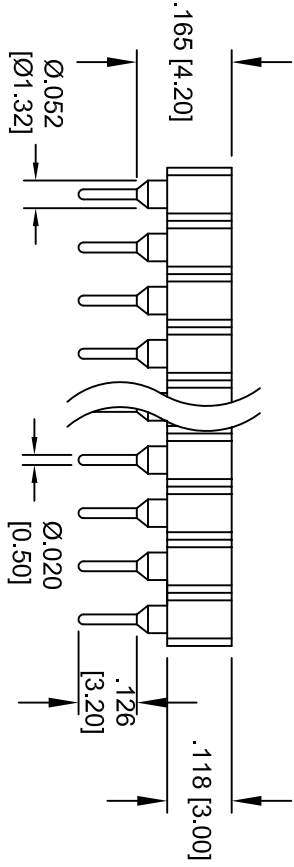
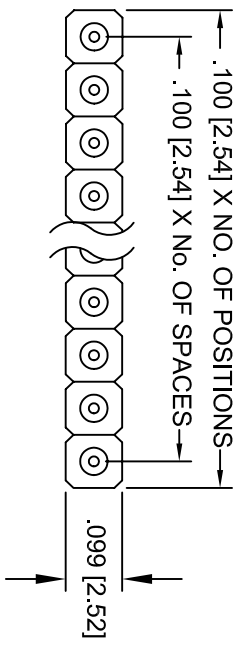

**SPECIFICATIONS:**

- Material: Insulator: PBT, glass reinforced, rated UL 94V-0
- Insulator color: Black
- Contacts: Phosphor Bronze
- Plating: Inner contact: Gold Flash over Nickel underplate
- Outer contact: Tin over Copper underplate
- Electrical: Operating voltage: 250 VAC max
- Current rating: 1 Amp max
- Insulation resistance: 1000 Mohms min
- Dielectric withstanding voltage: 5000 VAC for 1 minute
- Temperature Rating: Operating temperature: -55°C to +105°C

UNLESS OTHERWISE SPECIFIED  
 ALL DIMENSIONS ARE INCHES [MM]  
 TOLERANCES: EXCEPT AS NOTED

INCHES	HOLES
.X ± .10	Ø.X ± .10
.XX ± .020	Ø.XX ± .015
.XXX ± .015	Ø.XXX ± .010

APPROVALS: \_\_\_\_\_ DATE: \_\_\_\_\_

DRAWN: SS 9/7/04

CHECKED: \_\_\_\_\_

APPROVED: \_\_\_\_\_

**ADAM TECH**  
 909 Rahway Avenue, Union, NJ 07083  
 Phone: 908-687-5000 Fax: 908-687-5710

TITLE: SINGLE ROW MACHINE CONTACT STRIP  
 INNER GOLD / OUTER TIN

SIZE	PART NO.	SCALE	SHEET	REV.
X	SICM-XX-1-GT	NTS	1 OF 1	-