

DWG. NO.		261-910-0630G	
REV	DESCRIPTION	BY DATE	APPRO
F	ADD NOTE 4 PER ERO42634	BS 08/09/2012	DW

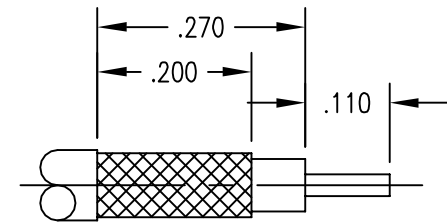
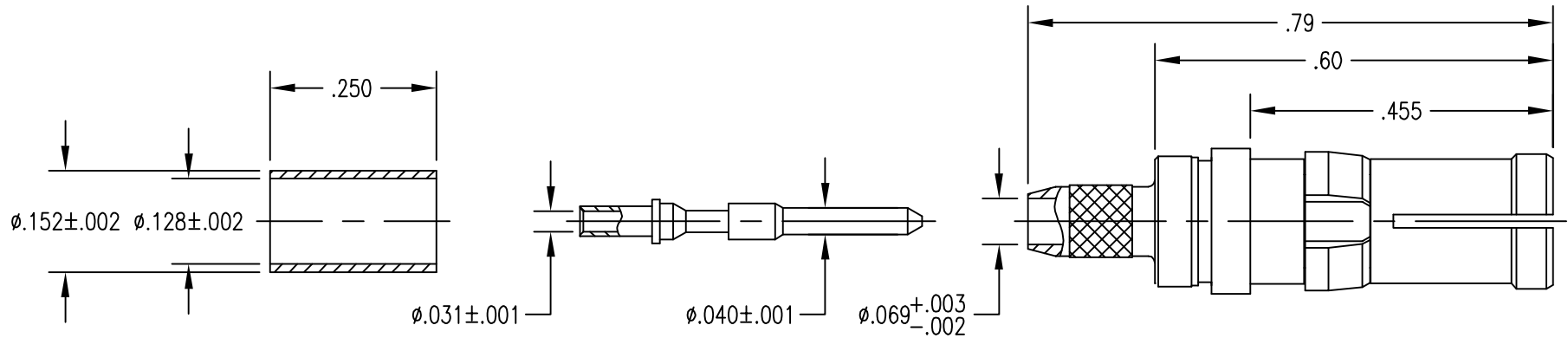

TRIMMING DIMENSIONS

NOTES:

1. MATERIALS:

- FRONT BODY: BERYLLIUM COPPER PER ASTM B196
- REAR BODY AND CONTACT: BRASS PER ASTM B16
- INSULATOR: TEFLON PER ASTM D1710
- FERRULE: BRASS PER ASTM B16
- CLIP RING: BERYLLIUM COPPER PER ASTM B194

2. FINISH:

- BODIES AND CONTACT: .000030 MIN. GOLD PER MIL-G-45204 OVER  
.000050 MIN. NICKEL PER QQ-N-290
- CLIP RING: .000100 MIN. NICKEL PER QQ-N-290 OVER COPPER  
FLASH
- FERRULE: .000005 MIN. GOLD PER MIL-G-45204 OVER .000050 MIN.  
NICKEL PER QQ-N-290

3. FOR ASSEMBLY USE CAP 9-07 WITH ABOVE TRIM DIMENSIONS

4. DESIGNED FOR USE WITH RG 316/U, 174, 188 OR EQUIVALENT CABLES

PER ASME Y14.5M-1994 UNLESS OTHERWISE SPECIFIED: DIMENSIONS ARE IN INCHES OR INCHES/MM TOLERANCES: DECIMALS .XX ± .01/0.254 .XXX ± .005/0.127 ANGLES ± 2° SCALE: 4:1		 Winchester electronics 62 Barnes Industrial Road North Wallingford, CT 06492	
<b>CUSTOMER DRAWING</b>		<b>TITLE</b> 50 OHM RDM CRIMP/CRIMP RECEPTCLE WITH CAPTIVE CENTER CONTACT	
DRAWN KJT	DATE 7/9/97	CHECKED JMC	DATE 7/9/97
APPROVED AT	DATE 7/9/97	APPROVED AT	DATE 7/9/97
<b>A</b>		261-910-0630G	SH. OF REV. 1 1 F