

SW121500(12V150AH)

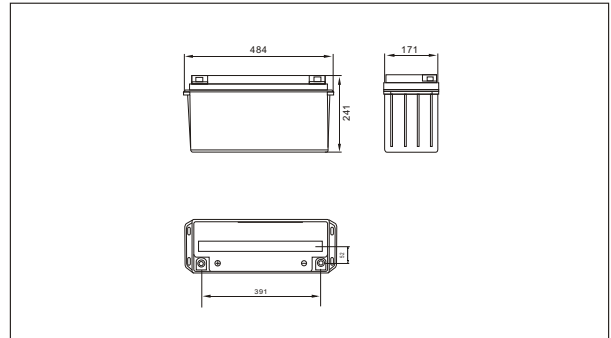

Outer dimensions (mm)



Specifications

Nominal Voltage		12V
Rated capacity (10hour rate)		150 Ah
Dimensions	Total Height	241 mm (9.49inches)
	Height	241 mm (9.49inches)
	Length	484 mm (19.1 inches)
	Width	171 mm (6.73 inches)
Weight Approx		46 Kg (101.66lbs)

Terminal Type (mm)

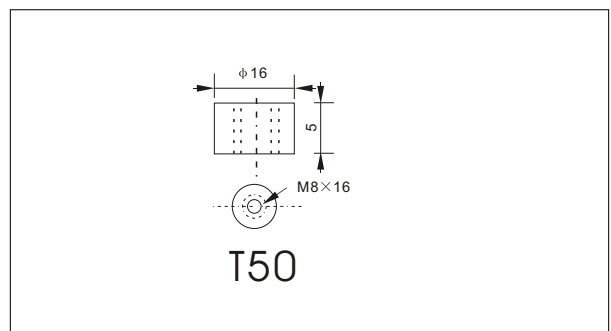

Characteristics

Capacity 25°C(77°F)	10 hour rate(15A) 5 hour rate(24A) 1 hour rate(90A)	150 AH 120AH 90 AH
Internal Resistance	Full charged Battery at 25°C(77°F)	3.5 mΩ
Capacity affected by Temperature (10hour rate)	40°C(104°F) 25°C(77°F) 0°C(32°F) -15°C(5°F)	102% 100% 85% 65%
Self-Discharge at 25°C(77°F)	Capacity after 3 month storage Capacity after 6 month storage Capacity after 12 month storage	91% 82% 64%
Terminal	T50	
Charge (constant Voltage)	Cycle	Initial Charging Current less than 60 A Voltage 14.10-14.40V
	Float	Voltage 13.50-13.80V

Discharge Curves 25°C(77°F)

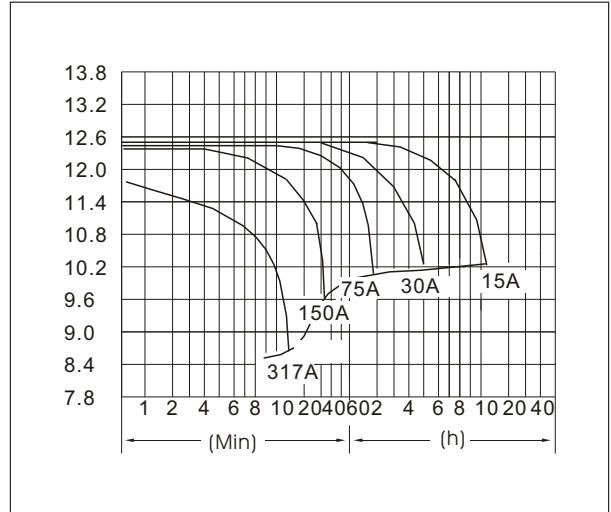

Constant Current(Amp) and Constant Power(Watt) Discharge Table at 25°C(77°F)

Time		5min	10min	15min	30min	1h	2h	3h	4h	5h	8h	10h	20h
960V	A	480	317	255	171	90	53	38.6	30.0	24.8	17.6	15.8	8.5
	W	4958	3380	2736	1839	972	576	429.1	337.5	281.4	201.1	181.9	98.9
1020V	A	465	286	240	164	85	50	37.5	29.3	24.3	17.1	15.5	8.3
	W	4969	3189	2689	1835	957	577	434.3	340.1	283.3	200.1	181.5	96.8
1050V	A	450	255	210	153	82	49	36.6	28.8	24.0	17.0	15.2	8.3
	W	4916	2906	2398	1761	948	567	426.5	337.0	281.4	199.3	179.3	97.5
1080V	A	434	241	195	141	79	48	35.7	28.4	23.4	16.5	15.0	8.1
	W	4867	2776	2250	1634	922	559	420.9	334.8	276.6	195.5	178.3	96.5
1110V	A	419	226	180	126	77	47	34.5	27.6	22.8	16.1	14.3	7.7
	W	4754	2612	2099	1474	900	550	409.9	328.7	272.1	192.2	172.0	92.7