

Metal Core SMD Power Inductors (MCOIL(TM) MD series)

MDKK2020T1R0MM

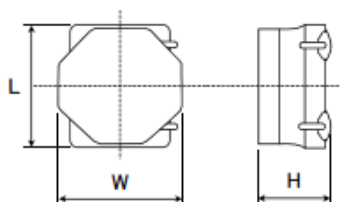

■ Features

- Item Summary
1 μ H($\pm 20\%$), 2900mA, 1700mA
- Lifecycle Stage
Mass Production
- Standard packaging quantity (minimum)
Taping 2500pcs

■ Products characteristics table

CaseSize (EIA/JIS)	~/2020
Inductance	1 μ H($\pm 20\%$)
Inductance Measuring Frequency	1MHz
Rated Current -Saturation Current	2900mA
Rated Current -Temperature Rise Current	1700mA
DC Resistance (max)	0.085 Ω
Avg. of DC.Resistance	0.074 Ω
RoHS Compliance	Yes
Halogen Free	Yes
Soldering Method	Reflow

■ External Dimensions

L	2mm ± 0.15
W	2mm ± 0.15
H	1mm max

■ Recommended Land Patterns

【推奨ランドパターン】
実装上の注意
・実装状態を確認の上で使用するようお願いします。
・本製品のはんだ付けはリフローはんだ工法に限ります。

【Recommended Land Pattern】
Surface Mounting
*Mounting and soldering conditions should be checked beforehand.
*Applicable soldering process to these products is reflow soldering only.

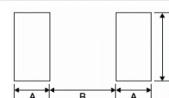
Metal Core SMD Power Inductors (MCOIL_{TM} MD series)

Type	A	B	C
1616	0.50	0.60	1.65
2020	0.65	0.70	2.00
3030	0.80	1.40	2.70
4040	1.20	1.60	3.70
5050	1.50	2.10	4.00

unit:mm