

Rev	AWO #	Description	Date	Appr
-		RELEASED	5/12/05	

APPROVED: _____
 DATE: _____ TITLE: _____

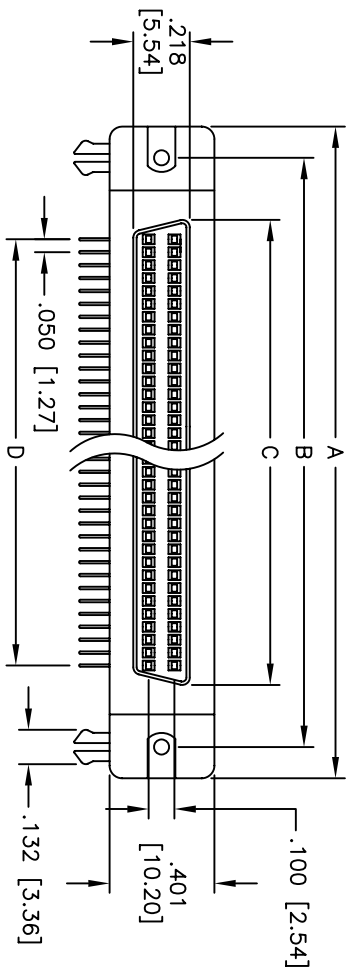

	S2A-SR-20	S2A-SR-26	S2A-SR-28	S2A-SR-40	S2A-SR-50	S2A-SR-68
A	1.323 [33.60]	1.469 [37.30]	1.523 [38.68]	1.823 [46.30]	2.073 [52.65]	2.523 [64.08]
B	1.081 [27.45]	1.228 [31.20]	1.281 [32.53]	1.581 [40.15]	1.831 [46.50]	2.281 [57.93]
C	0.600 [15.25]	0.750 [19.05]	0.800 [20.33]	1.100 [27.95]	1.350 [34.30]	1.800 [45.73]
D	0.450 [11.43]	0.600 [15.24]	0.650 [16.51]	0.950 [24.13]	1.200 [30.48]	1.650 [41.91]

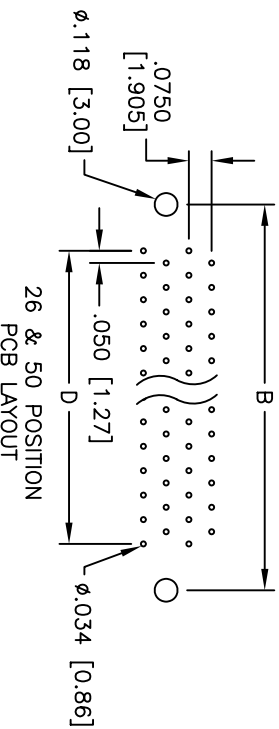

26 & 50 POSITION
 PCB LAYOUT
 20, 28, 40, 68, 80, 100, & 120 POSITION
 PCB LAYOUT

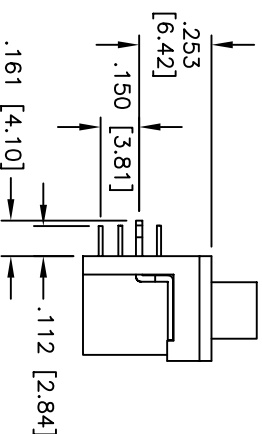
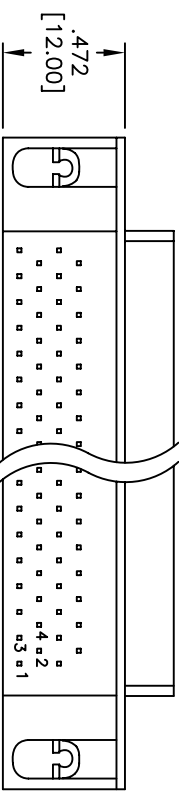

	S2A-SR-80	S2A-SR-100	S2A-SR-120
A	2.823 [71.70]	3.323 [84.40]	3.823 [97.10]
B	2.581 [65.55]	3.081 [78.25]	3.581 [90.95]
C	2.100 [53.35]	2.600 [66.05]	3.100 [78.75]
D	1.950 [49.53]	2.450 [62.23]	2.950 [74.93]

UNLESS OTHERWISE SPECIFIED
 ALL DIMENSIONS ARE INCHES [MM]
 TOLERANCES: EXCEPT AS NOTED
 INCHES: .X ±.10 ØXX ±.015
 .XX ±.020 ØXXX ±.010
 .XXX ±.015
 APPROVALS: _____ DATE: _____
 DRAWN: SS 5/12/05
 CHECKED: _____
 APPROVED: _____

ADAM TECH

909 Rahway Avenue, Union, NJ 07083
 Phone: 908-687-5000 Fax: 908-687-5710

SCSI IIII SOCKET, R/A, W/O LATCH BLOCKS
 BOARDLOCKS, #4-40 MOUNTING HOLES

SIZE X PART NO. S2A-SR-XX-2-BL-1

REV. _____ SCALE: NTS SHEET 1 OF 1

SPECIFICATIONS:

Material:
 Insulator: PBT, glass reinforced, rated UL 94V-0
 Insulator color: Black
 Contacts: Phosphor Bronze
 Metal Backshell: Zinc, Nickel plated
 Plating:
 Tin over Copper underplate on mating area,
 Tin over Copper underplate on tails
Electrical:
 Operating voltage: 250 VAC max
 Current rating: 1 Amp max
 Contact resistance: 35 mohms max
 Insulation resistance: 500 Mohms min
 Dielectric withstanding voltage: 500 VAC for 1 minute
 Temperature Rating:
 Operating temperature: -55°C to +105°C
Environmental:
 Lead free, RoHS compliant
 Recommended soldering temp: 235°C for 5 seconds

