

Rev	AWO #	Description	Date	Appr
-		RELEASED	5/19/11	

APPROVED: _____
 DATE: _____ TITLE: _____

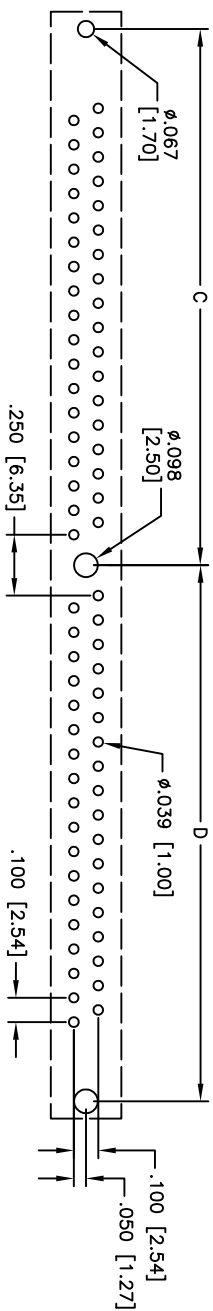
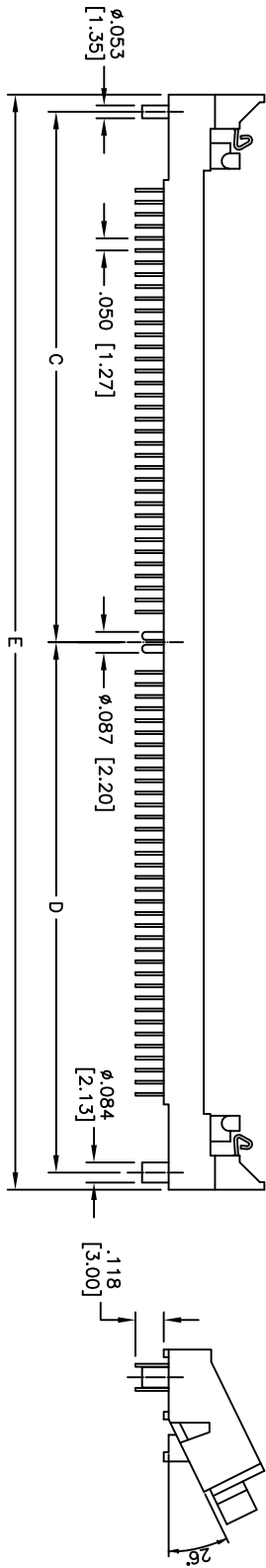
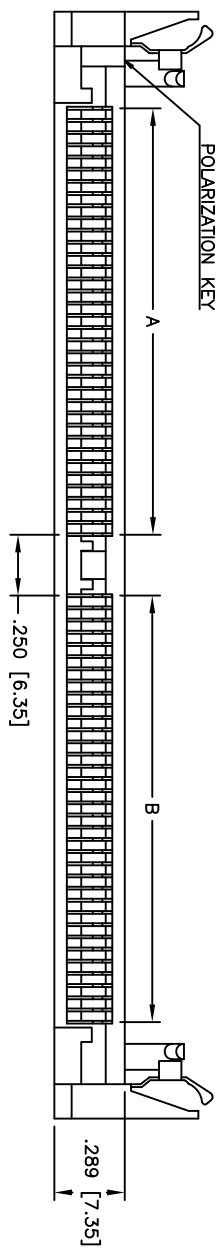

RECOMMENDED PCB LAYOUT
(TOP VIEW)

PINS	A	B	C	D	E
64	1.549 [39.35]	1.549 [39.35]	2.005 [50.92]	2.005 [50.92]	4.157 [105.59]
68	1.649 [41.89]	1.649 [41.89]	2.105 [53.46]	2.105 [53.46]	4.357 [110.67]
72	1.750 [44.45]	1.750 [44.45]	2.205 [56.00]	2.205 [56.00]	4.557 [115.75]
80	1.950 [49.53]	1.950 [49.53]	2.412 [61.26]	2.412 [61.26]	4.959 [125.96]

ADAM TECH

909 Rahway Avenue, Union, NJ 07083
 Phone: 908-687-5000 Fax: 908-687-5710

TITLE: SIMM SOCKET, PITCH 1.27MM, PLASTIC POST
 26 DEGREE ANGLE

SPECIFICATIONS:

Material:
 Insulator: LCP, rated UL 94V-0
 Insulator color: Ivory
 Contacts: Copper Alloy

Plating:
 Tin plated over Nickel underplate overall.

Electrical:
 Current rating: 1A

Contact resistance: 30 mohms max
 Insulation resistance: 1,000 Mohms min
 Dielectric withstanding voltage: 500 VAC for 1 minute

Environmental:
 Operating temperature: -55°C to +100°C
 Lead free, RoHS compliant
 Recommended soldering temp: 260°C. for 5 seconds

UNLESS OTHERWISE SPECIFIED
 ALL DIMENSIONS ARE MM [INCHES]
 TOLERANCES: EXCEPT AS NOTED
 INCHES

.X	± .10	ØX	± .10
.XX	± .020	ØXX	± .015
.XXX	± .015	ØXXX	± .010

APPROVALS: _____ DATE: _____

DRAWN	DY	5/19/11
CHECKED		
APPROVED		

SIZE	PART NO.	REV.
X	SIMM-1XX+TL-C2	-
REF: S0072T	SCALE: NTS	SHEET 1 OF 1

