

Verpackt im Gurt in Anlehnung an DIN IEC 60286-3
 Tape on Reel Packaging according to DIN IEC 60286-3
 Verpackungseinheit: 400 Stück
 Packaging unit: 400 pcs

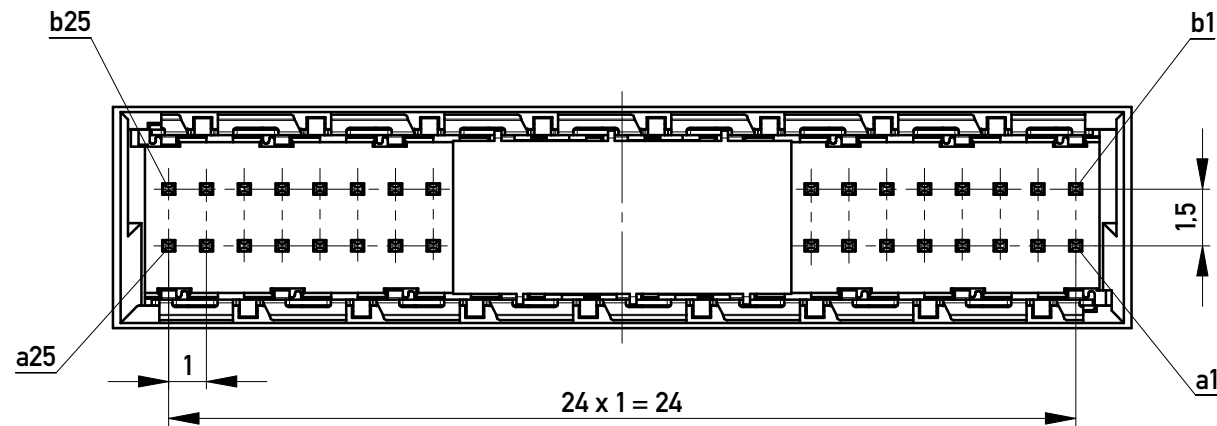

Abspulrichtung - Reel off Direction

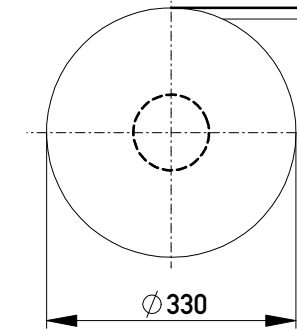
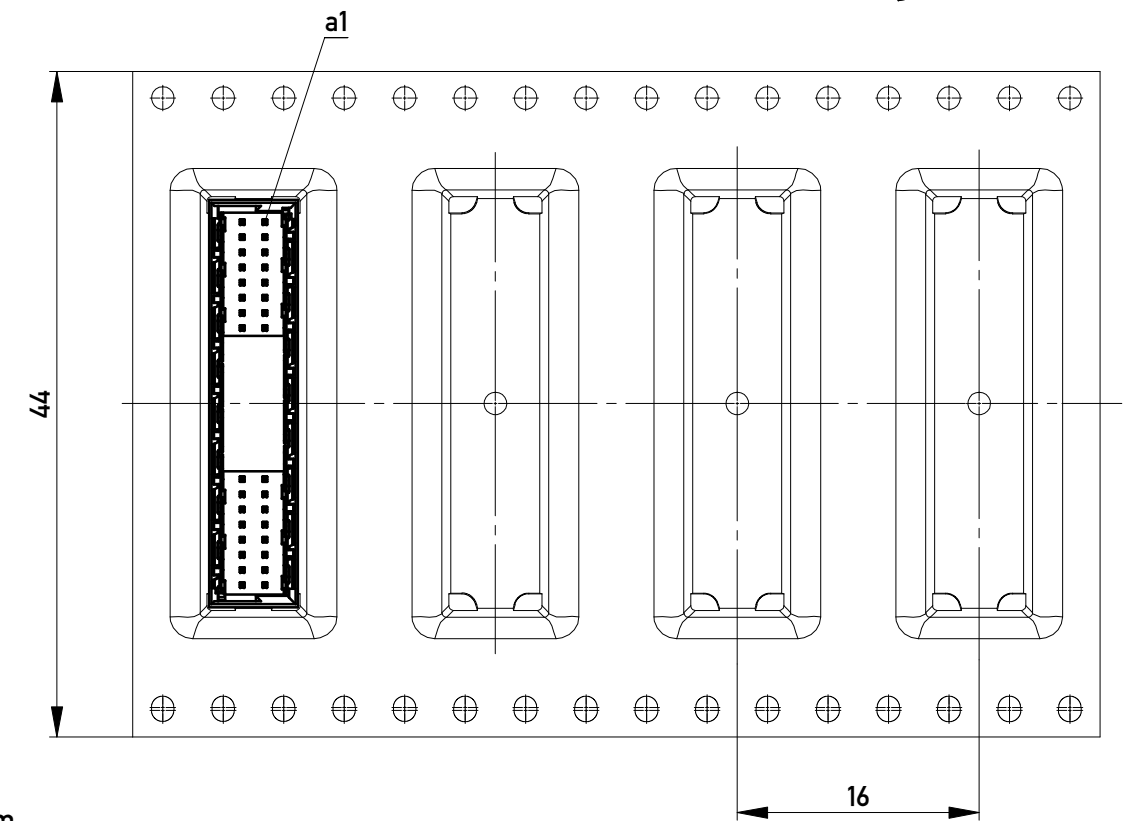

Leiterplatten-Layout Vorschlag / PCB-Layout proposal

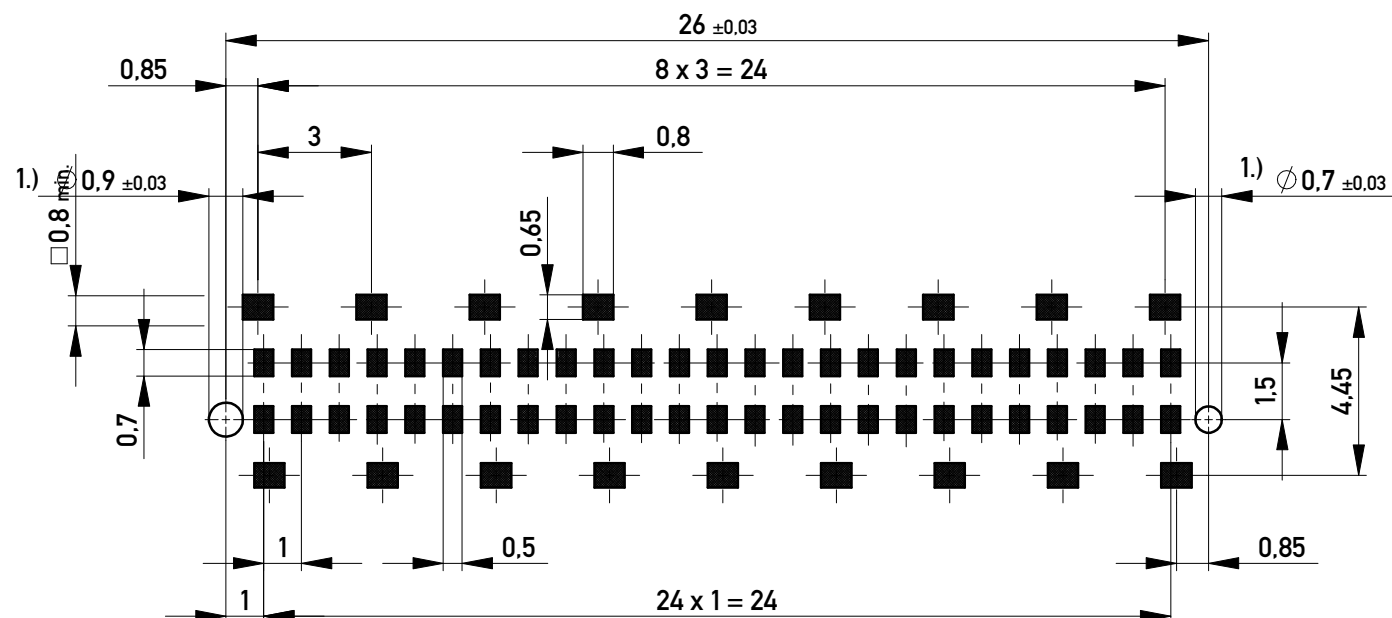

1.) Durchmesser des Bohrers / drill tool

Anforderungsstufe 1
 Performance Level 1

Kontaktbereich vergoldet
 Mating Area gold plating

Anschlussbereich verzinkt 4-6 µm
 Terminal Area 4-6 µm tin plating

Koplanarität der Anschlüsse ≤ 0,1 mm
 Coplanarity Area of Termination ≤ 0,1 mm

Information:		Tolerances	Scale 5:1	
All rights reserved. Only for Information. To ensure that this is the latest version of this drawing, please contact one of the ERNI companies before using.		All Dimensions in mm	Designation	
Subject to modification without prior notice. Drawing will not be updated.		www.ERNI.com	Messerleiste 2mm SMD, 50 polig Male 2mm SMD, 50 contacts	
j	18.02.2016		100600560001	K
Index	Date		Class	MSPEED

Copyright by ERNI GmbH
 Proprietary notice pursuant to ISO 16016 to be observed.