

0040 AC Inlet with 5 x 20mm Fuseholder



Note: Not recommended for new designs. Refer to KEA (pg. 36), GSF (pg. 13/14) or 6220 (pg. 35)



Standards: UL 498; CSA C22.2/182.3; DIN/VDE 0625; SEMKO 9320; IEC 320/C14/C18; EN 60320

- Power entry module with 1-pole or 2-pole fuseholder
- For "cold" connections 70° C, Protection Class I or II
- Screw mount from front
- Single or double pole shocksafe fuseholder according to IEC 65/VDE 0860 for 5 x 20mm fuses
- Quick-connect terminals .187 x .032" (4.8 x 0.8mm)
- 0.5 Nm torque required for M3 screws
- Max. power dissipation 2.4 watts (2-pole fusing) according to IEC 127-6. For additional values P_v in function of T_{amb} , see page 5
- For materials, options and accessories please see page 30
- For inlet with piggy-back fuse clips see GSF, page 13-14

| | | |
|-------------------|----------|---------------------------|
| UL recognition | 10A/250V | File #E93617 |
| CSA certification | 10A/250V | File #LR38456 |
| VDE approval | 6A/250V | File #19397 |
| SEMKO approval | 10A/250V | } File numbers on request |
| SEV approval | 10A/250V | |

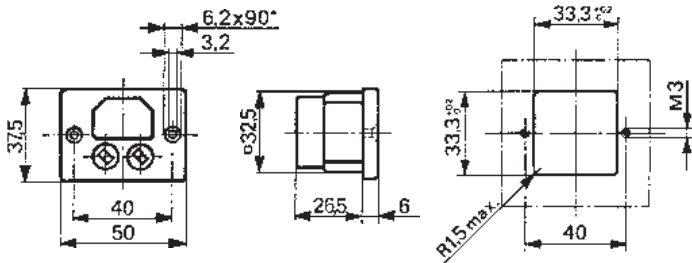

page 102.

| Series 0040 | | | |
|-----------------------|---------------------|--------------|-----------------------------|
| Class I | Class II | Color/Fusing | Terminal Type |
| 0040.5000.2 | 0040.5015 | black/2-pole | solder |
| 8843-2.SP.FL.4/3.60 | 8842-2.SP.FL.4/3.60 | | .138" x .032" (3.5 x 0.8mm) |
| 0040.5001.2 | | grey/2-pole | quick-connect |
| 8843-2.SP.FL.4/3.64 | | | .187" x .032" (4.8 x 0.8mm) |
| 0040.5012 | | black/1-pole | quick-connect |
| 8843-2.SP.U.FL.4/3.60 | | | .250" x .032" (6.3 x 0.8mm) |

8843 AC Inlet • Interchangeable Fuseholders for 1/4 x 1 1/4" or 5 x 20mm Fuses



Standards: UL 498; CSA C22.2/182.3; DIN/VDE 0625; SEMKO 9320; IEC 320/C14; EN 60320. U.S. Patented.

- Power entry module with 1-pole or 2-pole fuseholder
- For "cold" connections 70° C, Protection Class I.
- Screw mount from front or rear, or snap-in mount from front (0.8-3.0mm panel thickness)
- Single or double pole shocksafe fuseholder according to IEC 65/VDE 0860 for 1/4 x 1 1/4" or 5 x 20mm fuses
- Quick-connect terminals .187 x .032" (4.8 x 0.8mm) or solder .138 x .032" (3.0 x 0.8mm).
- 0.5 Nm torque required for M3 screws for screw-on type
- Max. power dissipation 5.5 watts (2 pole fusing, unfiltered) according to IEC 127-6. For additional values P_v in function of T_{amb} , see page 6
- For materials, options and accessories please see page 30
- For 8843 with line filter, please see 8843 on page 59
- For inlet with piggy-back fuse clips see GSF, page 13-14

| | | |
|-------------------|----------|---------------------------|
| UL recognition | 10A/250V | File #E96317 |
| CSA certification | 10A/250V | File #LR38456 |
| VDE approval | 10A/250V | File #3157, expert report |
| SEMKO approval | 10A/250V | } File numbers on request |
| SEV approval | 10A/250V | |

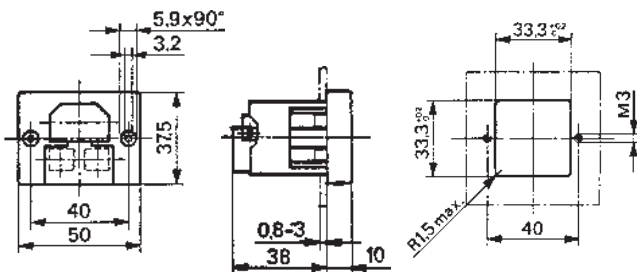

Order Numbers (type) Note: Casing and fuseholders must be ordered separately. To order fuses, please see page 102.

| Casing | | | |
|--------|-------------------------|-------------------------|---|
| 8843 | 1-pole fusing | 2-pole fusing | Terminals |
| | 8843.0351 (8843-351.60) | 8843.0361 (8843-361.60) | Solder .138" X .032" (3.0 x 0.8mm) |
| | 8843.0353 (8843-353.60) | 8843.0363 (8843-363.60) | Quick-connect .187" x .032" (4.8 x 0.8mm) |
| | 8843.0451 (8843-451.60) | 8843.0461 (8843-461.60) | Solder .138" X .032" (3.0 x 0.8mm) |
| | 8843.0453 (8843-453.60) | 8843.0463 (8843-463.60) | Quick-connect .187" x .032" (4.8 x 0.8mm) |
| | | | Mounting |
| | | | Screw-on |
| | | | Screw-on |
| | | | Snap-in, 0.8-3.0mm panel thickness |
| | | | Snap-in, 0.8-3.0mm panel thickness |
| | | | Fuseholder inserts* (2 inserts must be ordered for 2-pole fusing) |
| | | | 8843.0901 1/4 x 1 1/4" |
| | | | 8843-901.60 (6.3x32mm) |
| | | | 8843.0902 for 5 x 20mm |
| | | | 8843-902.60 |