



- Isolated Output
- Universal AC input
- Protections: Short circuit / Overload / Over voltage
- Cooling by free air convection
- LED indicator for power on
- All using 105°C long life electrolytic capacitors



Model Number	Output Volts	Output Amps	Ripple & Noise	Min Load	Line Reg	Volt Tolerance
DUAL OUTPUT						
RID-50A	5 Volts(DC)	6 Amps	80mV pk-pk	0.3 ~ 6Amps	±0.5%	±2.0%
	12 Volts(DC)	2 Amps	120mV pk-pk	0.2 ~ 3Amps	±1.5%	±8.0%
RID-50B	5 Volts(DC)	4 Amps	80mV pk-pk	0.3 ~ 6Amps	±0.5%	±2.0%
	24 Volts(DC)	1.4 Amps	150mV pk-pk	0.2 ~ 2Amps	±1.5%	+8,-4%



50W Dual Output Switching Power Supply

RID-50 series

INPUT SPECIFICATIONS

Input Voltage Range	90 ~ 264 VAC; 125~373 Volts(DC)
Frequency Range	47-63 Hz
Inrush Current, typ: (cold start)	33 Amps / 230VAC
Input Current	1.3 Amps. @ 115VAC
	0.8 Amps. @ 230VAC
Leakage current	< 2mAmps /240VAC

OUTPUT SPECIFICATIONS

Voltage and Current	See Selection Chart
Line Regulation (Note 3)	See Selection Chart
Load Regulation (Note 4)	0.5%
Voltage Tolerance (Note 2)	See Selection Chart
Ripple/Noise (Note 1)	See Selection Chart
Hold Up Time @ FL	60mS/230VAC
	14mS/115VAC
Setup, Rise Time @ FL	500ms, 20m/230VAC
	1200mS, 30mS/115VAC
Over Voltage Protection	5Volts only: 5.75 ~ 6.75VDC
	Hiccup mode, auto recover
Over Current Protection	110 ~ 150% rated output power
	Hiccup mode, auto recover
DC Voltage Adjust	5Volts only: 4.75 ~ 5.5Volts(DC)

GENERAL SPECIFICATIONS

Safety	UL60950-1
	TUV EN60950-1 Approved
Insulation Resistance	≥ 100MΩ @ 500VDC/25 °C/70%RH
EMI	Compliance to EN55022B(CISPR22B)
Harmonic Current	Compliance to EN61000-3-2,-3
Efficiency	80%
Isolation	3000VAC Input - Output
	1500VAC Input - Ground
	500VAC Output - Ground
EMS	Compliance to
	EN61000-4-2,3,4,5,6,8,11;
	ENV50204, EN55024, EN60601-1-2,
	(EN50082-2),
	heavy industry level, criteria A

All specifications are typical at nominal input, full load, and 25°C unless otherwise noted

ENVIRONMENTAL SPECIFICATIONS

Oper. Temperature	-25°C to +70°C (See Derate Curve)
Storage Temperature	-40°C to +85°C, 10~95% RH
Relative Humidity	20 to +90% RH non cond
Temperature Coefficient	0.03% / °C (0-50°C) on +5V output
MTBF	172.6 KHrs min,MIL-HDBK-217F (25°C)
Vibration	10~500Hz, 5G10min./1cycle, period for
	60min. each along X, Y, Z axes

PHYSICAL SPECIFICATIONS

Size		
	Millimeters	99 x 97 x 36
	Inches	3.90" x 3.82" x 1.42"
Weight		14.46 oz (410g)

NOTE

1. Ripple & noise are measured at 20MHz of bandwidth by using a 12" twisted pair-wire terminated with a 0.1uf & 47uf parallel capacitor.
2. Tolerance : includes set up tolerance, line regulation and load regulation.
3. Line regulation is measured from low line to high line at rated load.
4. Load regulation is measured from 20% to 100% rated load, and other output at 60% rated load.

Astrodyne products are not authorized or warranted for use as critical components in life support systems, equipment used in hazardous environments, nuclear controls systems, or other mission-critical applications.

Mechanical Specification

Case No. 905B Unit:mm

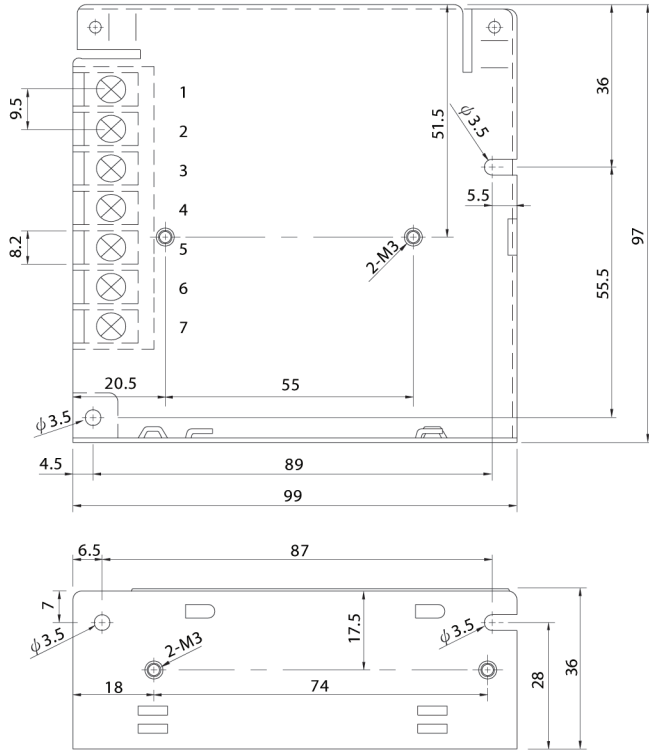

Terminal Pin No. Assignment

Pin No.	Assignment	Pin No.	Assignment
1	AC/L	5	DC OUTPUT +V2
2	AC/N	6	DC OUTPUT G1
3	FG \perp	7	DC OUTPUT +V1
4	DC OUTPUT G2		

Block Diagram

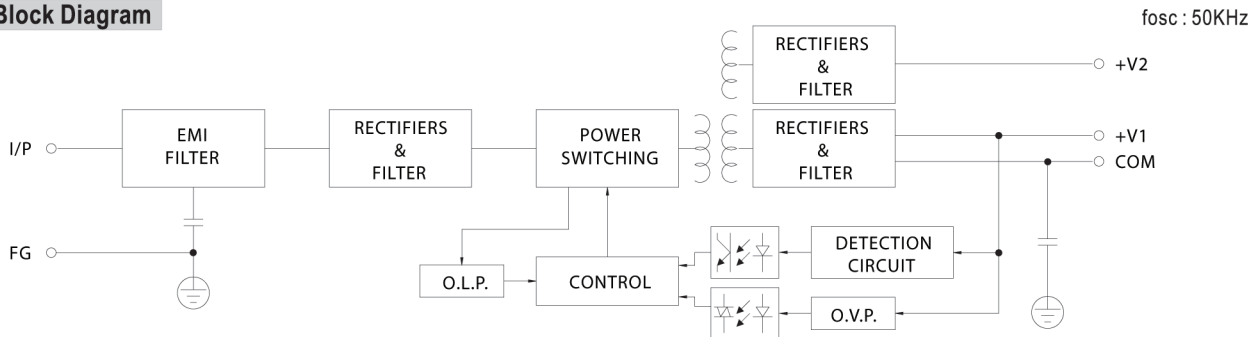

Derating Curve

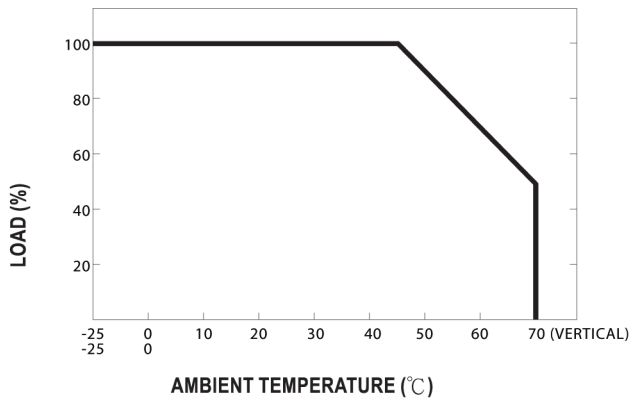

Output Derating VS Input Voltage

