

1. Mechanical Dimensions:

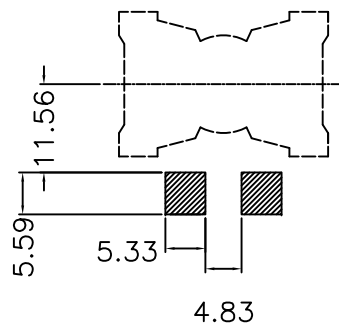

Recommended Land Pattern

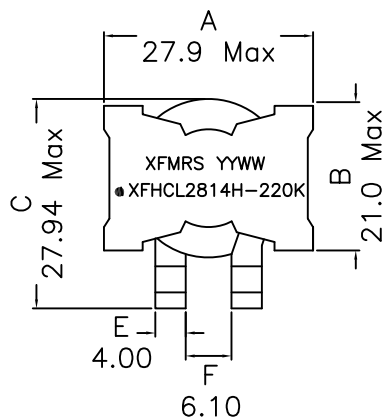
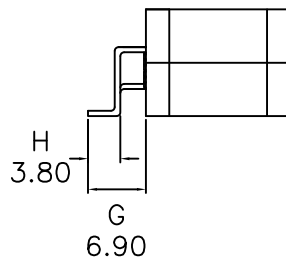
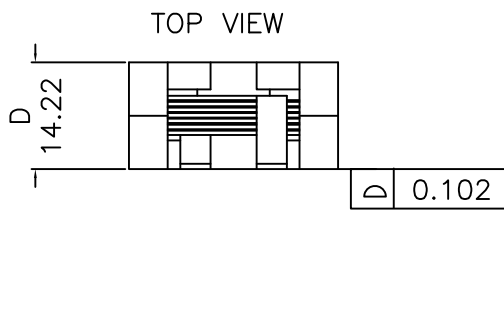

2. Schematic:

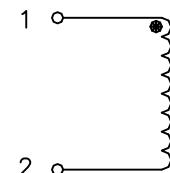

3. Electrical Specifications: @25°C

OCL: 22.0uH±10% @500KHz 0.1V

Q: 20 Min @500KHz 0.1V

Isat: 12.0A_{dc} (OCL 10% drop in OCL)

Isat: 14.0A_{dc} (OCL 20% drop in OCL)

Isat: 15.0A_{dc} (OCL 30% drop in OCL)

Irms: 28.0A_{dc} (OCL 40°C Temp Rise)

DCR: 4.5 mOhms Max

SRF: 8MHz Typ

Notes:

1. Solderability: Leads shall meet MIL-STD-202G, Method 208H for solderability.
2. Flammability: UL94V-0
3. ASTM oxygen index: > 28%
4. Insulation System: Class F 155°C. UL file E151556
5. Operating Temperature Range: All listed parameters are to be within tolerance from -40°C to +85°C
6. Storage Temperature Range: -40°C to +125°C
7. Aqueous wash compatible
8. SMD Lead Coplanarity: ±0.004"(0.102mm)
9. Electrical and mechanical specifications 100% tested
10. RoHS Compliant Component

DOC. REV: A/2

PROPRIETARY

Document is the property of XFMRs Group & is not allowed to be duplicated without authorization.

XFMRs Inc www.XFMRs.com		Title: SMT Power Inductors	
UNLESS OTHERWISE SPECIFIED TOLERANCES: .xx ±0.25 Dimensions in MM	P/N: XFHCL2814H-220K		REV. A
	DWN.	Yuan	Jul-25-14
	CHK.	YK Liao	Jul-25-14
SHT 1 OF 1	APP.	DDC	Jul-25-14