

AH20AP

2.1Mega pixel Camera

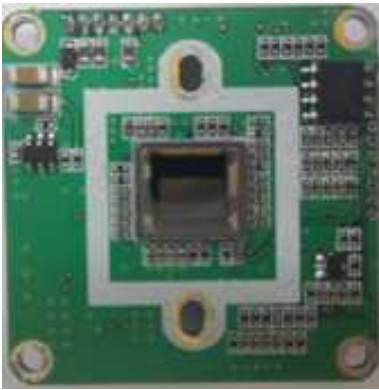

Features

- 1/3" PANASONIC CMOS Sensor
- HD Resolution : 1080P AHD
- D-WDR (Digital WDR)
- DNR (Digital Noise Reduction: 2D + 3D)
- Privacy Mask Function
- Motion Detection
- Defog:
- Dimension : 32mm x 32mm

Dimensions

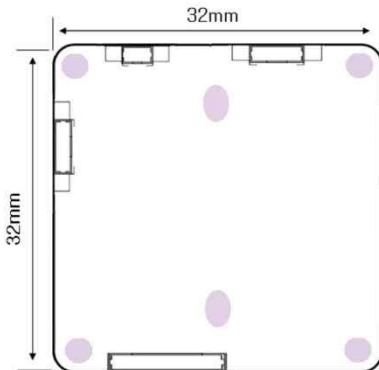

Specifications

AH20AP	
Image Device	1/3" 2.1 Mega Pixel PANASONIC CMOS
Scanning system	Progressive
Resolution	ANALOG HD : 1080P 30FPS , 720P ANALOG CVBS :1280H NTSC / PAL
Total Pixels	1956(H) X 1266(V) = 2,476,296(pixel)
Effective Pixels	1944(H) X 1092(V) = 2,122,848(pixel)
Shutter Speed	Auto / Manual (1/25(1/30) ~ 1/50,000)
Min. illumination	Color : 1.0 Lux / BW : 0.5 Lux
	Color DSS: 0.002 Lux / BW DSS : 0.001 Lux
S/N Ratio	More Than 50dB (AGC off)
Lens	DC / Manual
AGC	Off / 0 ~ 15
SENS UP	Off / x2 ~ x30
DAY & NIGHT	Auto / COLOR / B&W / EXTERN
WHITE BALANCE	ATW / AWC / INDOOR / OUTDOOR / Manual /AWB
Backlight	Off/ BLC / HSBLC
MIRROR	Off / H / V / H&V / ROTATE
D-WDR	Off / ON / AUTO
DNR	Off / LOW / Middle / High
PRIVACY	4 Masks
MOTION	Off / On
DEFOG	Off / Auto
Operating Temp./Hum	-10℃ ~ +50℃ / Max 90%RH
Storage Temp./Hum	-20℃ ~ + 60℃ / Max 90%RH
Language	English/ Chinese/ Germany/ French/ Italian/ Spanish/ Polish/ Russain/ Portuguese/ Netherlands/ Turkish / JAPAN / KOR / HEB / ARB
Power Input	DC 12V
Video Output	AHD, TVI, CVI, CVBS
Size	32 x 32mm

Connector Pin map

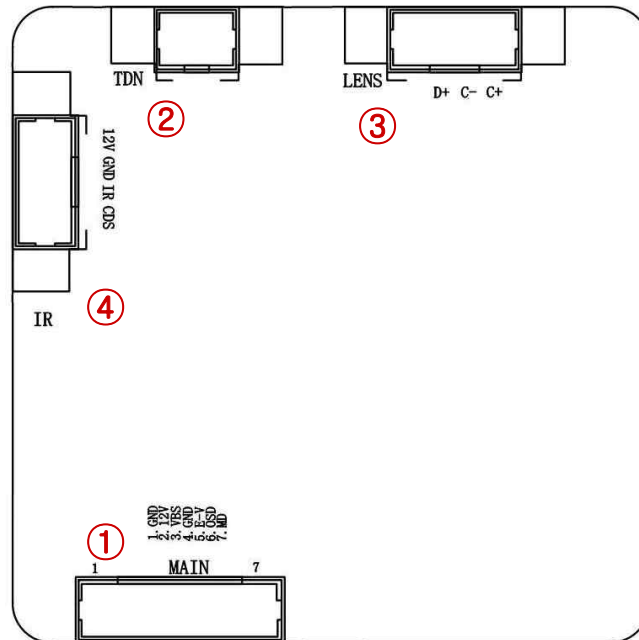

Connector	Pin number	Pin name	Description
①	1	GND	Board Ground
	2	12V	DC 12V input
	3	VBS	Composite Video Output
	4	GND	Board Ground
	5	E-V	Extra Composite Video Output
	6	AD/KEY	AD/KEY
	7	MD	Motion Detection
②	1	TDN MA +	DRIVE1
	2	TDN MA -	DRIVE2
③	1	DMP+	DAMP+
	2	DMP-	DAMP-
	3	DRV+	DRIVE+
	4	GND	Board Ground
④	1	12V	DC 12V Output
	2	GND	Board Ground
	3	IR	3.3V LED OUTPUT
	4	CDS	Day & Night Input (HIGH/LOW)

Address

Rm.915, Keumkang Hightech Valley, 177, Sagimakgol-ro Jungwon-ku, Seongnam-si, Gyeonggi-do, Korea