

DETAILS

Product Number	C15014_STRADA-2X2-T4-B
Family	Strada
Type	Lens
Color	clear
Diameter	50x50 mm
Height	9,02 mm
Style	square
Optic Material	PMMA
Holder Material	
Fastening	screw, pin
Status	production ready
ROHS Compliant	Yes
Date Updated	21/04/2016



OPTICAL PROPERTIES

LED	Viewing Angle	Light Beam	Efficiency	cd/lm	Connector
SMD 5050	Asymmetric deg	Asymmetric	94 %	0.580	-
XT-E	sim: Asymmetric	Asymmetric	-	-	-
XP-G2	sim: Asymmetric	Asymmetric	-	-	-
XHP35 HD	sim: Asymmetric	Asymmetric	-	-	-
XHP35 HI	sim: Asymmetric	Asymmetric	-	-	-
XP-L	sim: Asymmetric	Asymmetric	-	-	-
XP-L HI	sim: Asymmetric	Asymmetric	sim: 92 %	sim: 0.980	-
XM-L	sim: Asymmetric	Asymmetric	-	-	-
XP-L2	Asymmetric deg	Asymmetric	94 %	0.650	-
LUXEON TX	Asymmetric deg	Asymmetric	94 %	1.100	-
LUXEON 5050	Asymmetric deg	Asymmetric	94 %	0.640	-
NCSxx19B	sim: Asymmetric	Asymmetric	-	-	-
NVSxx19B/NVSxx19C	sim: Asymmetric	Asymmetric	-	-	-
NVSW3x9A	Asymmetric deg	Asymmetric	94 %	0.830	-
NVSxE21A	asym deg	Asymmetric	94 %	1.400	-
NWSx229A	sim: Asym	Asymmetric	sim: 87 %	sim: 0.640	-
Oslon Square Gen3	sim: Asymmetric	Asymmetric	-	-	-
Oslon Square PC	sim: Asymmetric	Asymmetric	-	-	-
Duris S8	sim: Asymmetric	Asymmetric	-	-	-
Duris P9	sim: Asymmetric	Asymmetric	sim: 90 %	sim: 0.690	-
Fortimo FastFlex LED board 2x8 DA G4	sim: Asymmetric	Asymmetric	sim: 91 %	sim: 1.020	-
Fortimo FastFlex LED board 2x8 DAX G4	sim: Asymmetric	Asymmetric	sim: 88 %	sim: 0.710	-
LH351D	Asymmetric deg	Asymmetric	94 %	0.630	-
LH351C	Asymmetric deg	Asymmetric	94 %	0.900	-
LH508A	Asymmetric deg	Asymmetric	94 %	0.620	-



PRODUCT DATASHEET

Strada series

last update 21/4/2016

OPTICAL PROPERTIES

LED	Viewing Angle	Light Beam	Effi- ciency	cd/lm	Connector
RLE G1 49x223mm 4000lm xxx EXC OT	Asymmetric	degAsymmetric	94 %	1.100	-
RLE G1 49x245mm 4000lm xxx EXC OT	Asymmetric	degAsymmetric	94 %	1.100	-
RLE G1 49x121mm 2000lm xxx EXC OT	Asymmetric	degAsymmetric	94 %	1.100	-
RLE G1 49x133mm 2000lm xxx EXC OT	Asymmetric	degAsymmetric	94 %	1.100	-

D

C

B

A

4

4

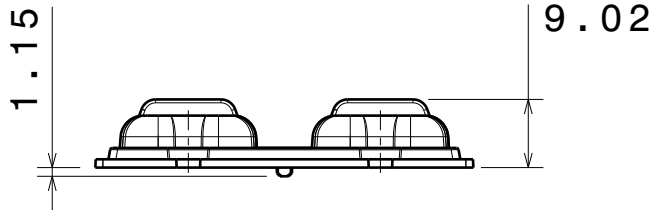

Front view

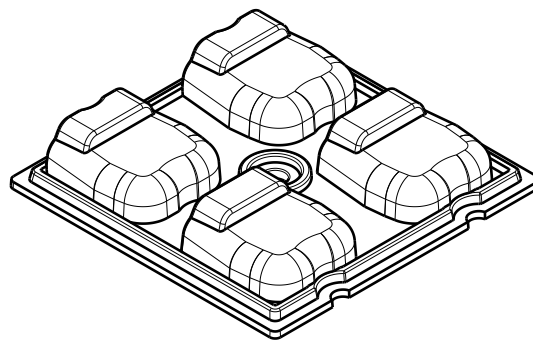

Isometric view

3

3

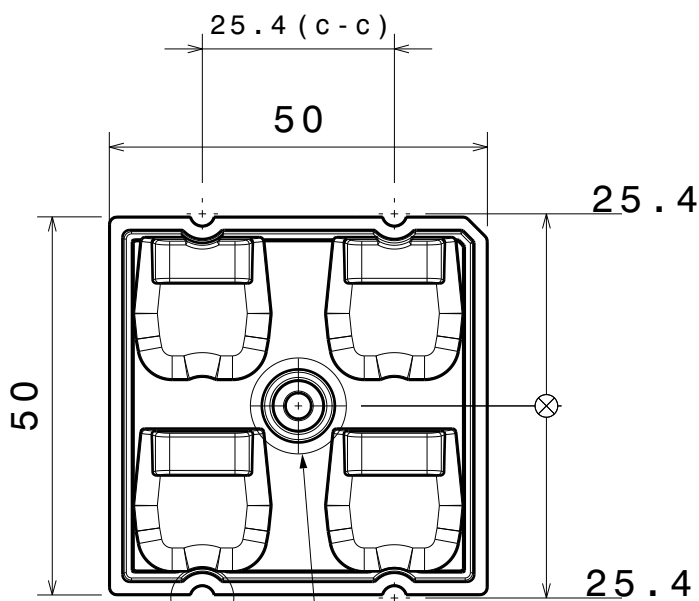

Top view

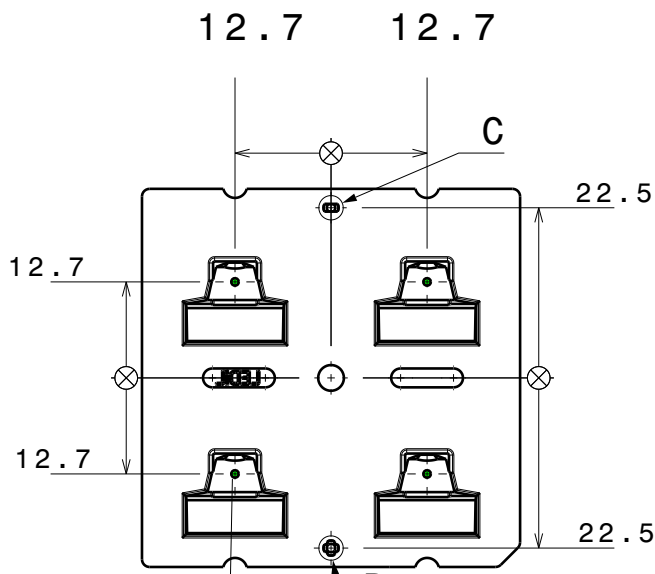

Bottom view

2

2

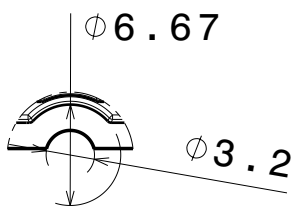

Detail A

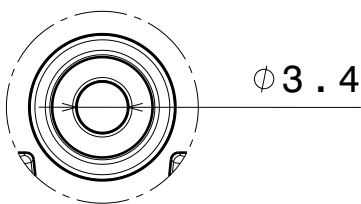

Detail B

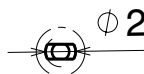

Detail C



Detail D

Tolerances if not otherwise shown
 According to DIN ISO 2768-1
 Linear measures:
 up to 30mm class M, otherwise class C
 According to DIN ISO 2768-2
 Form and position: class L



Ledil Oy
 Salorankatu 10
 FIN 24240 SALO
 Finland

THIRD ANGLE PROJECTION:

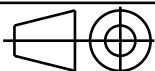

DRAWING TITLE

C15014_STRADA-2X2-T4-B

This drawing is the property
 of LEDiL Oy. It may not be
 reproduced, copied or
 communicated without a written
 agreement with LEDiL Oy.

SIZE PART NUMBER

A4

C15014

SCALE

1:1

WEIGHT

9,39 g

SHEET

1/1

D

A

1

Luminaire: LEDiL Oy C15014_STRADA-2X2-T4-B_(Bridgelux_5050_Gen2)

Lamps: 1 x Bridgelux_5050_Gen2_2x2_(BXEP-57C-435-09B)_1447.45lm@250mA_CCT=5700K_P=8.29761W_I=0.25A

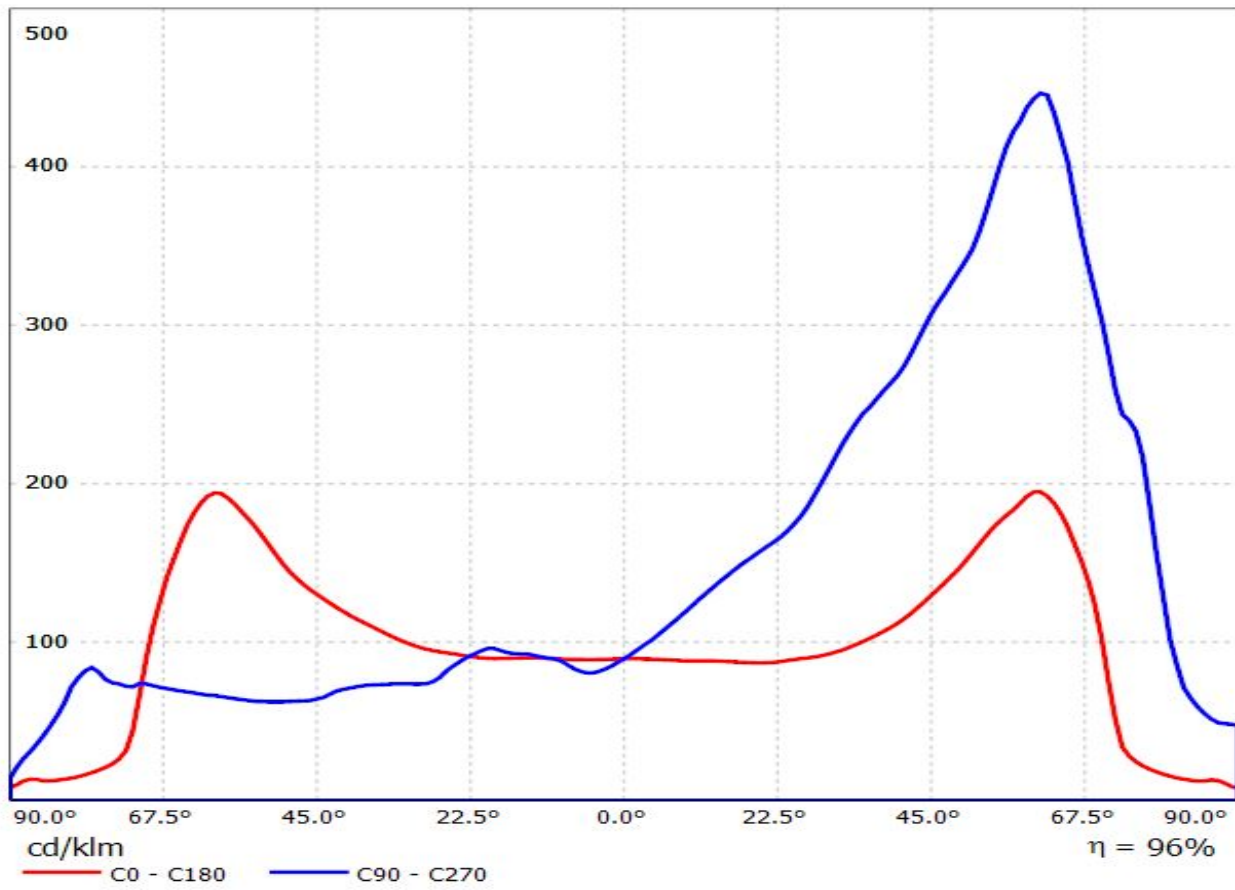

Luminaire: Ledil Oy C15014_STRADA-2X2-T4-B_simulated_XP-L HI
Lamps: 1 x Cree XP-L HI



Luminaire: Ledil C15014_STRADA-2X2-T4-B_(XP-L2)

Lamps: 1 x Cree_XP-L2_2x2_(XPLBWT-00-0000-000BV50E3)550.93lm@250mA_P=2.7815W_I=0.25A

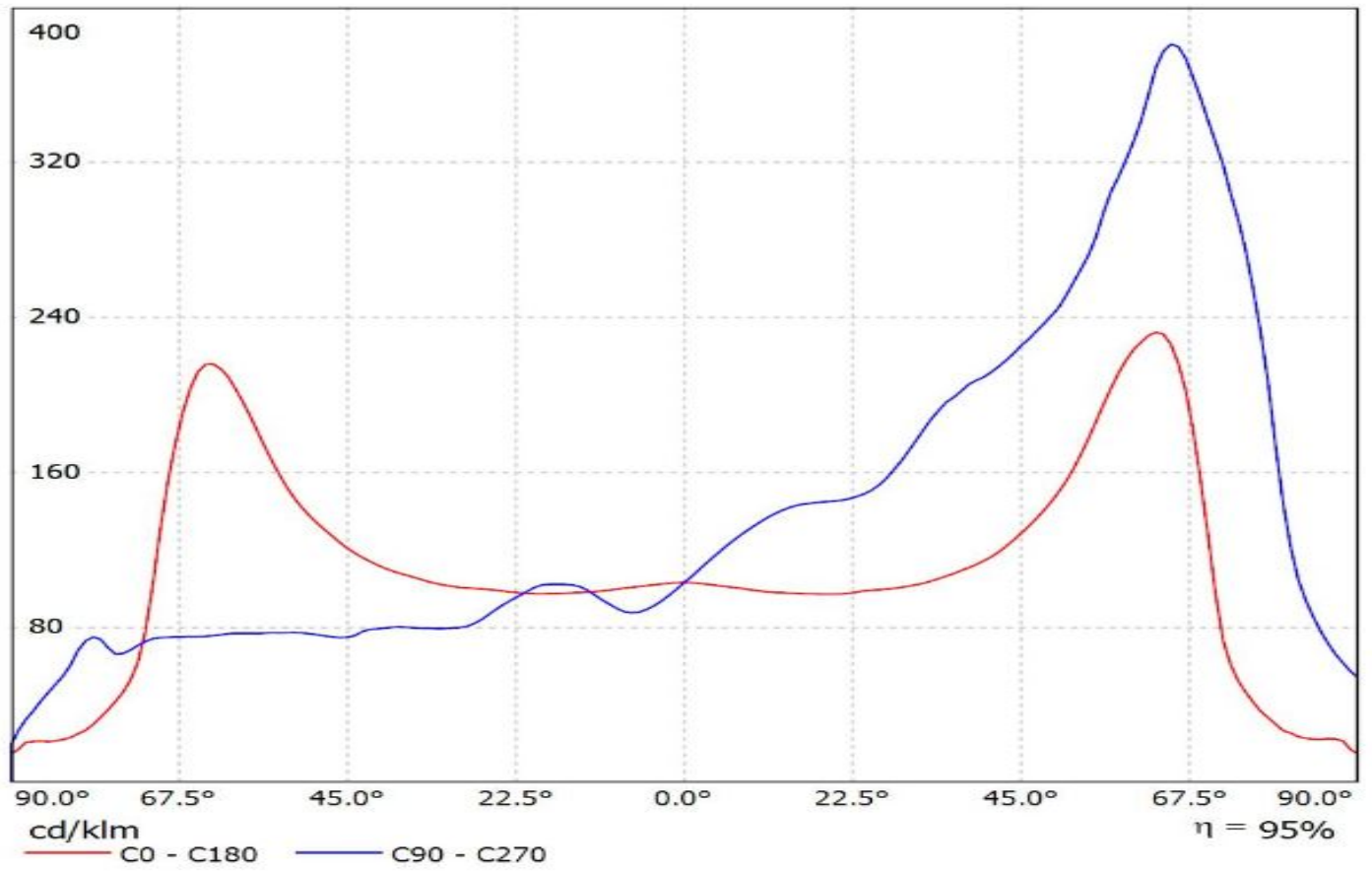

Luminaire: Ledil C15014_STRADA-2X2-T4-B_(LUXEON_TX)
Lamps: 1 x LUXEON_TX_2x2_(L1T2-3585)_330.32lm@250mA_P=2.8W_I=0.25A

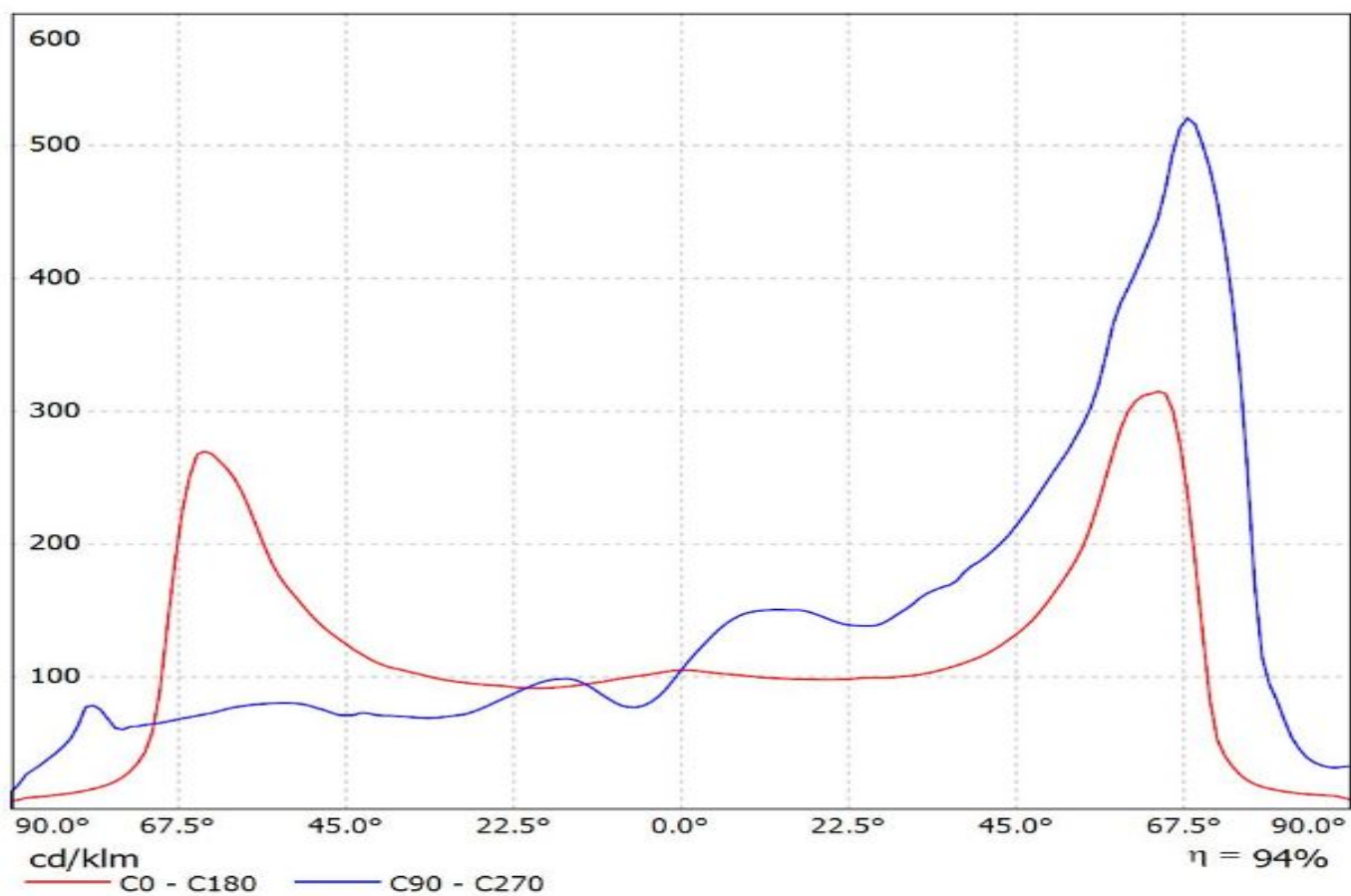

Luminaire: LEDiL Oy C15014_STRADA-2X2-T4-B_(Luxeon_5050)

Lamps: 1 x Luxeon_5050_2x2_1251.02lm@80mA_CCT=5700K_P=7.27443W_I=0.080A_70CRI

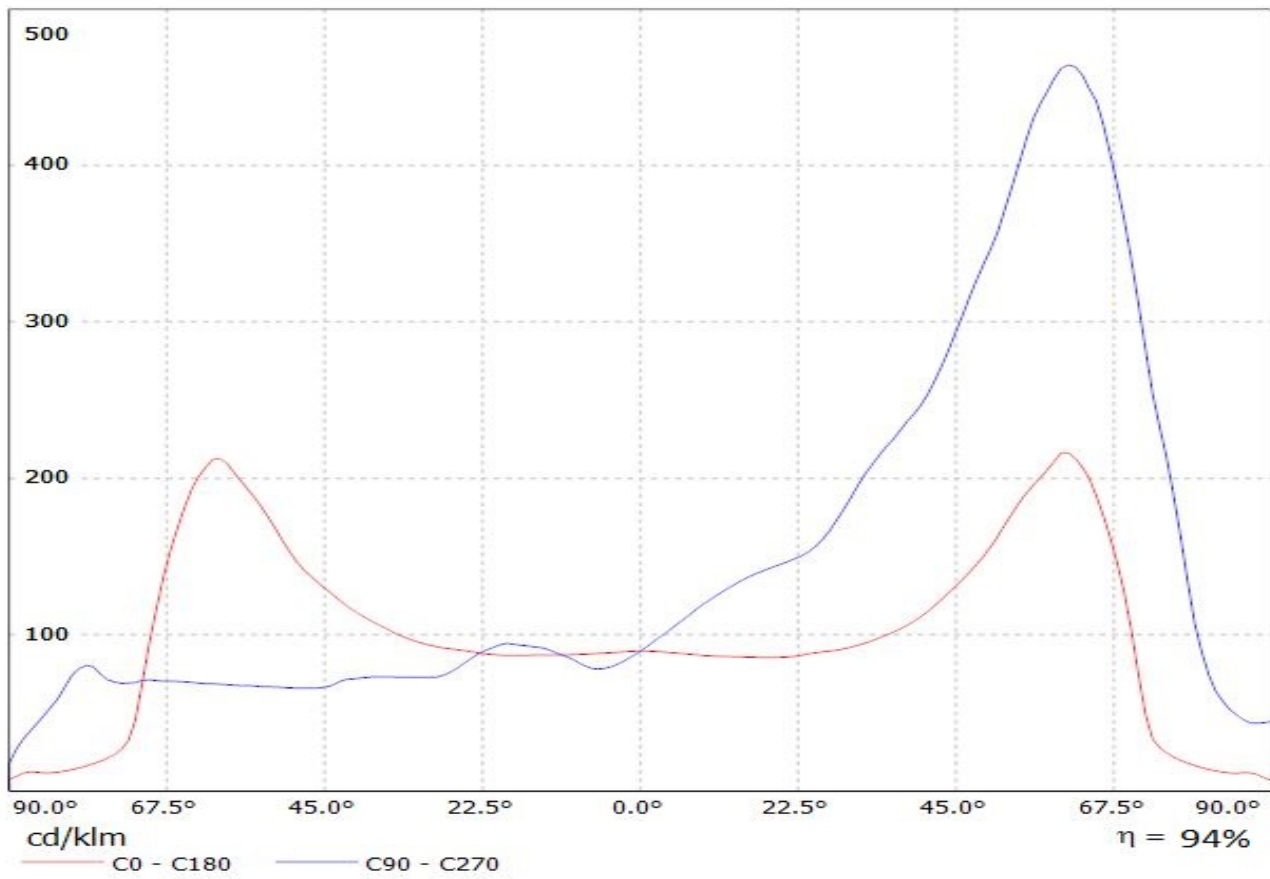

Luminaire: Ledil C15014_STRADA-2X2-T4-B_(NVSW319AE)
Lamps: 1 x Nichia_NVSW319AE_(sm405D440f2L2R70)

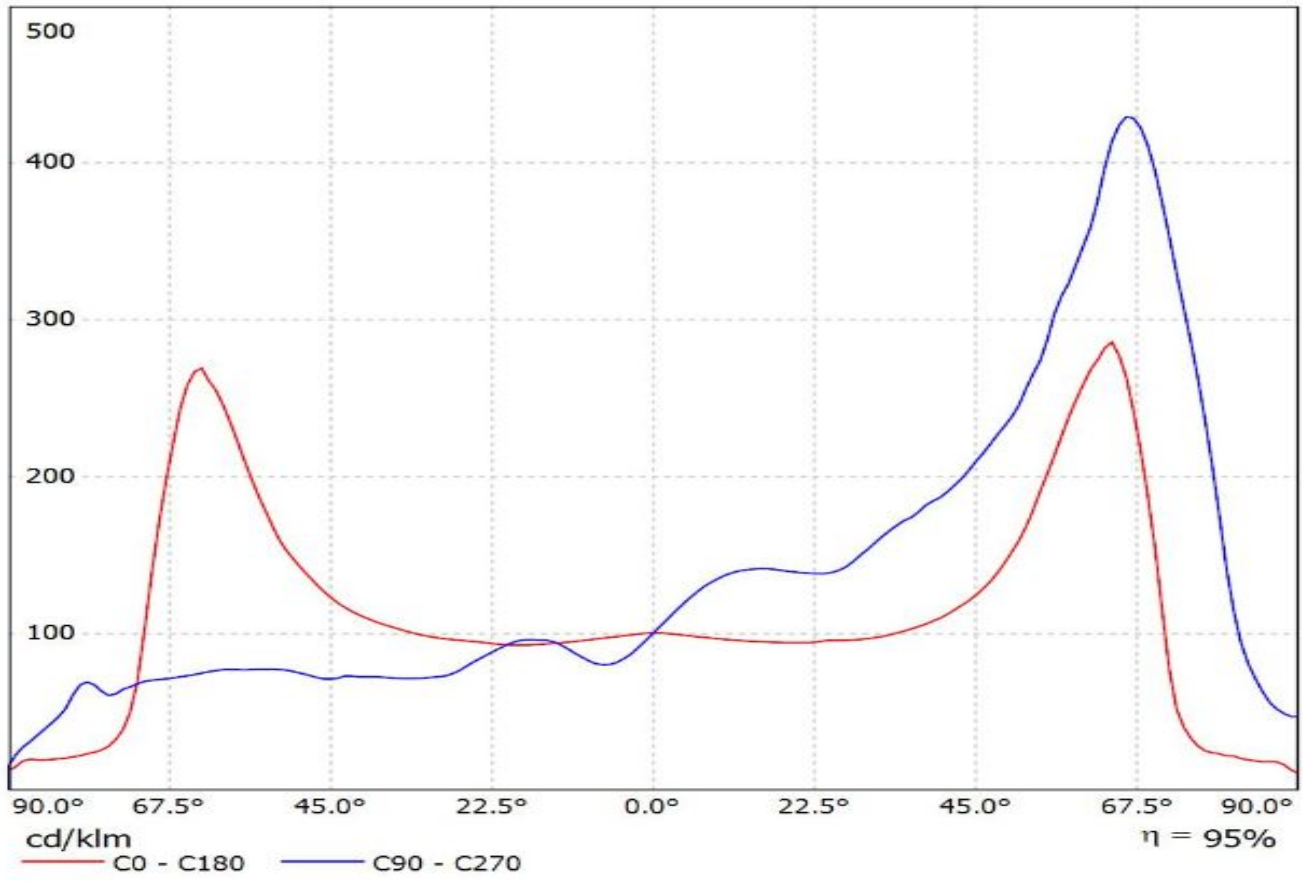

Luminaire: LEDiL Oy C15014_STRADA-2X2-T4-B_(E21A)
Lamps: 1 x Nichia_E21A_452.248lm@250mA_2.805W_I=0.250A

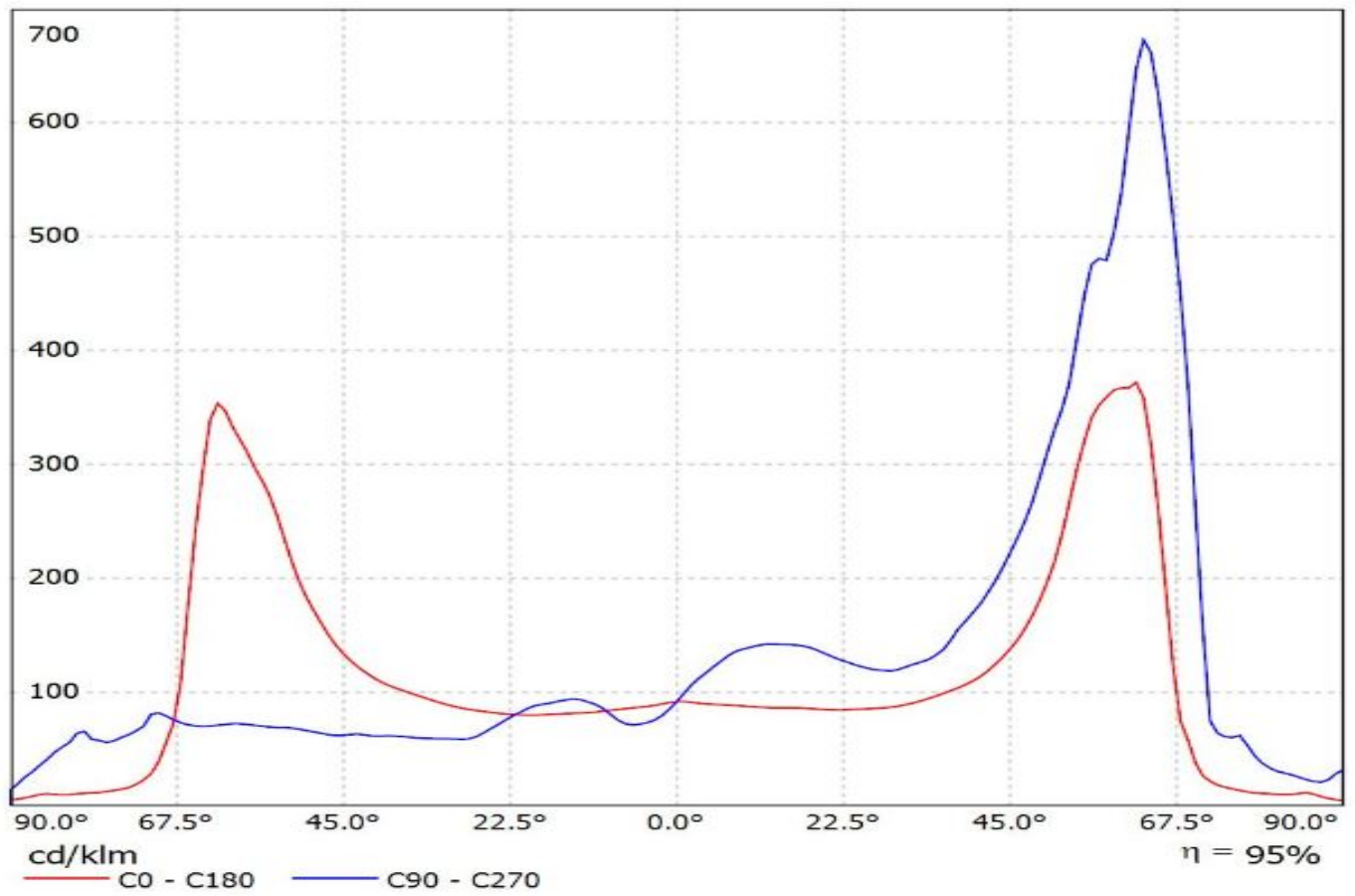

Luminaire: Ledil Oy C15014_STRADA-2X2-T4-B_(NWSx229A)_SIMULATED
Lamps: 1 x Nichi NWSW229A

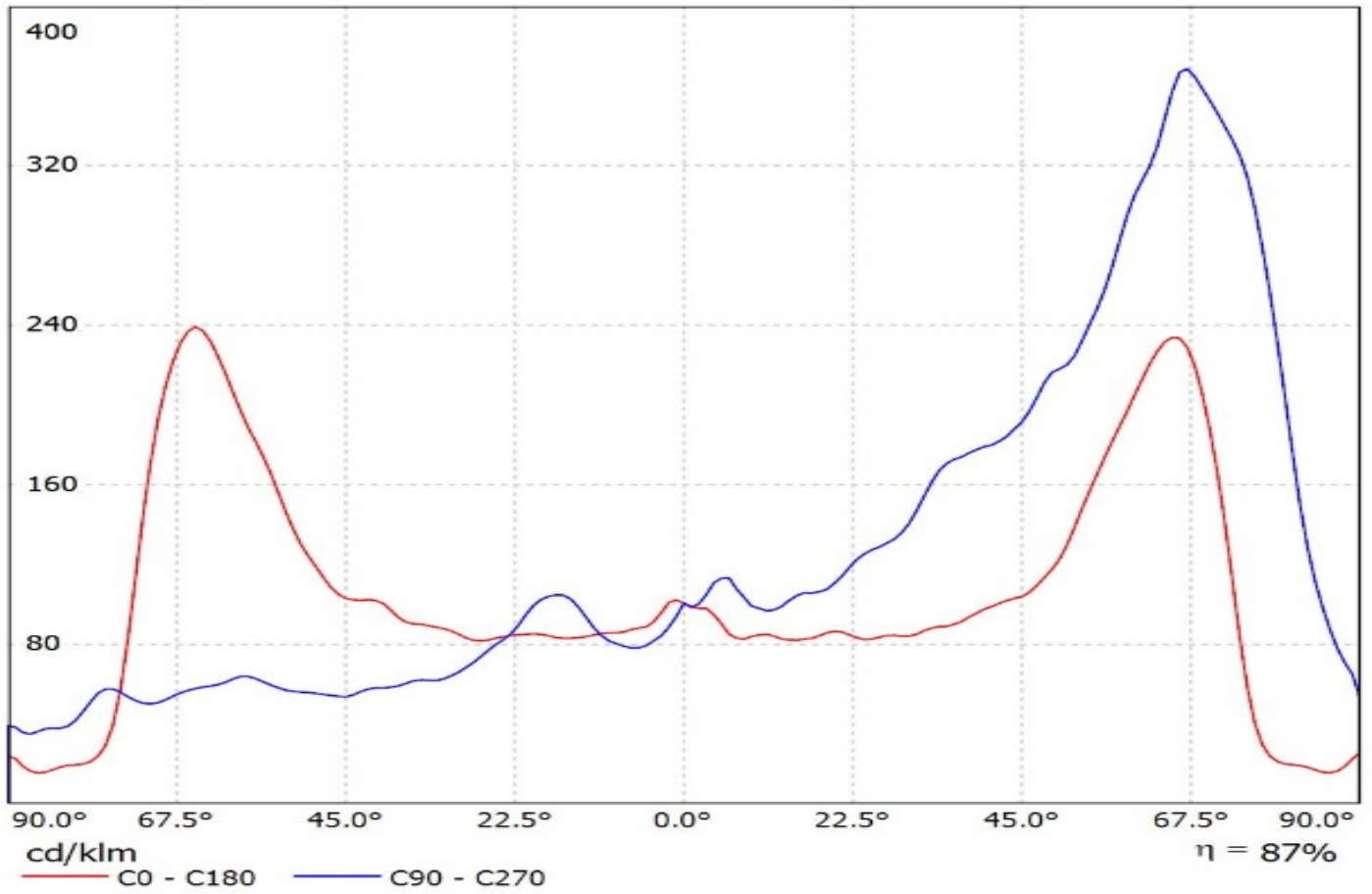

Luminaire: Ledil Oy C15014_STRADA-2X2-T4-B_OSAM_DURIS_P9_SIMULATED
Lamps: 1 x OSRAM DURIS P9

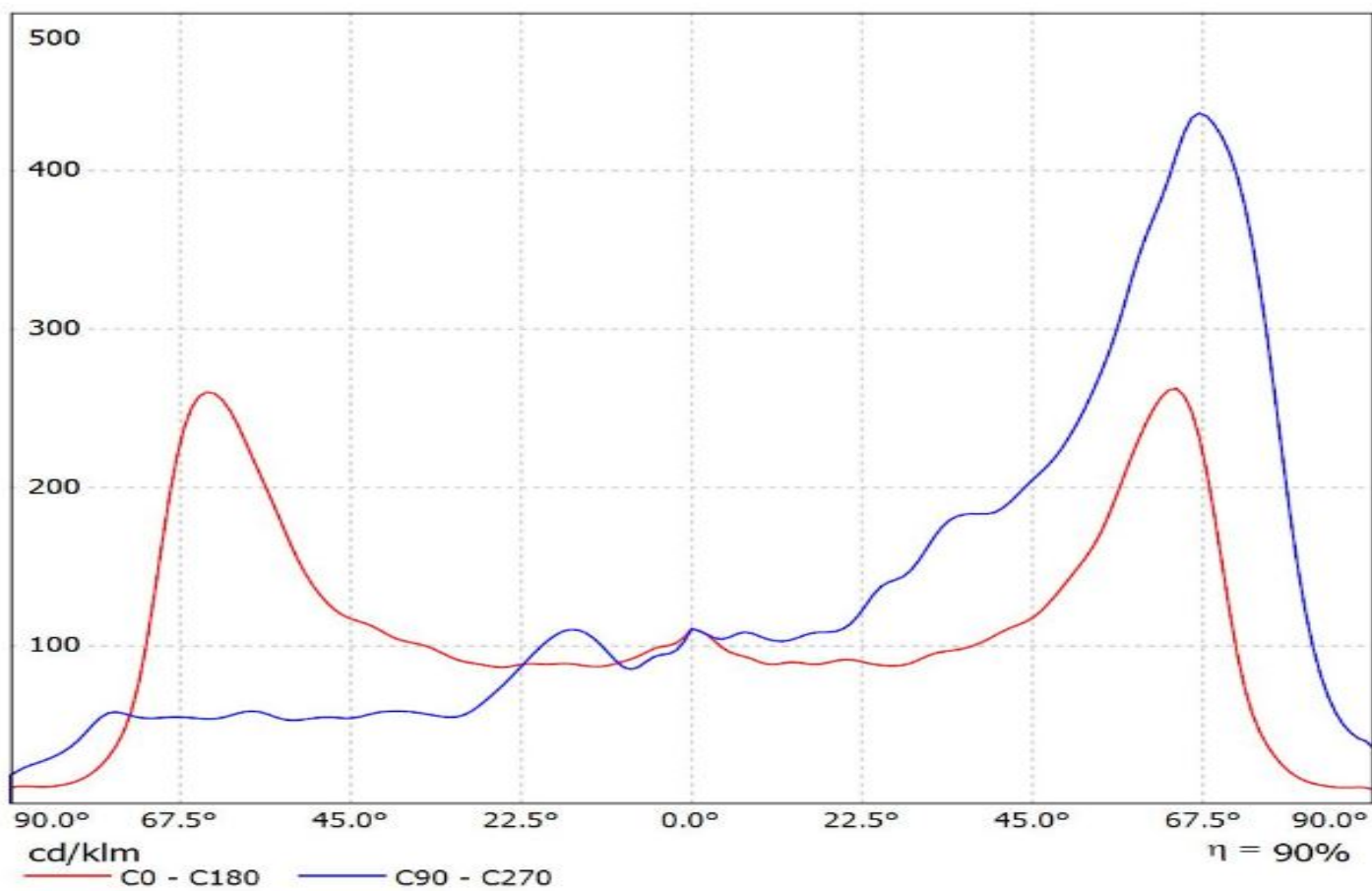

Luminaire: Ledil Oy C15014_STRADA-2X2-T4-B_Fortimo FastFlex LED board 2x8 DA G4_SIMULATED
Lamps: 1 x Fortimo FastFlex LED board 2x8 DA G4_SIMULATED

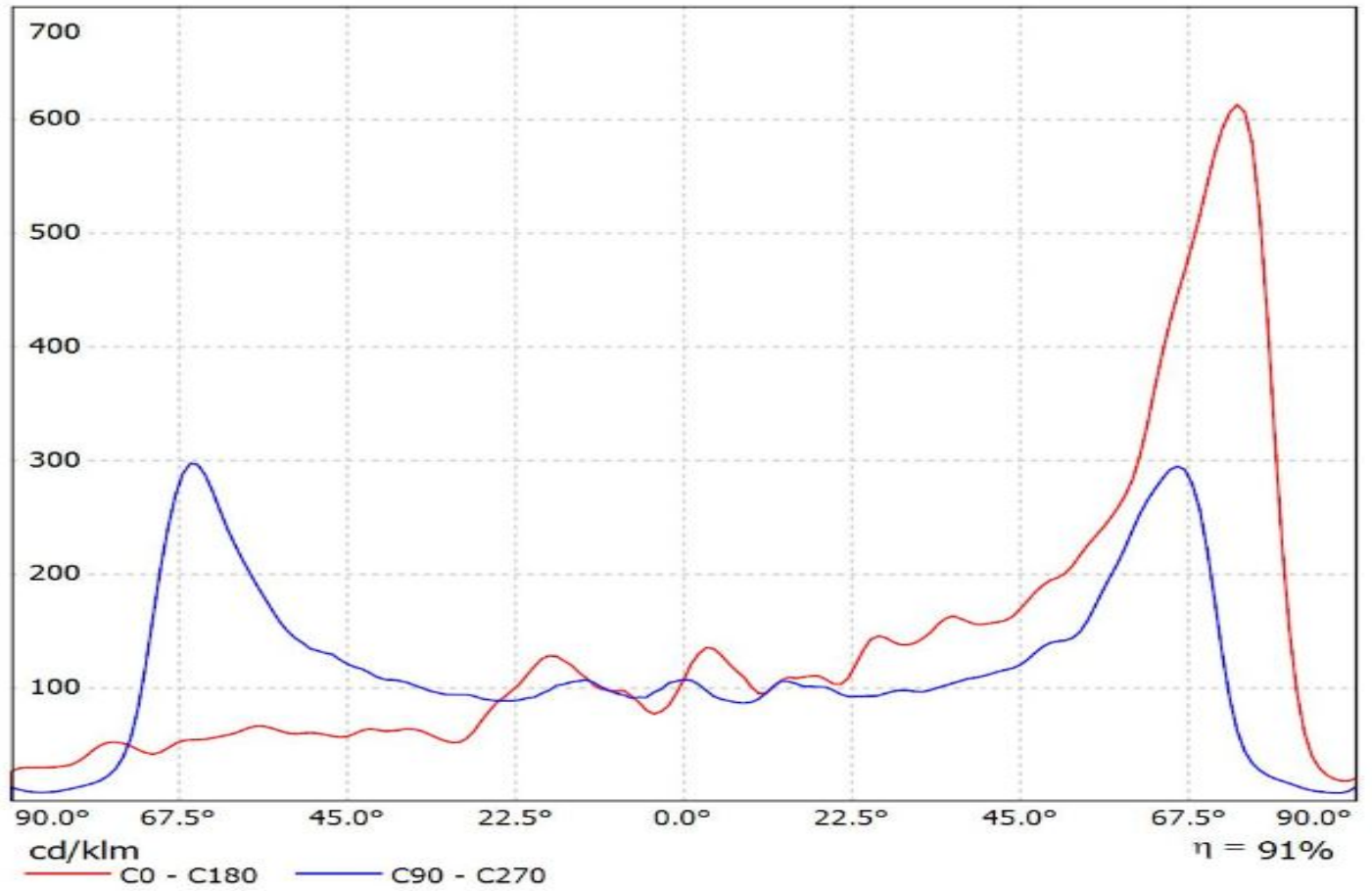

Luminaire: Ledil Oy C15014_STRADA-2X2-T4-B_Fortimo FastFlex LED board 2x8 DAX G4_SIMULATED
Lamps: 1 x Fortimo FastFlex LED board 2x8 DAX G4_SIMULATED

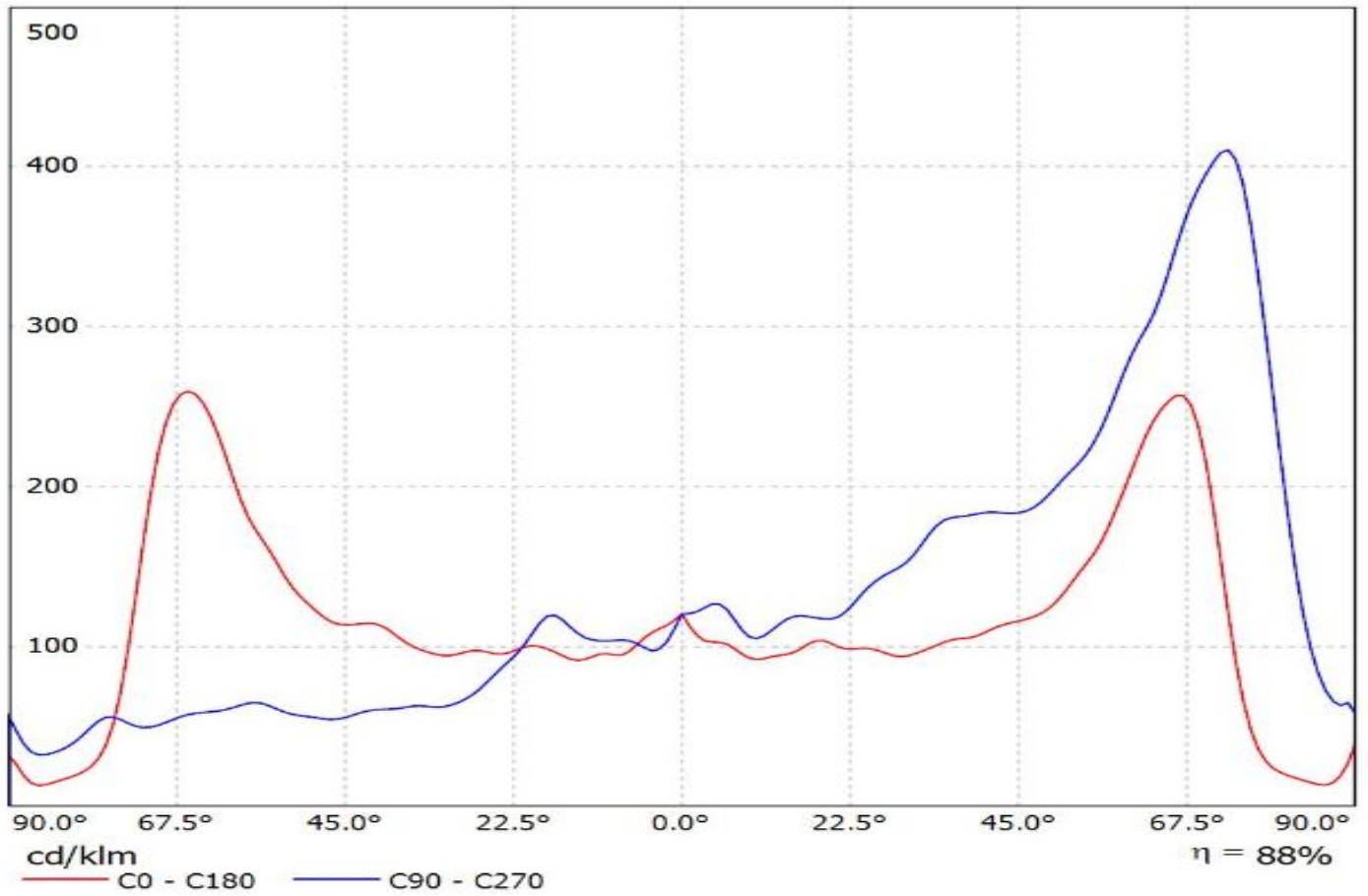

Luminaire: LEDiL Oy C15014_STRADA-2X2-T4-B_(LH351D)
Lamps: 1 x Samsung_LH351D_524.264lm@250mA_P=2.7523W_I=0.250A

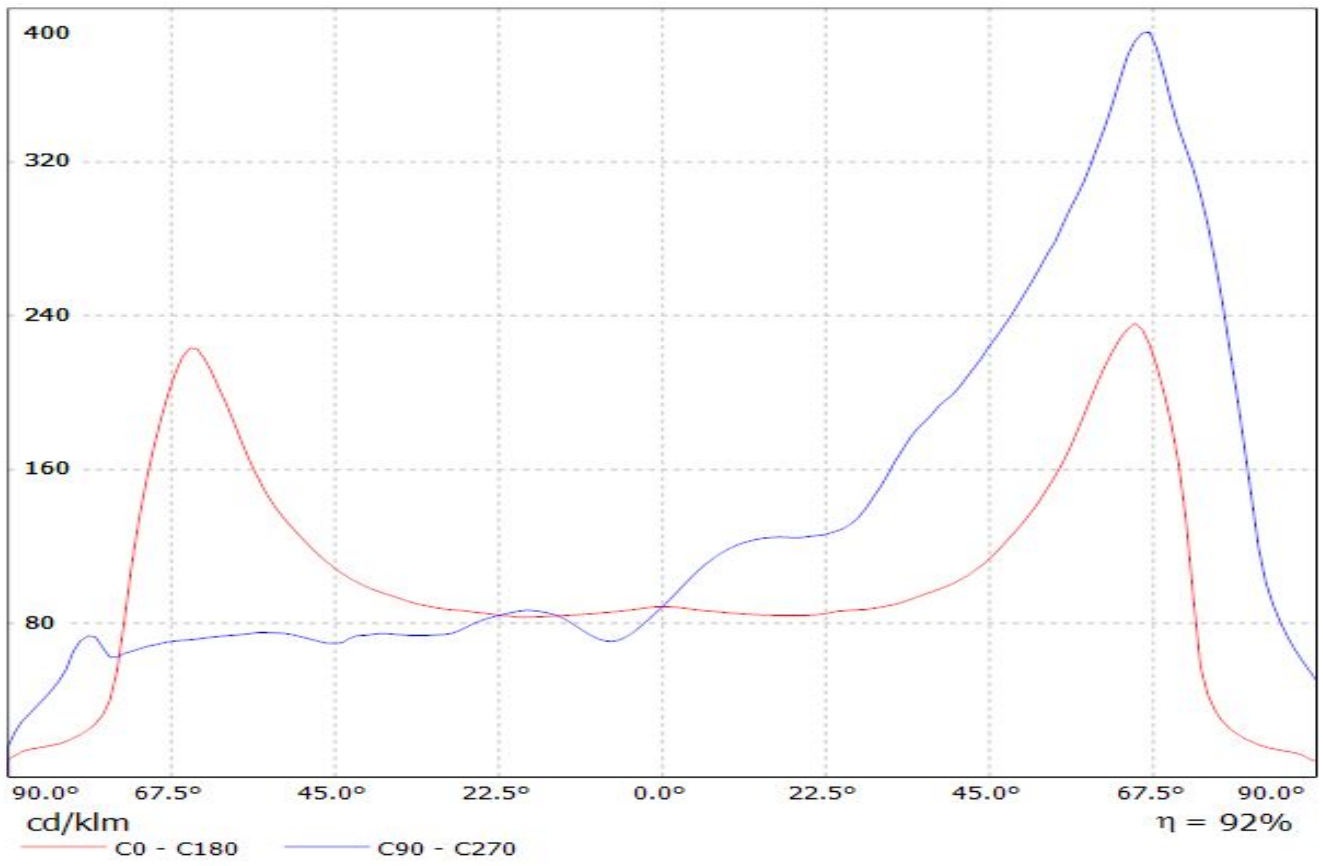

Luminaire: Ledil C15014_STRADA-2X2-T4-B_(LH351C)
Lamps: 1 x Samsung_LH351C_518.223lm@250mA_P=2.85225W_I=0.25A

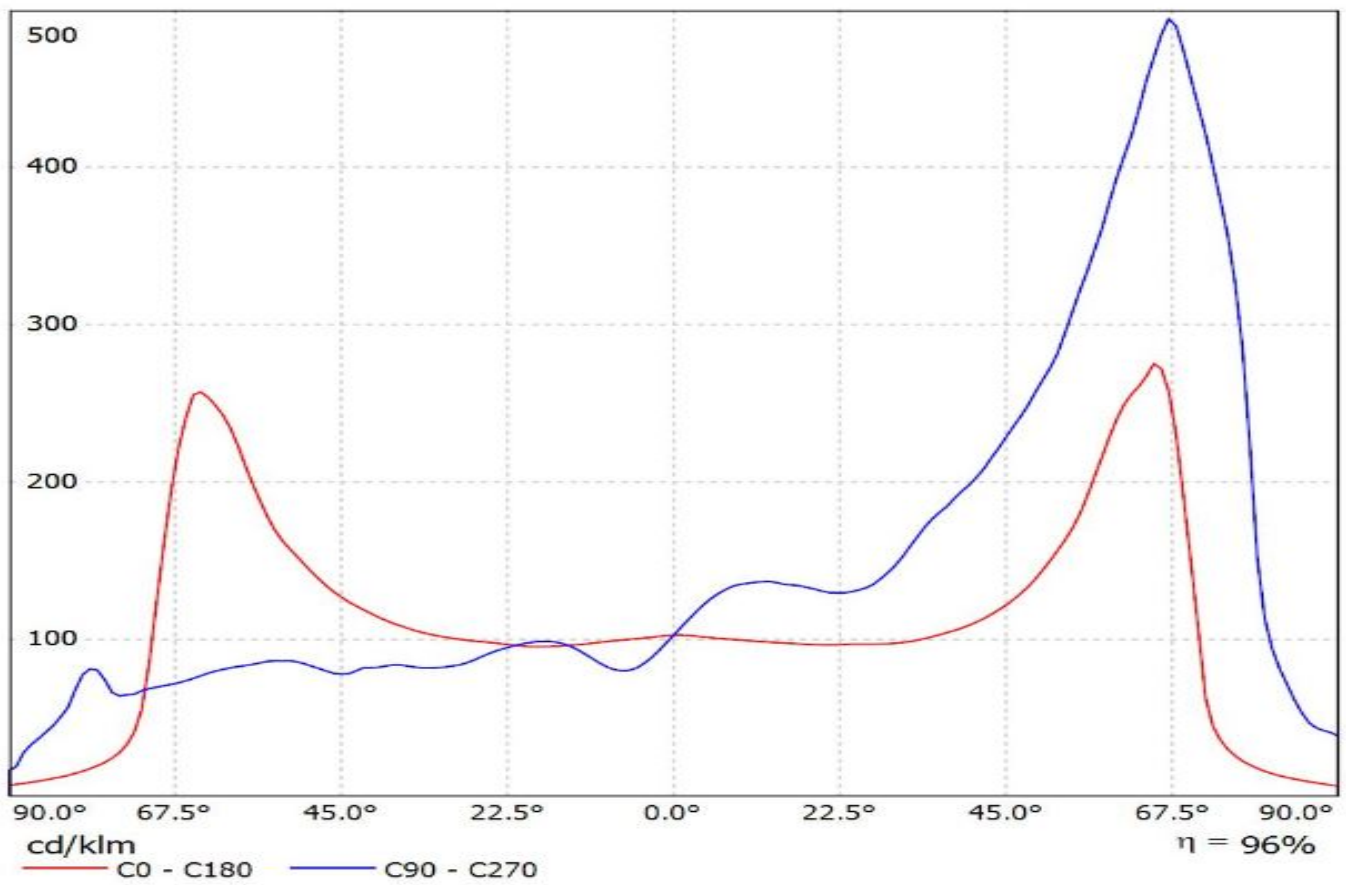

Luminaire: Ledil C15014_STRADA-2X2-T4-B_(LH508A)

Lamps: 1 x Samsung_LH508A_2x2_2060.04lm@160mA_CCT=5000K_CRI=80_P=15.5405W_I=0.16A

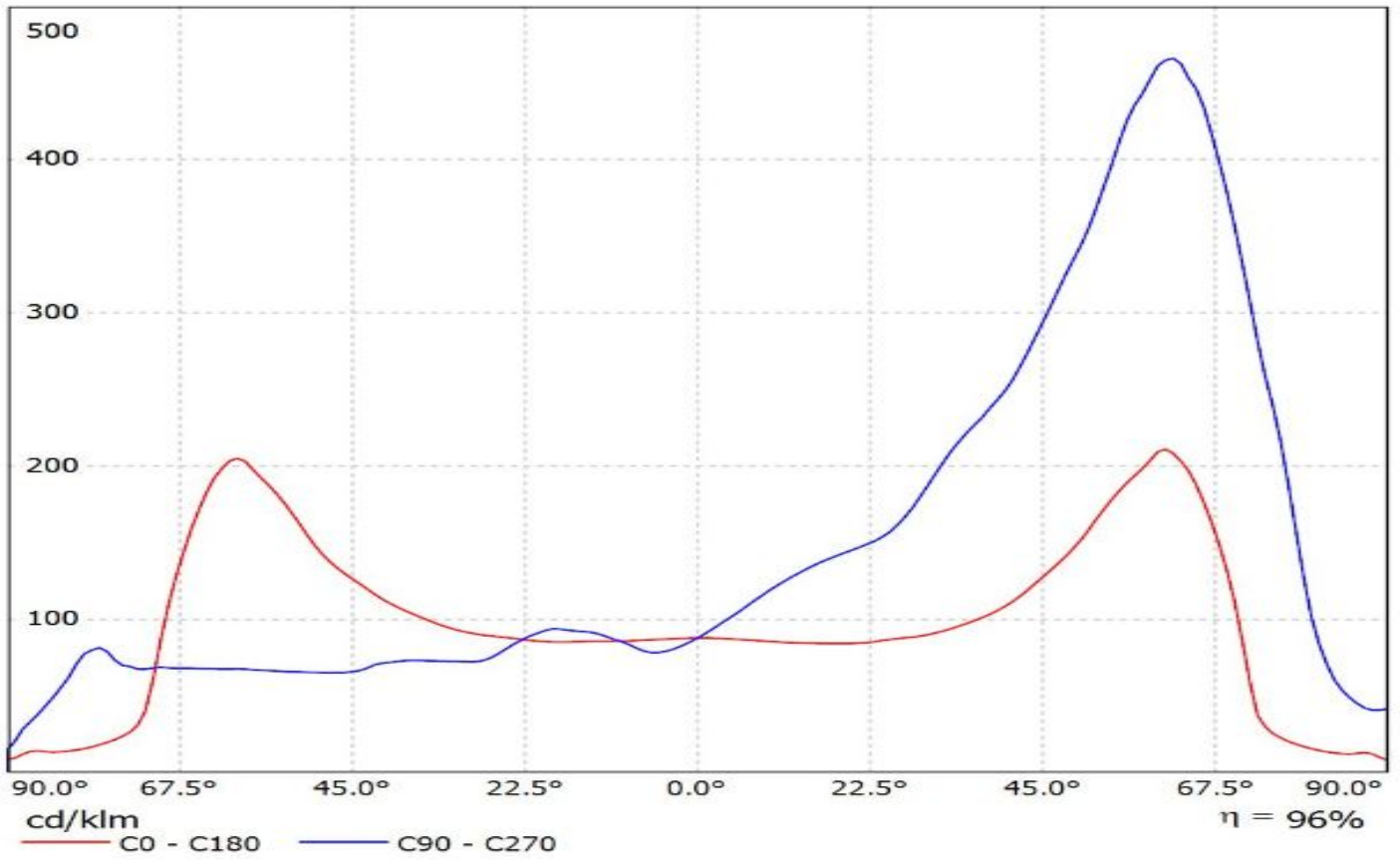

Luminaire: LEDiL Oy C15014_STRADA-2X2-T4-B_(Tridonic_Module_RLE_G1)
Lamps: 1 x Tridonic_Module_RLE_G1_4594.42lm@700mA_P=32.1515W_I=0.700A

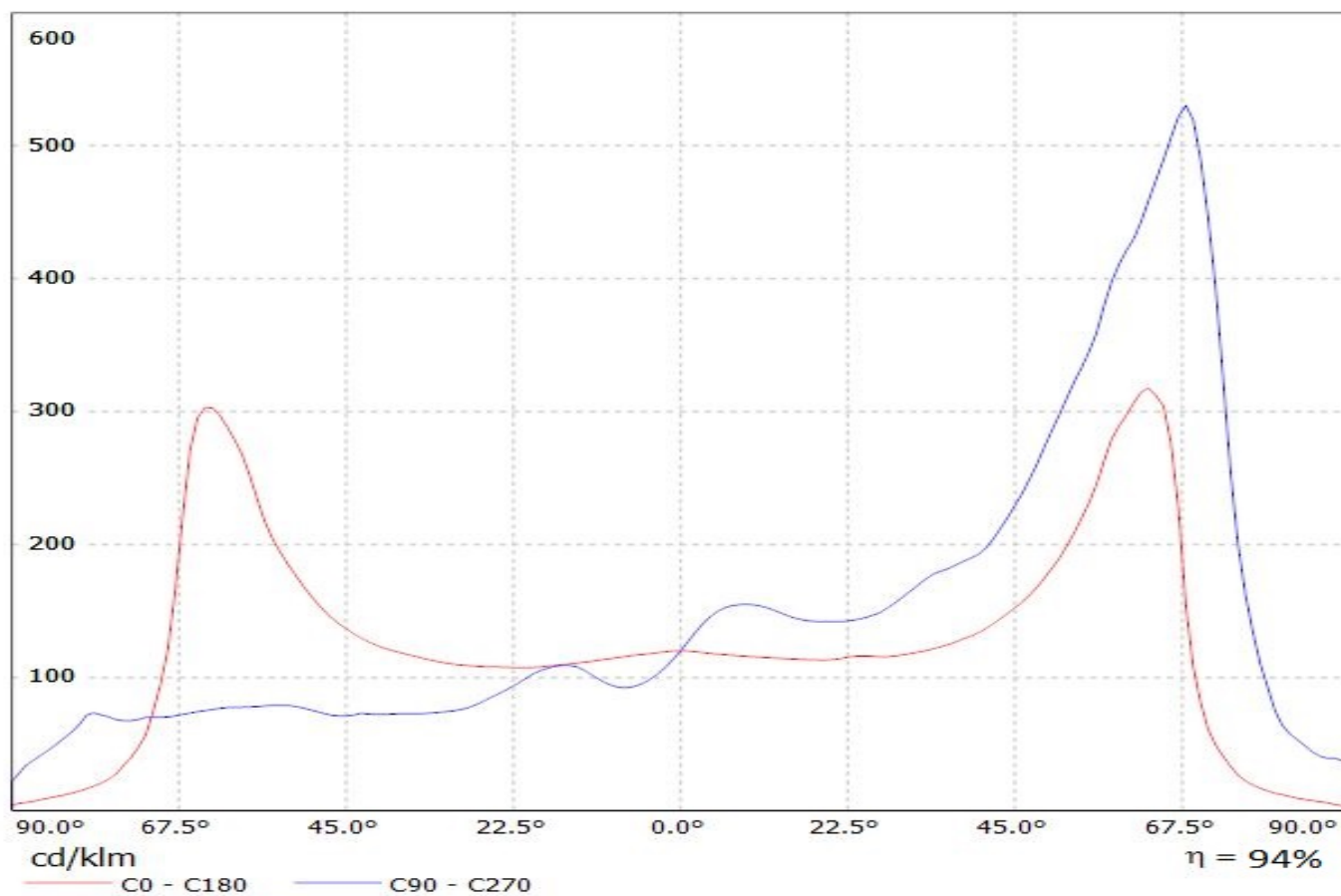

Luminaire: LEDiL Oy C15014_STRADA-2X2-T4-B_(Tridonic_Module_RLE_G1)
Lamps: 1 x Tridonic_Module_RLE_G1_4594.42lm@700mA_P=32.1515W_I=0.700A

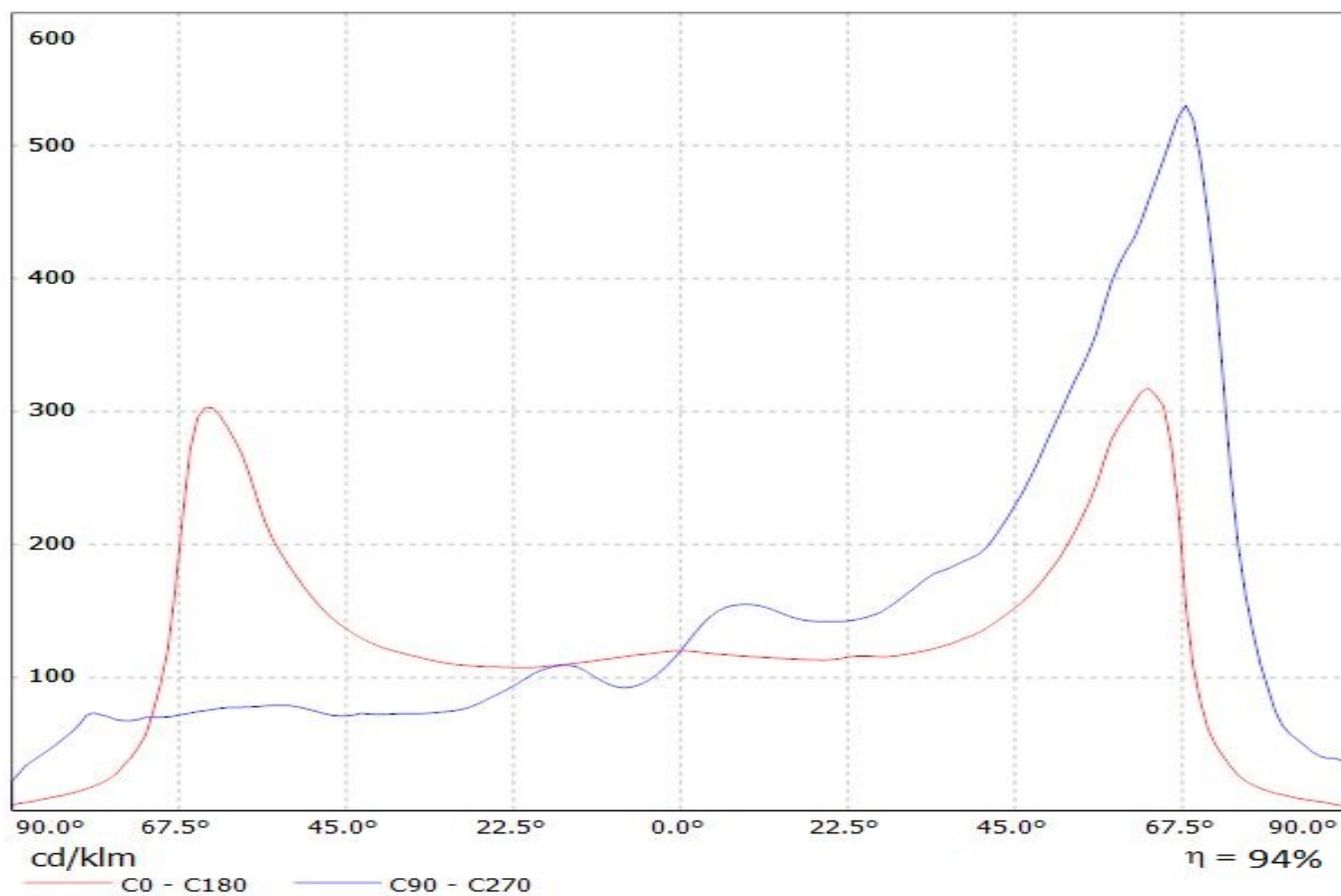

Luminaire: LEDiL Oy C15014_STRADA-2X2-T4-B (Tridonic Module_RLE_G1)
Lamps: 1 x Tridonic_Module_RLE_G1_2288lm@700mA_P=16W_I=0.700A

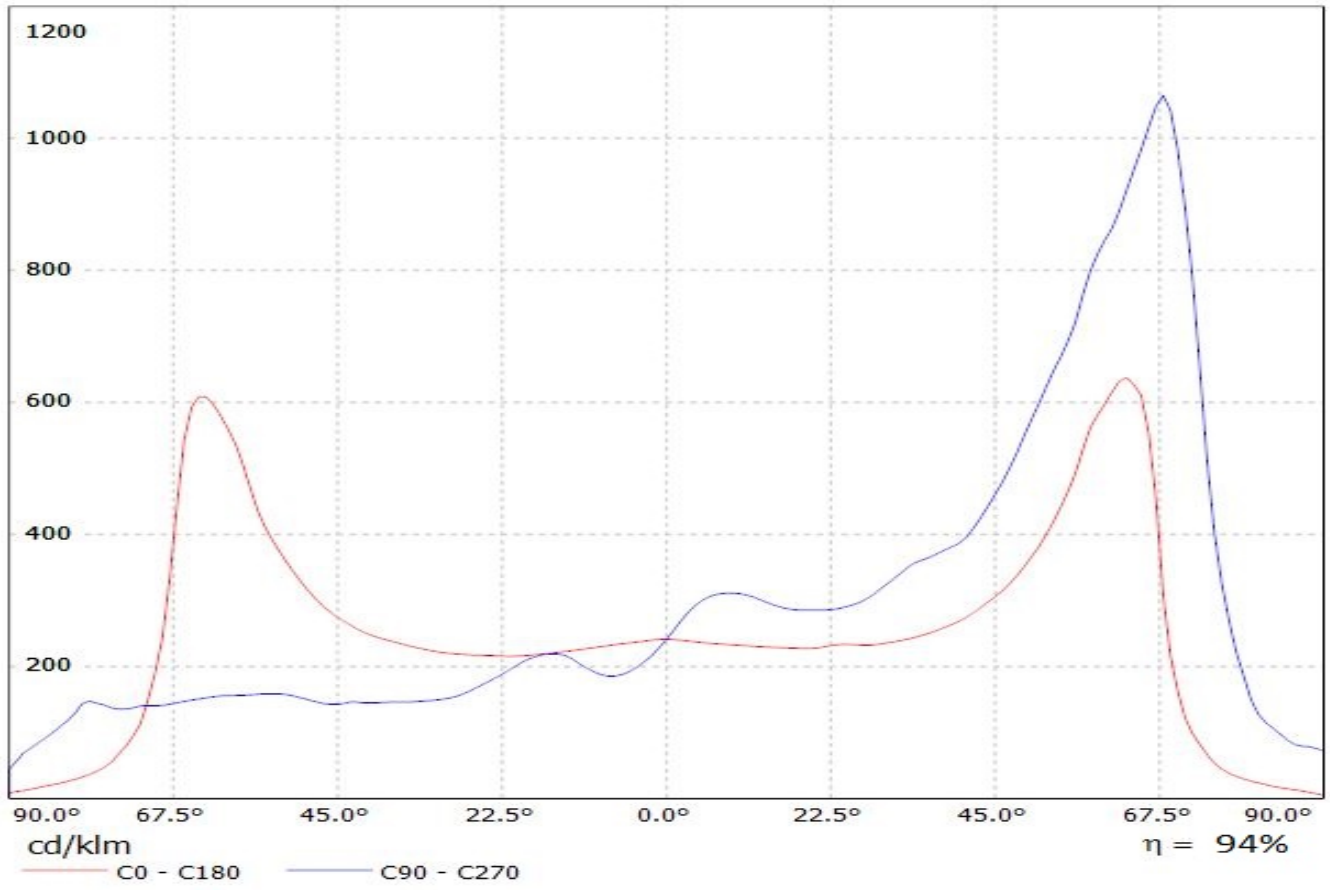

Luminaire: LEDiL Oy C15014_STRADA-2X2-T4-B (Tridonic Module_RLE_G1)
Lamps: 1 x Tridonic_Module_RLE_G1_2288lm@700mA_P=16W_I=0.700A

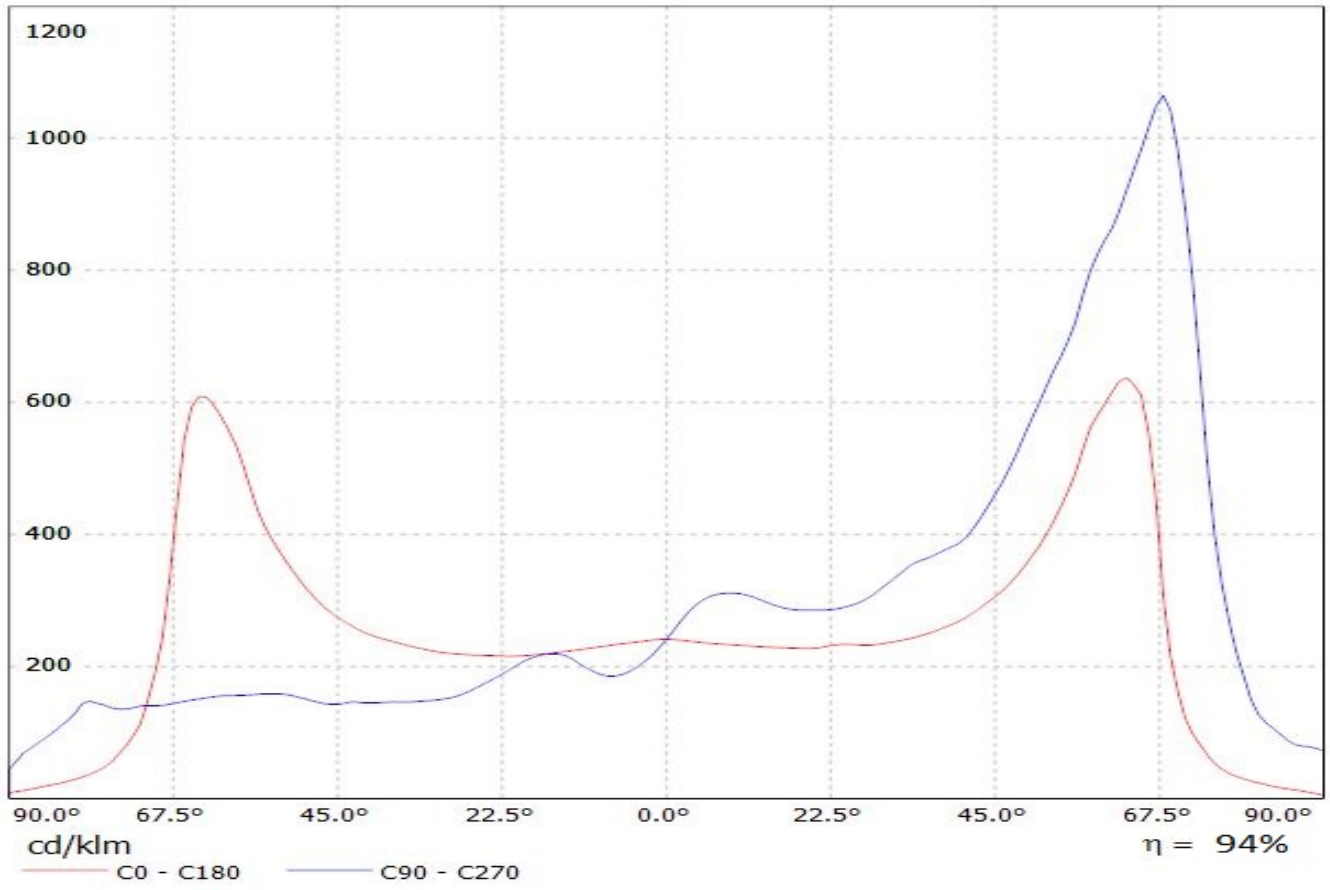

Luminaire: LEDiL Oy C15014_STRADA-2X2-T4-B (Bridgelux_5050_Gen2)

Lamps: 1 x Bridgelux_5050_Gen2_2x2_(BXEP-57C-435-09B)_1447.45lm@250mA_CCT=5700K_P=8.29761W_I=0.25A

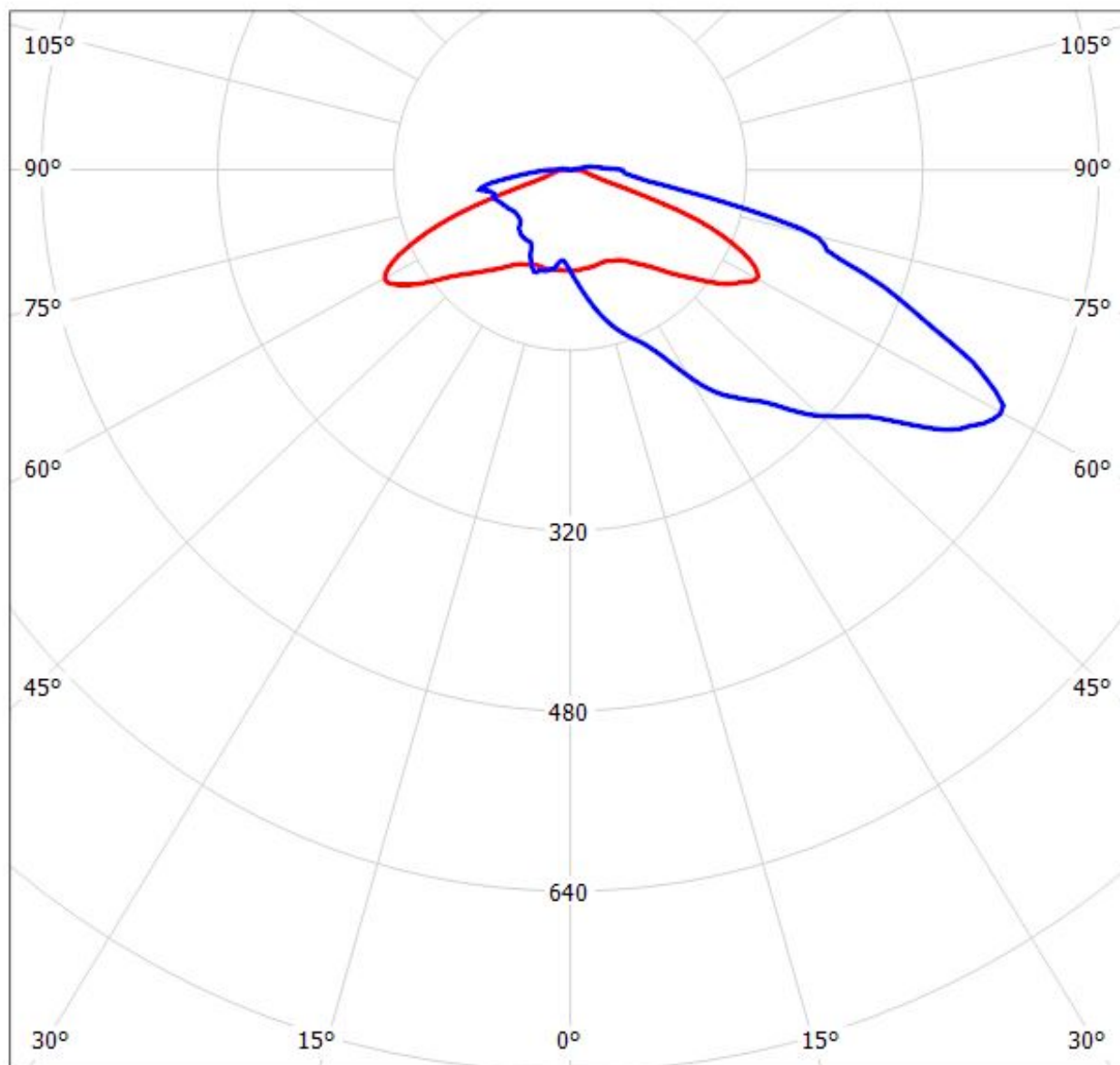

cd/klm

— C0 - C180 — C90 - C270

$\eta = 96\%$

Luminaire: Ledil Oy C15014_STRADA-2X2-T4-B_simulated_XT-E
Lamps: 1 x Cree XT-E

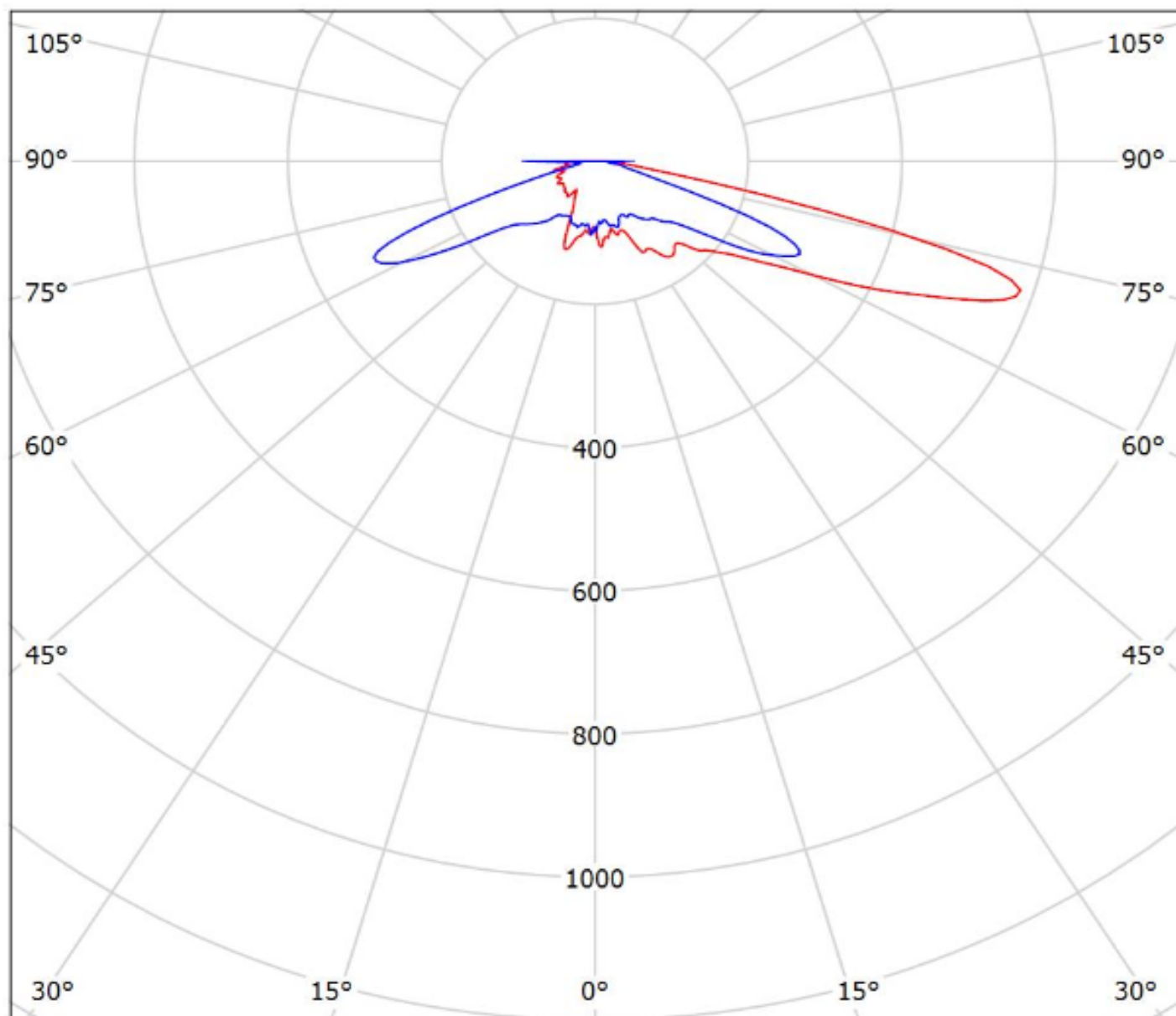

cd/klm

— C0 - C180 — C90 - C270

$\eta = 91\%$

Luminaire: Ledil Oy C15014_STRADA-2X2-T4-B_simulated_XP-G2
Lamps: 1 x Cree XP-G2

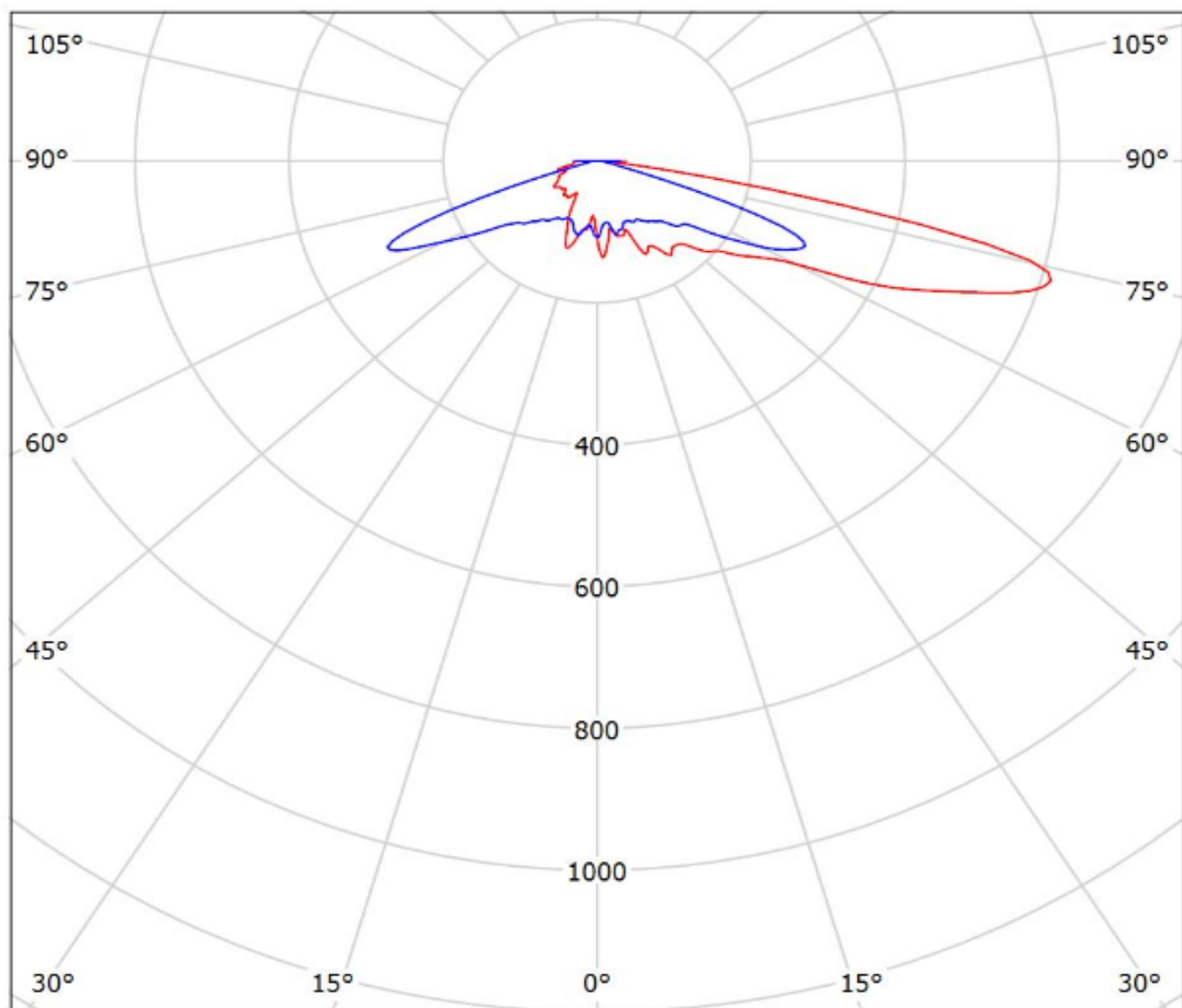

cd/klm

— C0 - C180 — C90 - C270

$\eta = 91\%$

Luminaire: Ledil Oy C15014_STRADA-2X2-T4-B_simulated_XHP-35 HD
Lamps: 1 x Cree XHP-35 HD

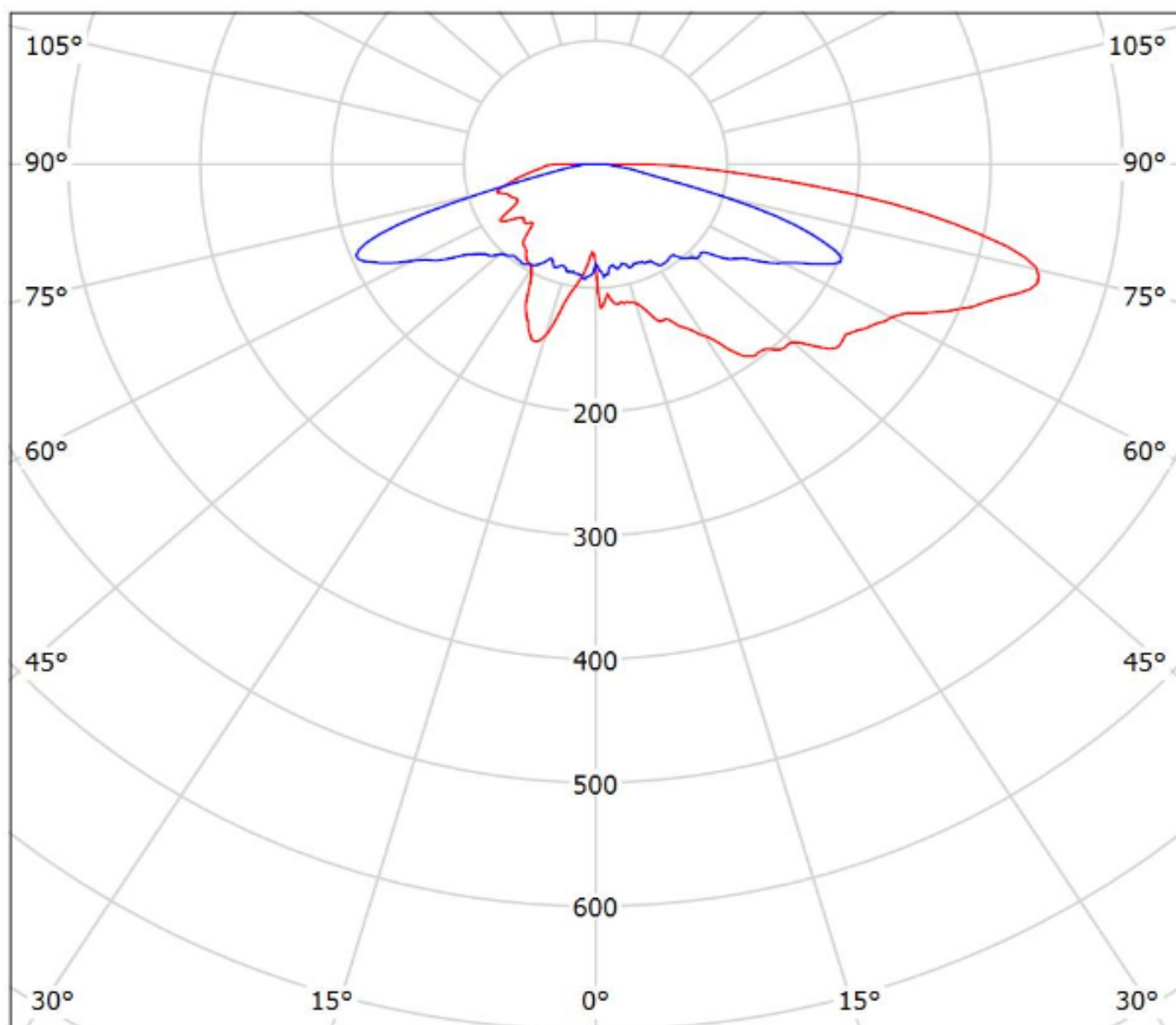

cd/klm

— C0 - C180 — C90 - C270

$\eta = 88\%$

Luminaire: Ledil Oy C15014_STRADA-2X2-T4-B_simulated_XHP-35 HI

Lamps: 1 x Cree XHP-35 HI

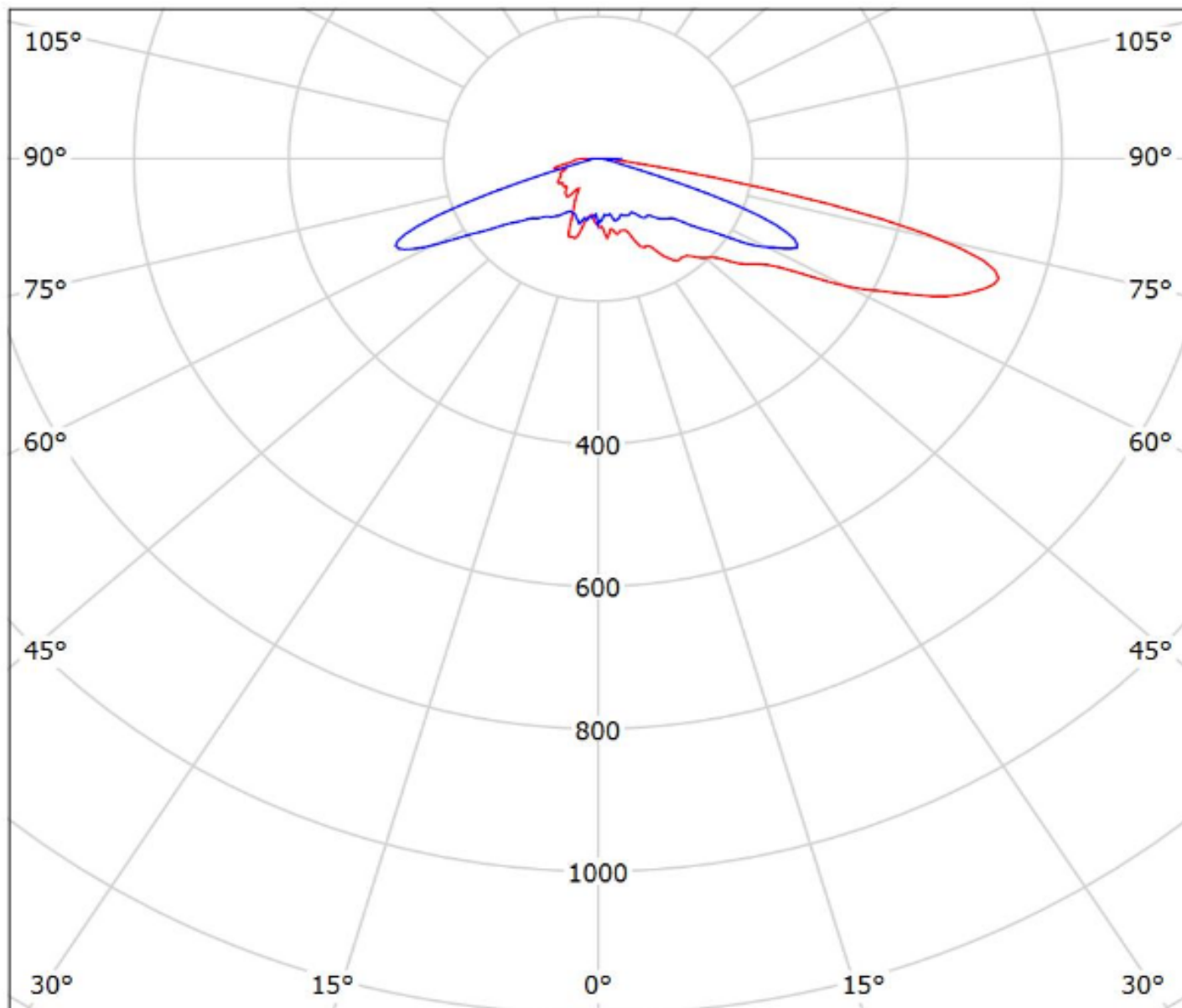

cd/klm

— C0 - C180 — C90 - C270

$\eta = 91\%$

Luminaire: Ledil Oy C15014_STRADA-2X2-T4-B_simulated_XP-L

Lamps: 1 x Cree XP-L

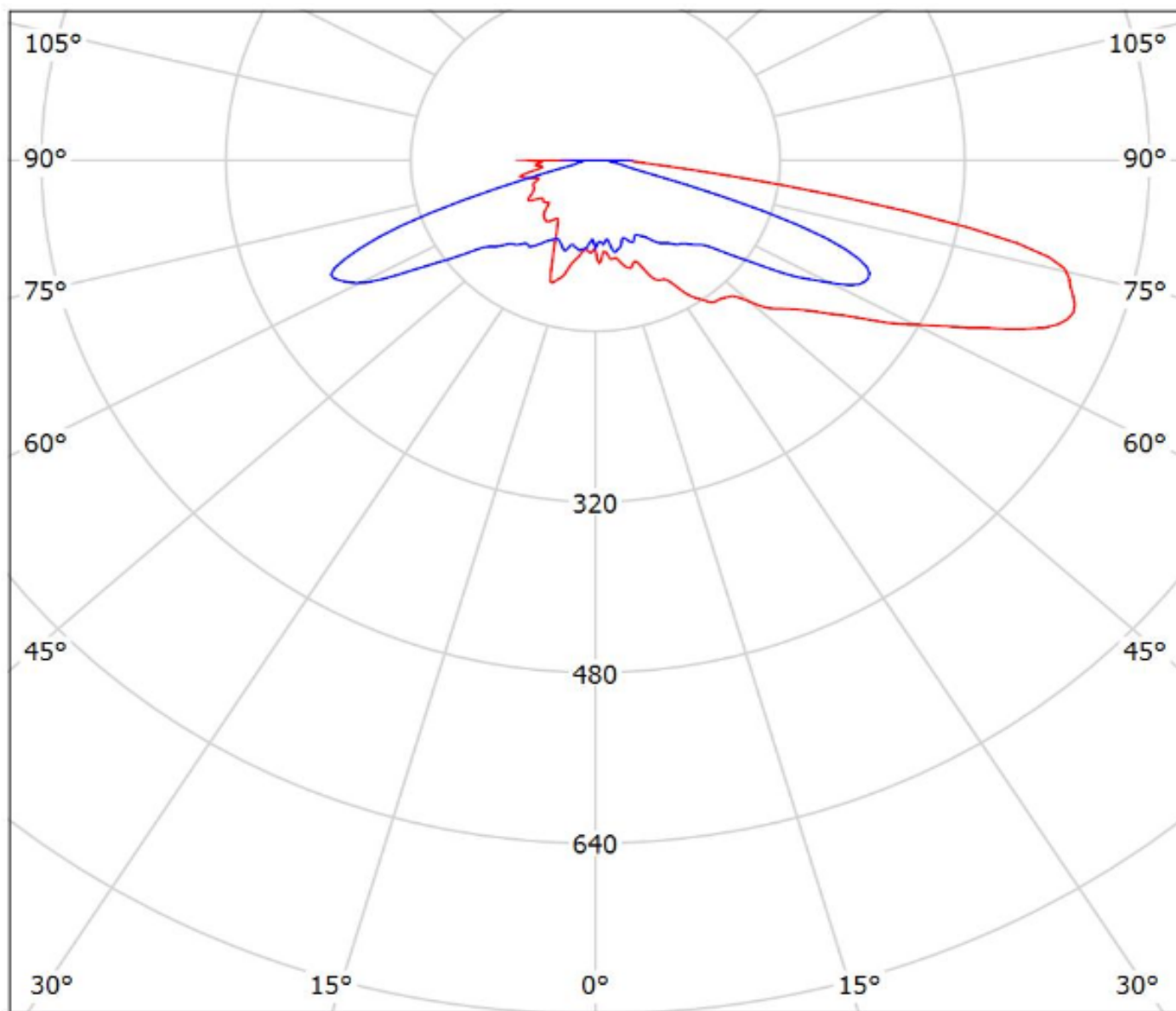

cd/klm

— C0 - C180

— C90 - C270

η = 90%

Luminaire: Ledil Oy C15014_STRADA-2X2-T4-B_simulated_XP-L HI

Lamps: 1 x Cree XP-L HI

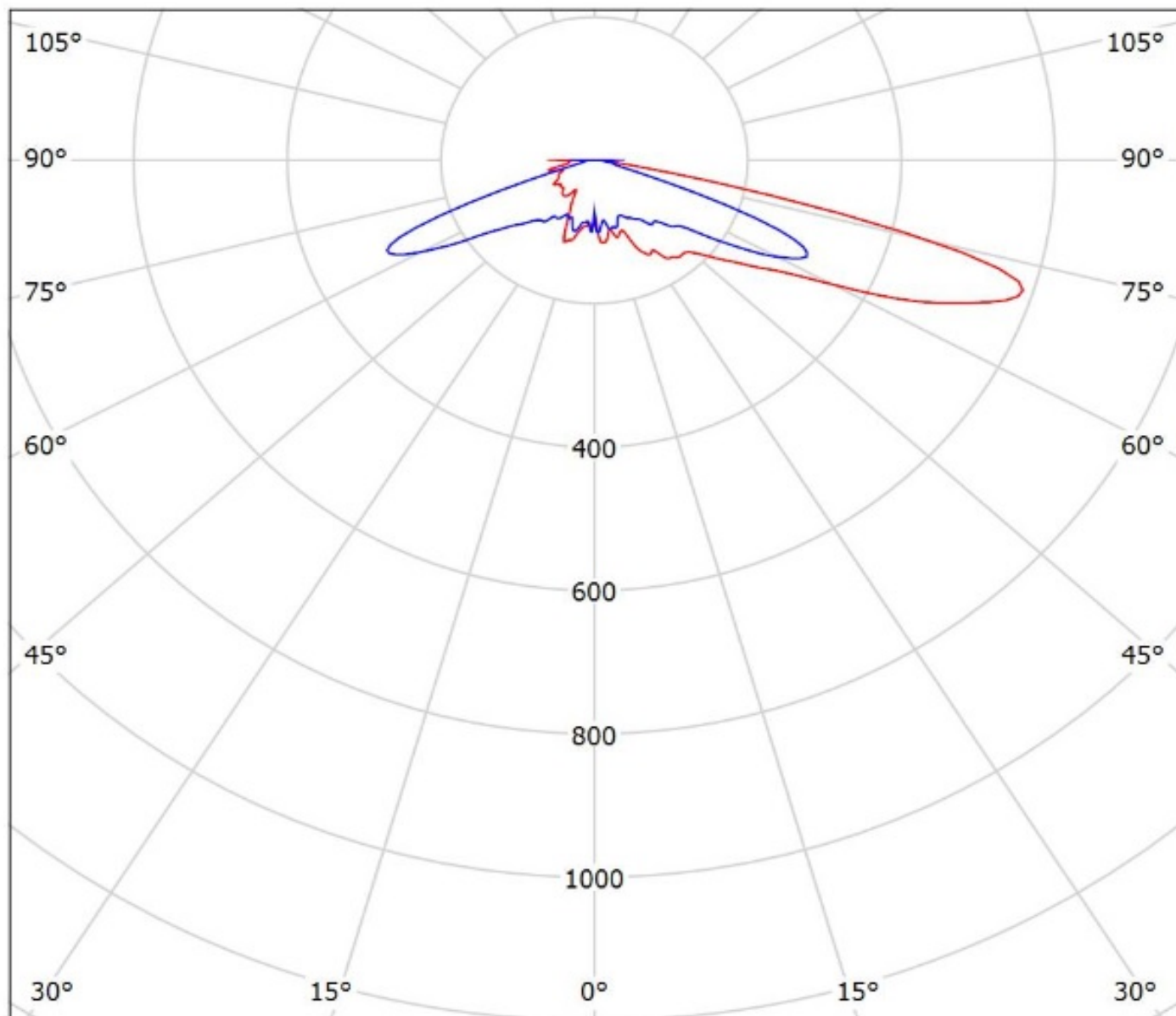

cd/klm

— C0 - C180 — C90 - C270

$\eta = 92\%$

Luminaire: Ledil Oy C15014_STRADA-2X2-T4-B_simulated_XM-L
Lamps: 1 x Cree XM-L

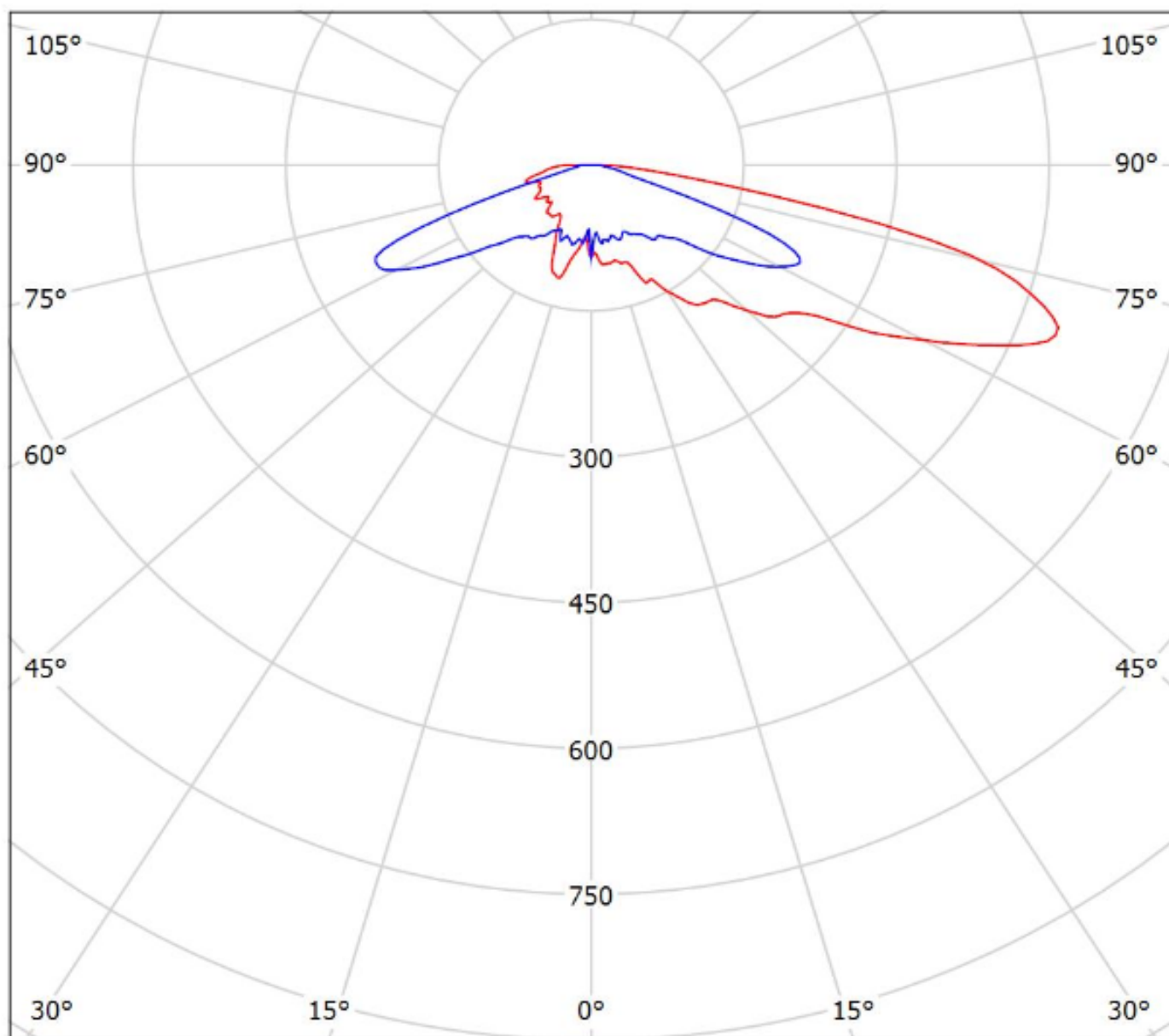

cd/klm

— C0 - C180 — C90 - C270

$\eta = 90\%$

Luminaire: Ledil C15014_STRADA-2X2-T4-B_(XP-L2)

Lamps: 1 x Cree_XP-L2_2x2_(XPLBWT-00-0000-000BV50E3)550.93lm@250mA_P=2.7815W_I=0.25A

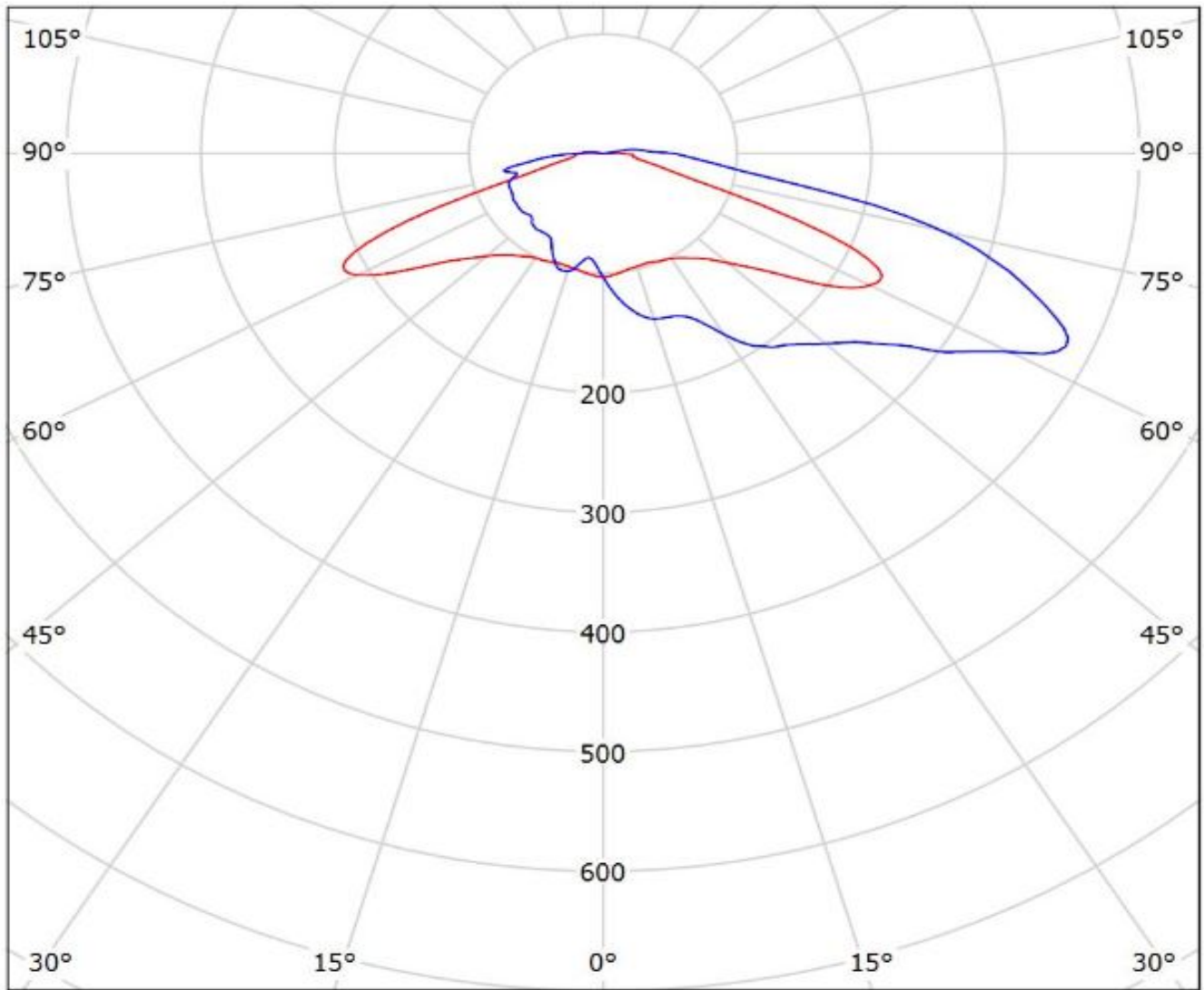

cd/klm

— C0 - C180

— C90 - C270

η = 95%

Luminaire: Ledil C15014_STRADA-2X2-T4-B_(LUXEON_TX)

Lamps: 1 x LUXEON_TX_2x2_(L1T2-3585)_330.32lm@250mA_P=2.8W_I=0.25A

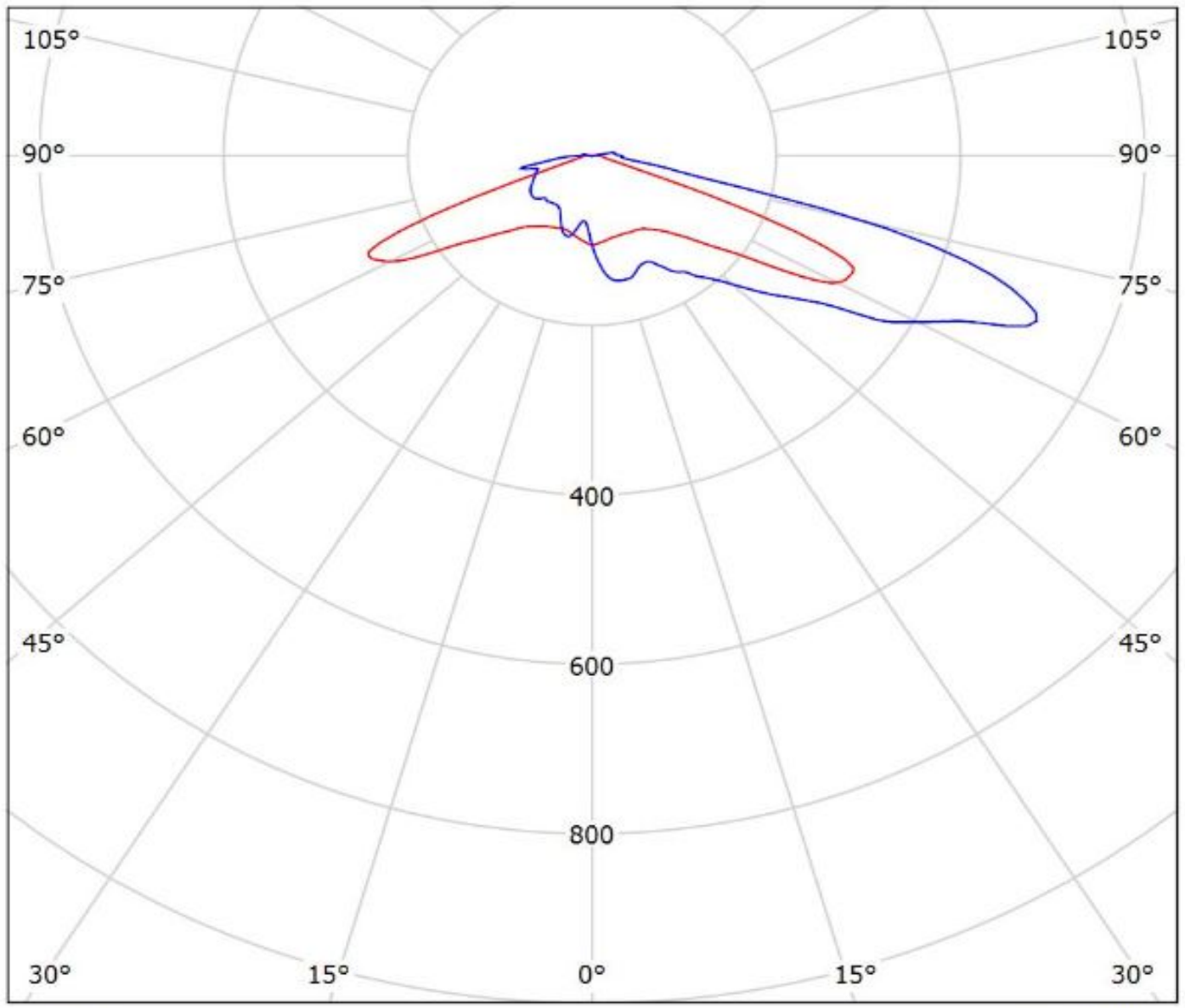

cd/klm

— C0 - C180 — C90 - C270

$\eta = 94\%$

Luminaire: LEDiL Oy C15014_STRADA-2X2-T4-B_(Luxeon_5050)

Lamps: 1 x Luxeon_5050_2x2_1251.02lm@80mA_CCT=5700K_P=7.27443W_I=0.080A_70CRI

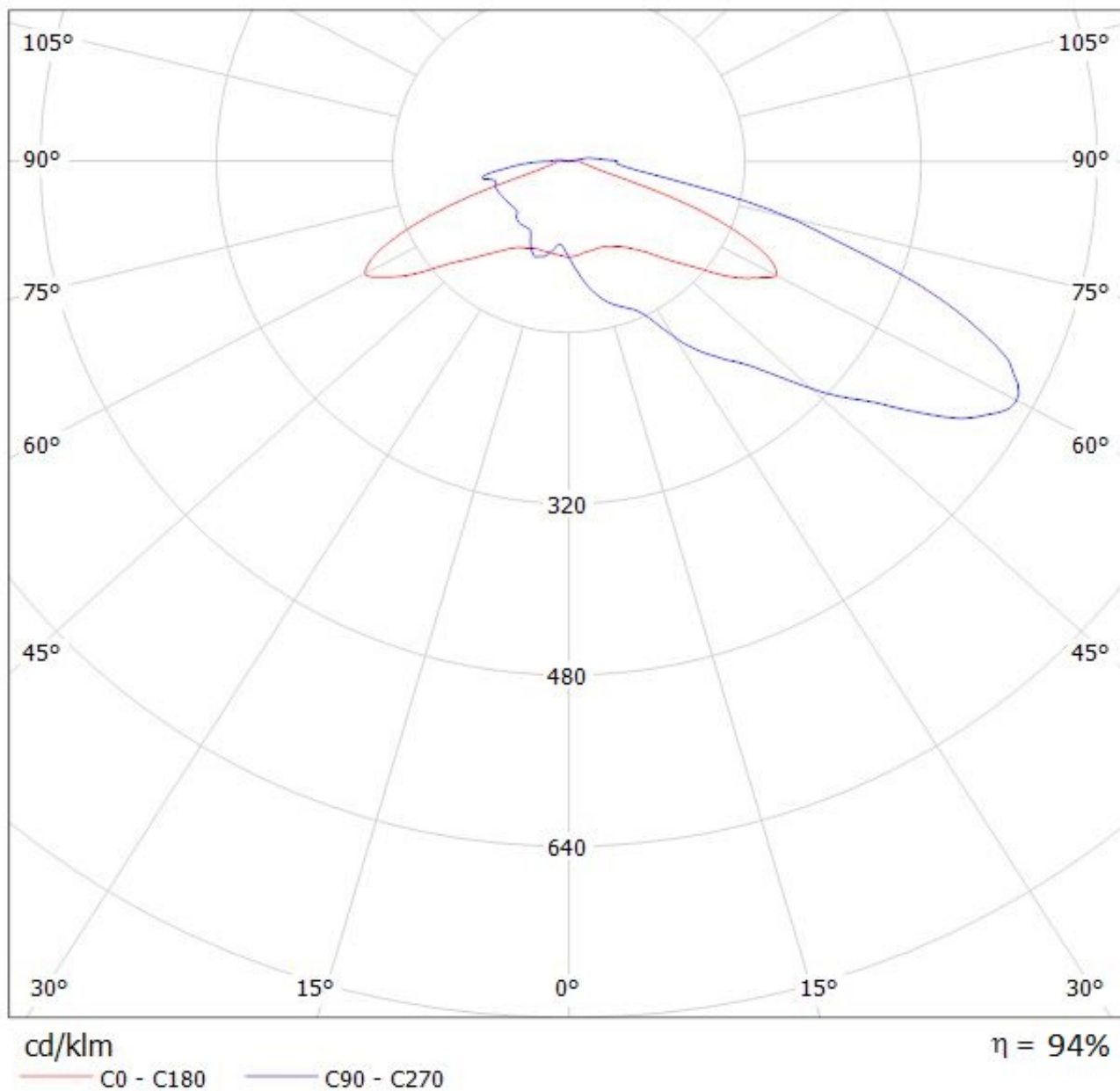

Luminaire: Ledil Oy C15014_STRADA-2X2-T4-B_simulated_NCSW219B
Lamps: 1 x Nichia NCSW219B

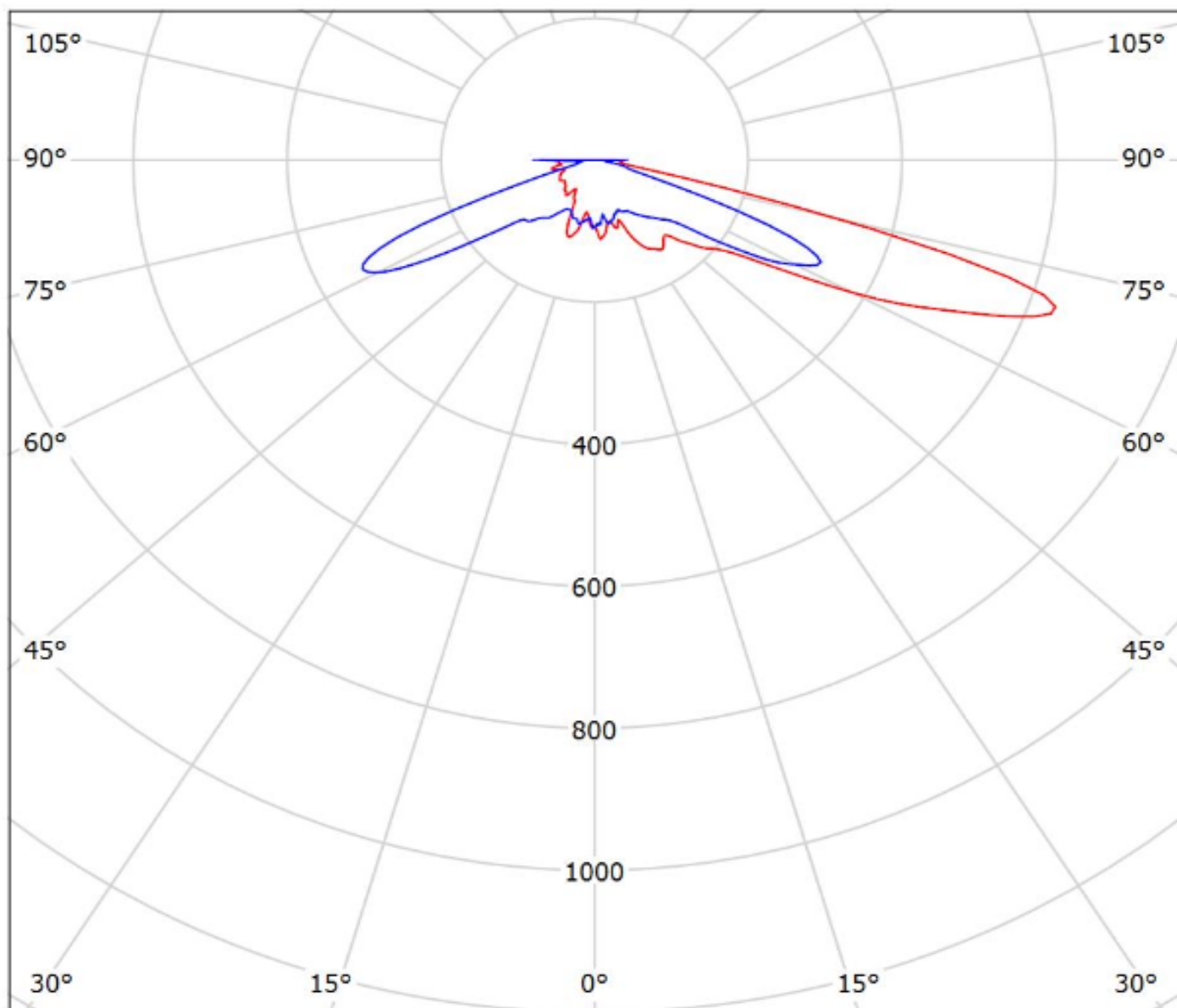

cd/klm
— C0 - C180 — C90 - C270

$\eta = 91\%$

Luminaire: Ledil Oy C15014_STRADA-2X2-T4-B_simulated_NVSW219B

Lamps: 1 x Nichia NVSW219B

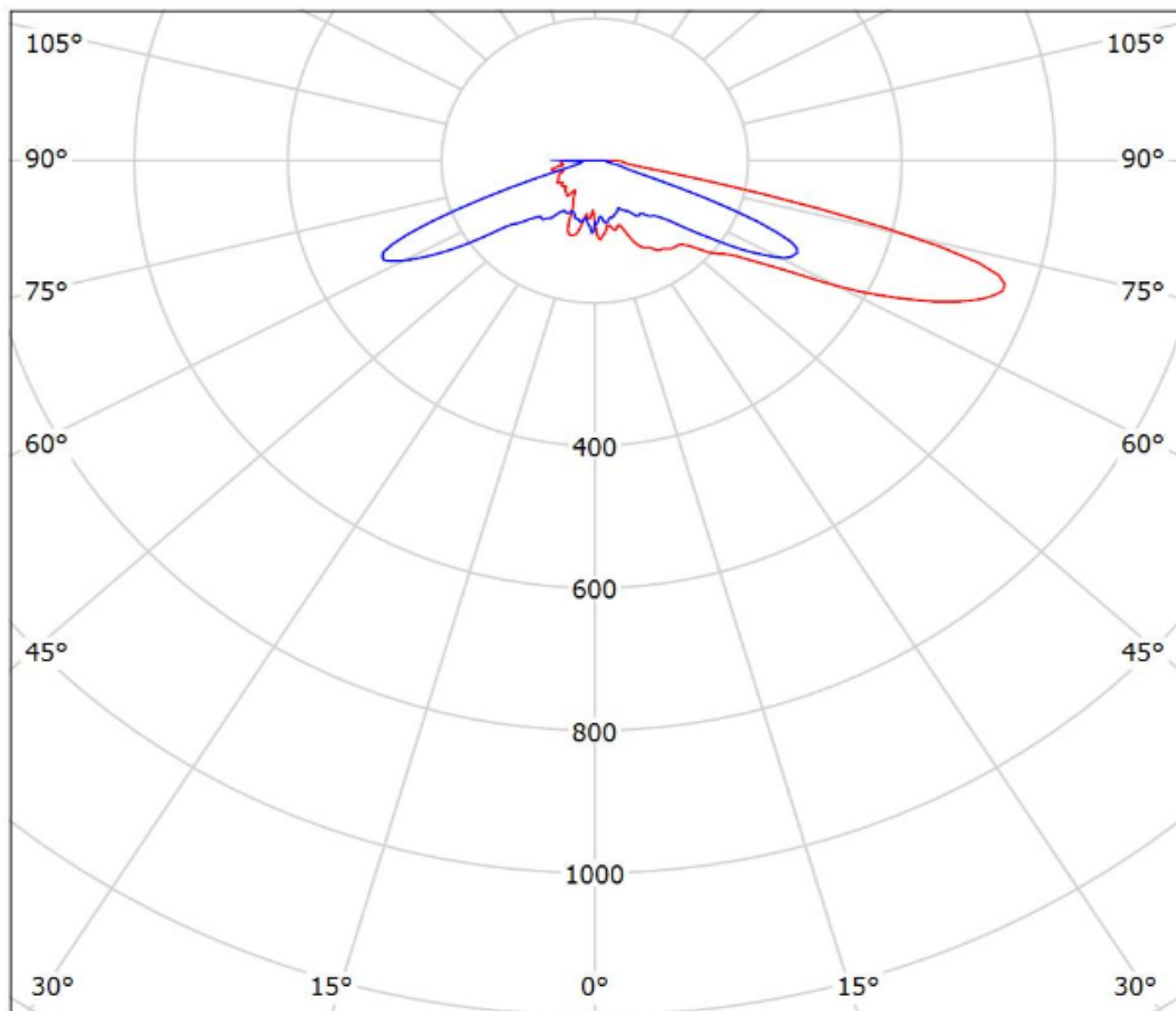

cd/klm

— C0 - C180 — C90 - C270

$\eta = 91\%$

Luminaire: Ledil C15014_STRADA-2X2-T4-B_(NVSW319AE)
Lamps: 1 x Nichia_NVSW319AE_(sm405D440f2L2R70)

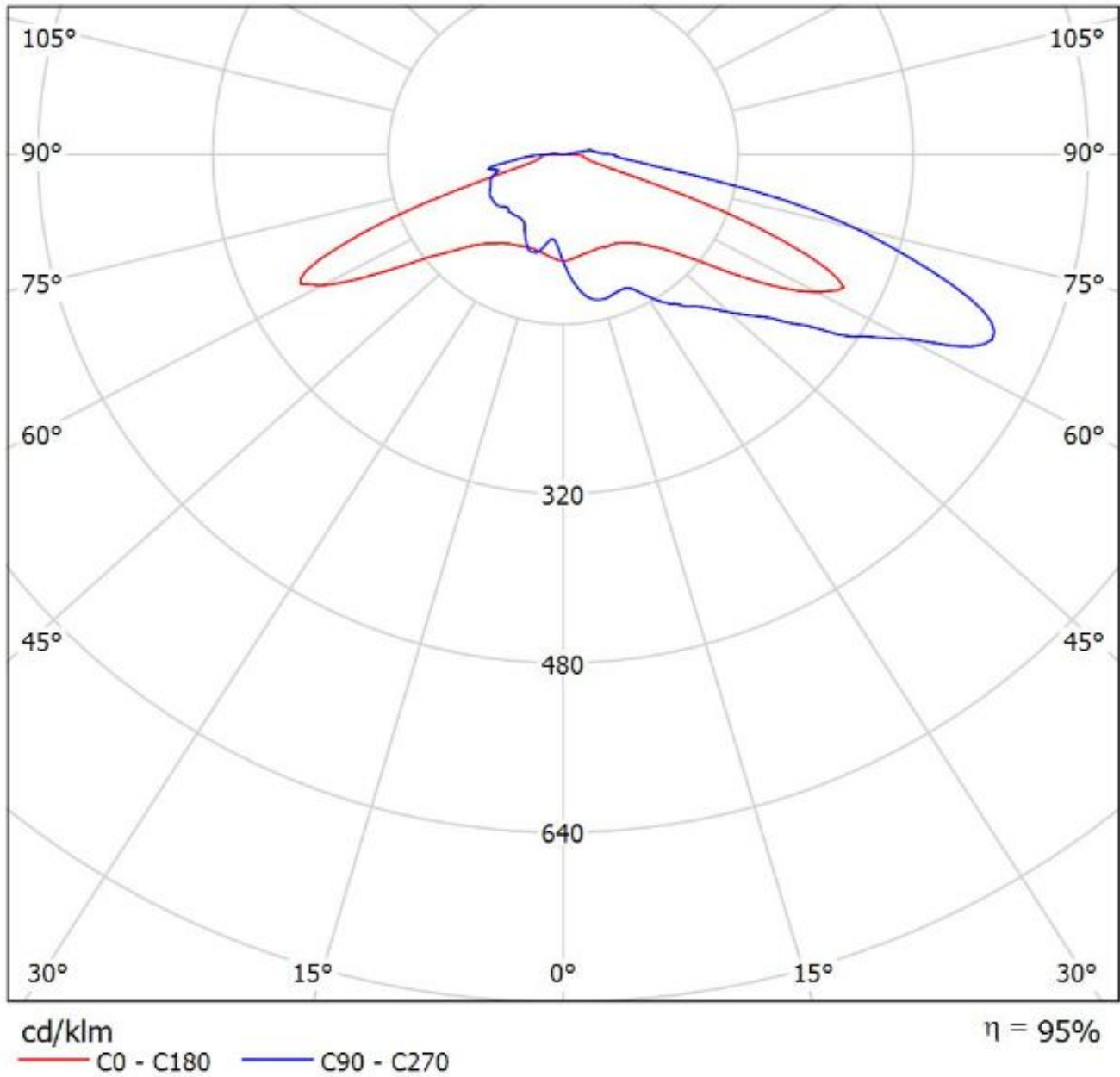

Luminaire: LEDiL Oy C15014_STRADA-2X2-T4-B_(E21A)
Lamps: 1 x Nichia_E21A_452.248lm@250mA_2.805W_I=0.250A

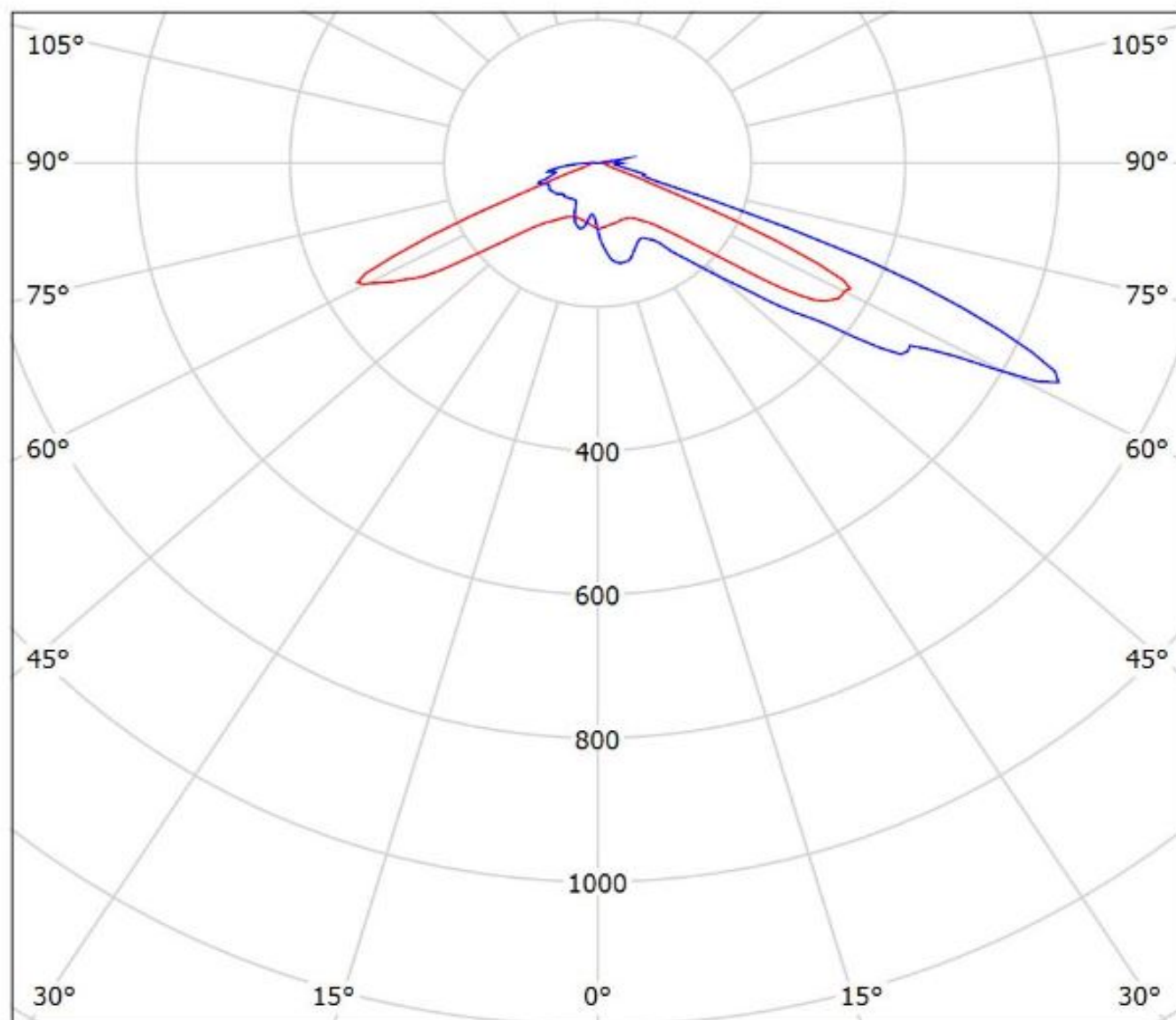

cd/klm
— C0 - C180 — C90 - C270

$\eta = 95\%$

Luminaire: Ledil Oy C15014_STRADA-2X2-T4-B_(NWSx229A)_SIMULATED
Lamps: 1 x Nichi NWSW229A

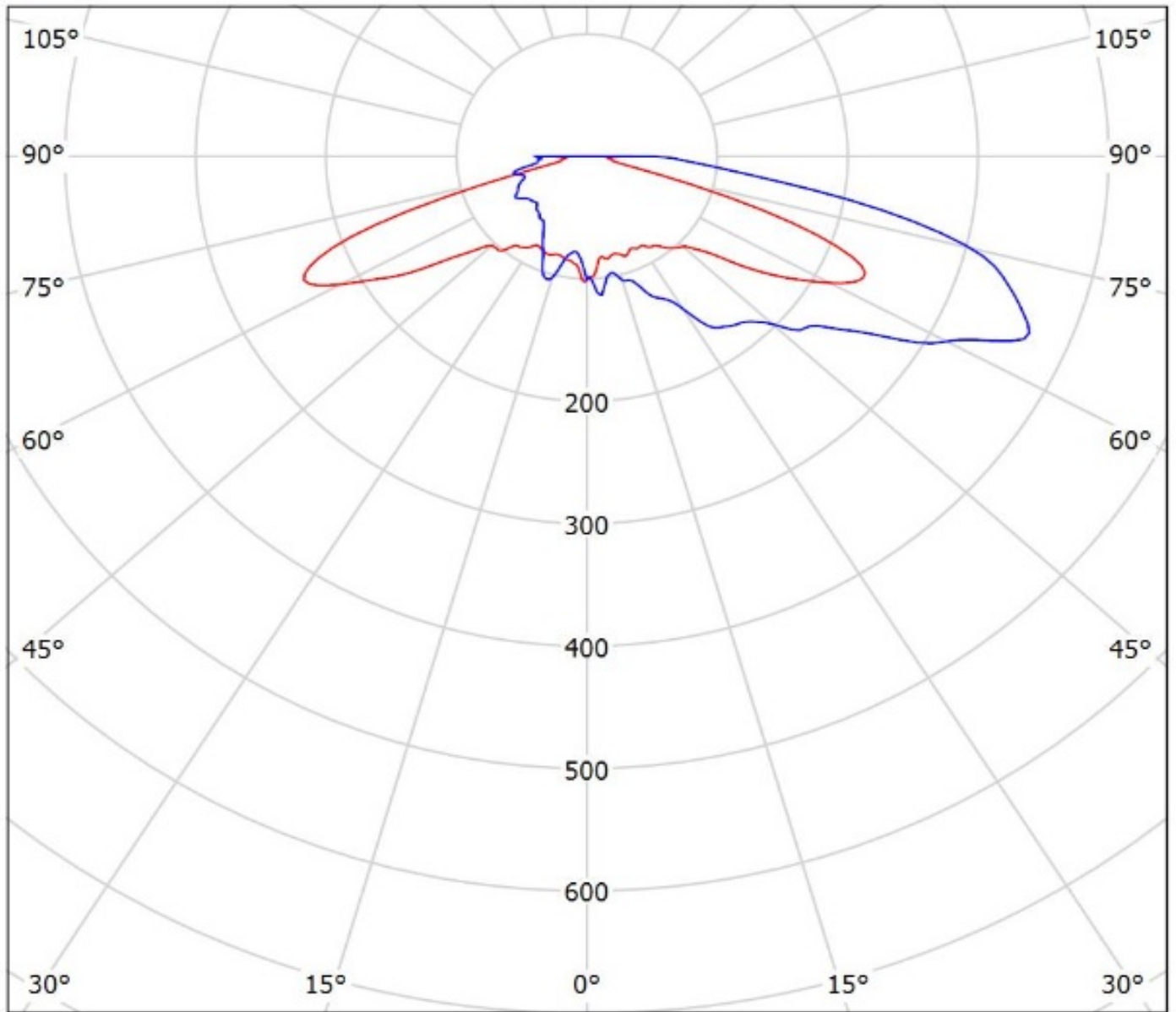

cd/klm

— C0 - C180 — C90 - C270

$\eta = 87\%$

Luminaire: Ledil Oy C15014_STRADA-2X2-T4-B_simulated_OslonSQG3
Lamps: 1 x Osram Oslon SQ G3

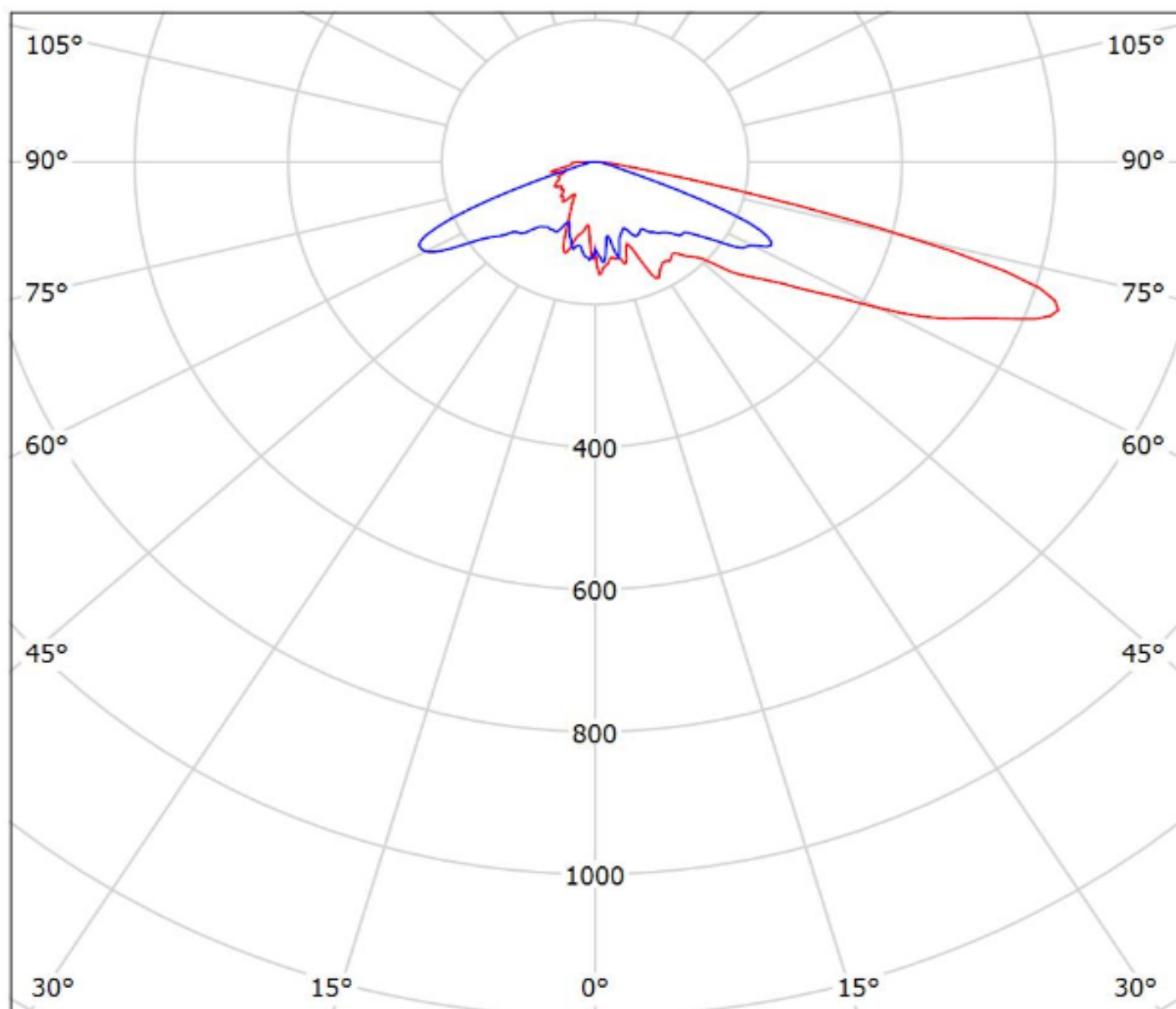

cd/klm

— C0 - C180 — C90 - C270

$\eta = 92\%$

Luminaire: Ledil Oy C15014_STRADA-2X2-T4-B_simulated_OsISQPC
Lamps: 1 x Osram Oslon S \bar{Q} PC

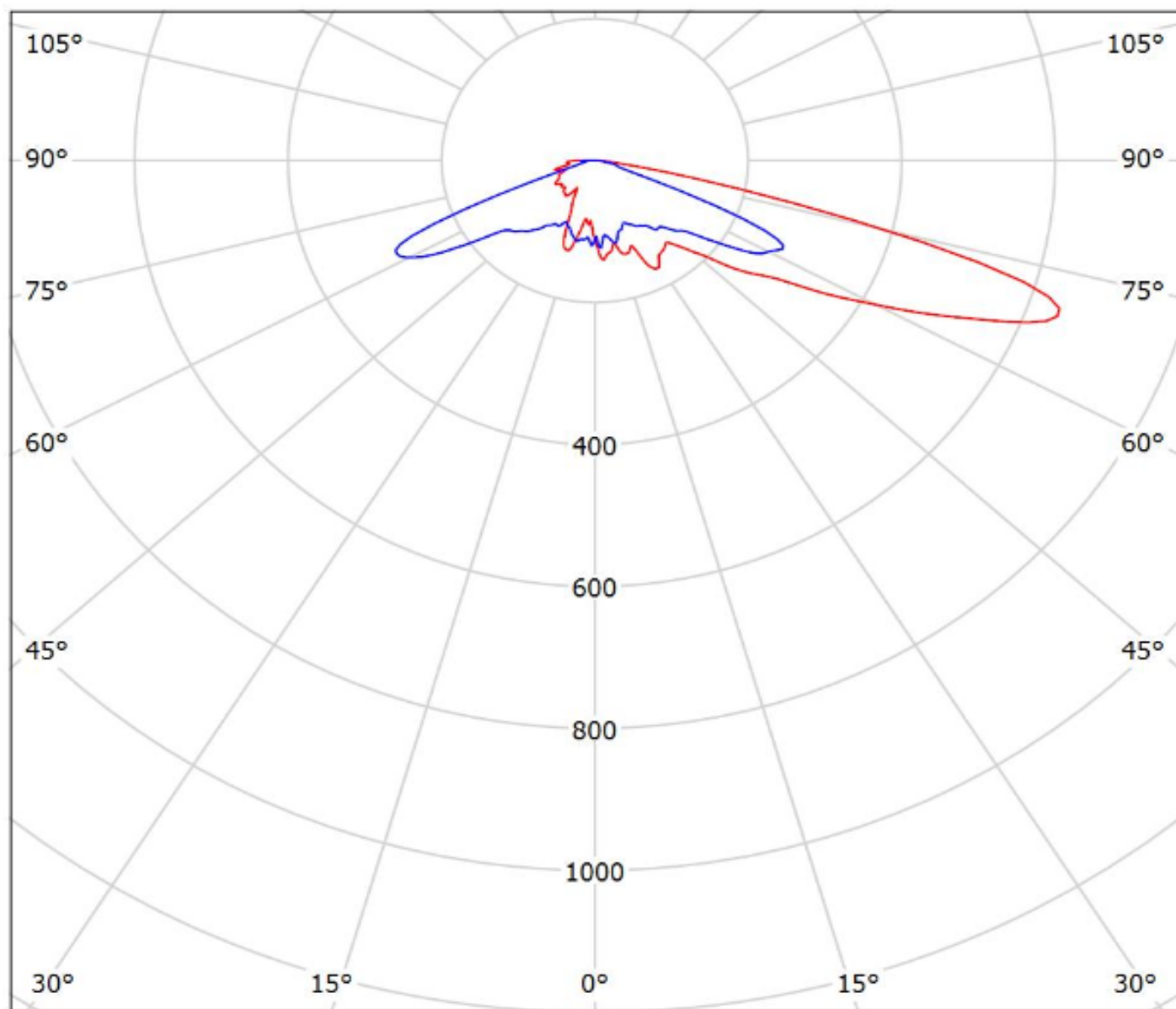

cd/klm

— C0 - C180 — C90 - C270

$\eta = 92\%$

Luminaire: Ledil Oy C15014_STRADA-2X2-T4-B_simulated_DurisS8
Lamps: 1 x Osram Duris S8

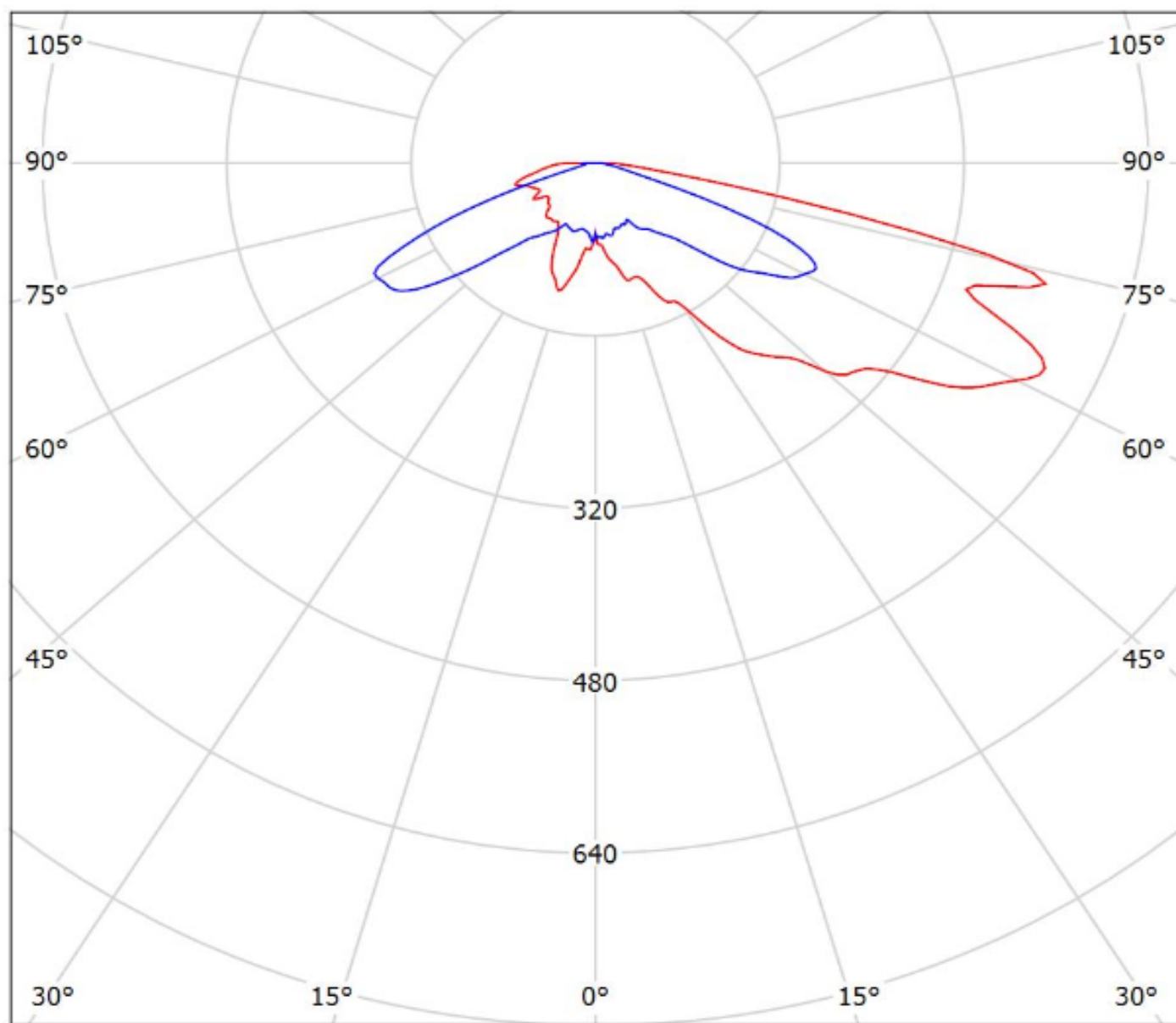

cd/klm

— C0 - C180 — C90 - C270

$\eta = 92\%$

Luminaire: Ledil Oy C15014_STRADA-2X2-T4-B_OSRAM_DURIS_P9_SIMULATED
Lamps: 1 x OSRAM DURIS P9

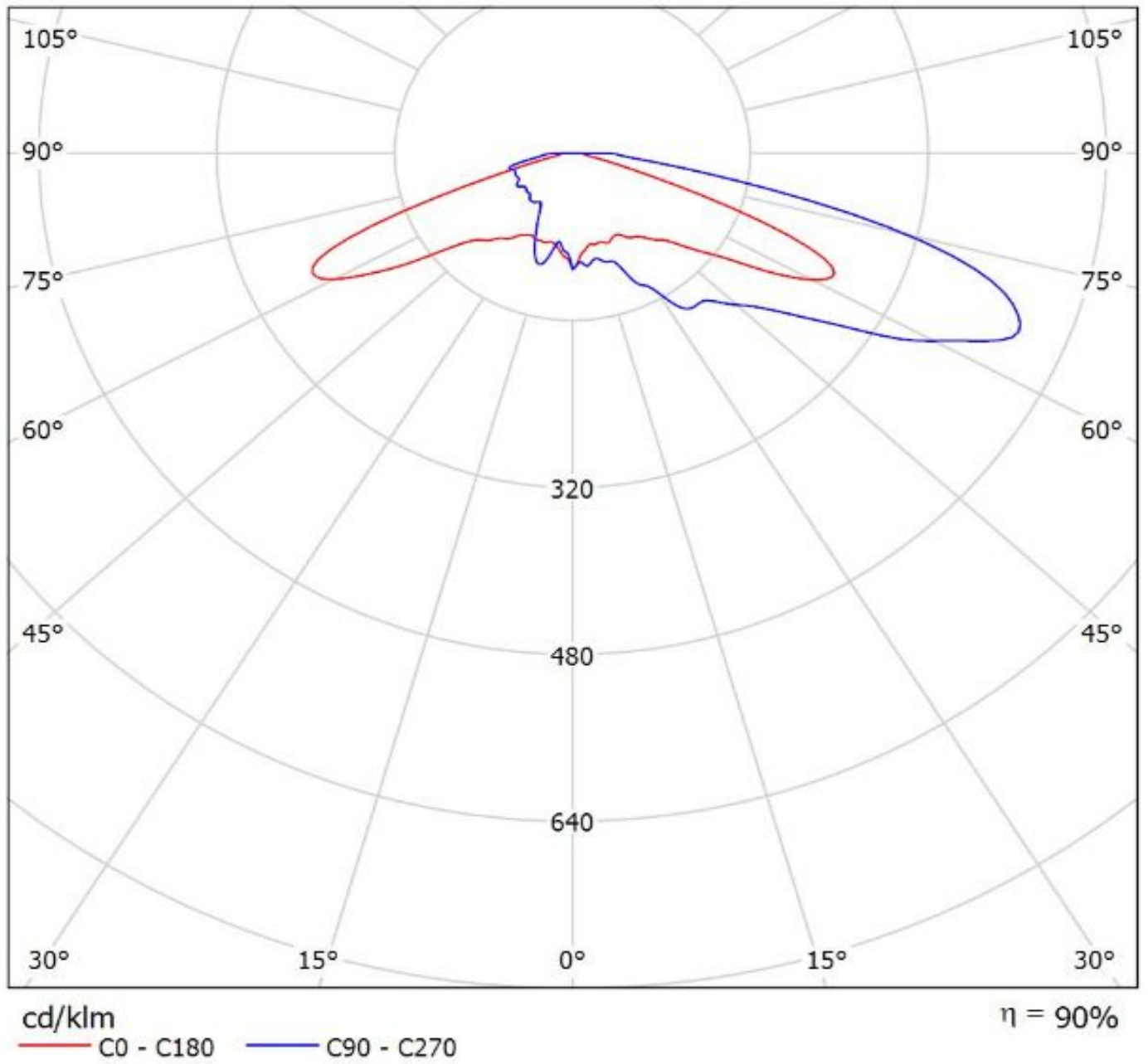

Luminaire: Ledil Oy C15014_STRADA-2X2-T4-B_Fortimo FastFlex LED board 2x8 DA G4_SIMULATED
Lamps: 1 x Fortimo FastFlex LED board 2x8 DA G4_SIMULATED

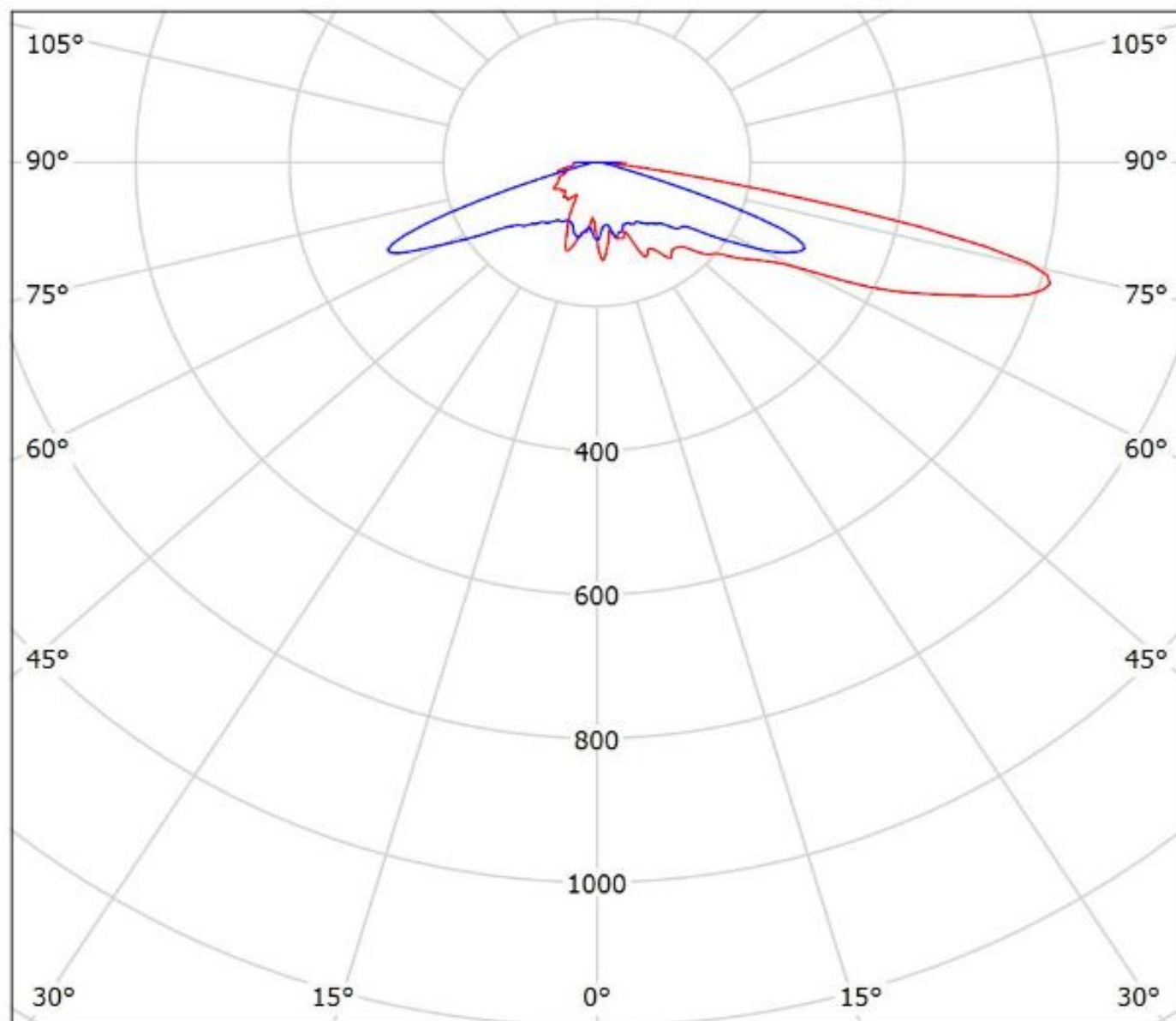

cd/klm

— C0 - C180 — C90 - C270

η = 91%

Luminaire: Ledil Oy C15014_STRADA-2X2-T4-B_Fortimo FastFlex LED board 2x8 DAX G4_SIMULATED
Lamps: 1 x Fortimo FastFlex LED board 2x8 DAX G4_SIMULATED

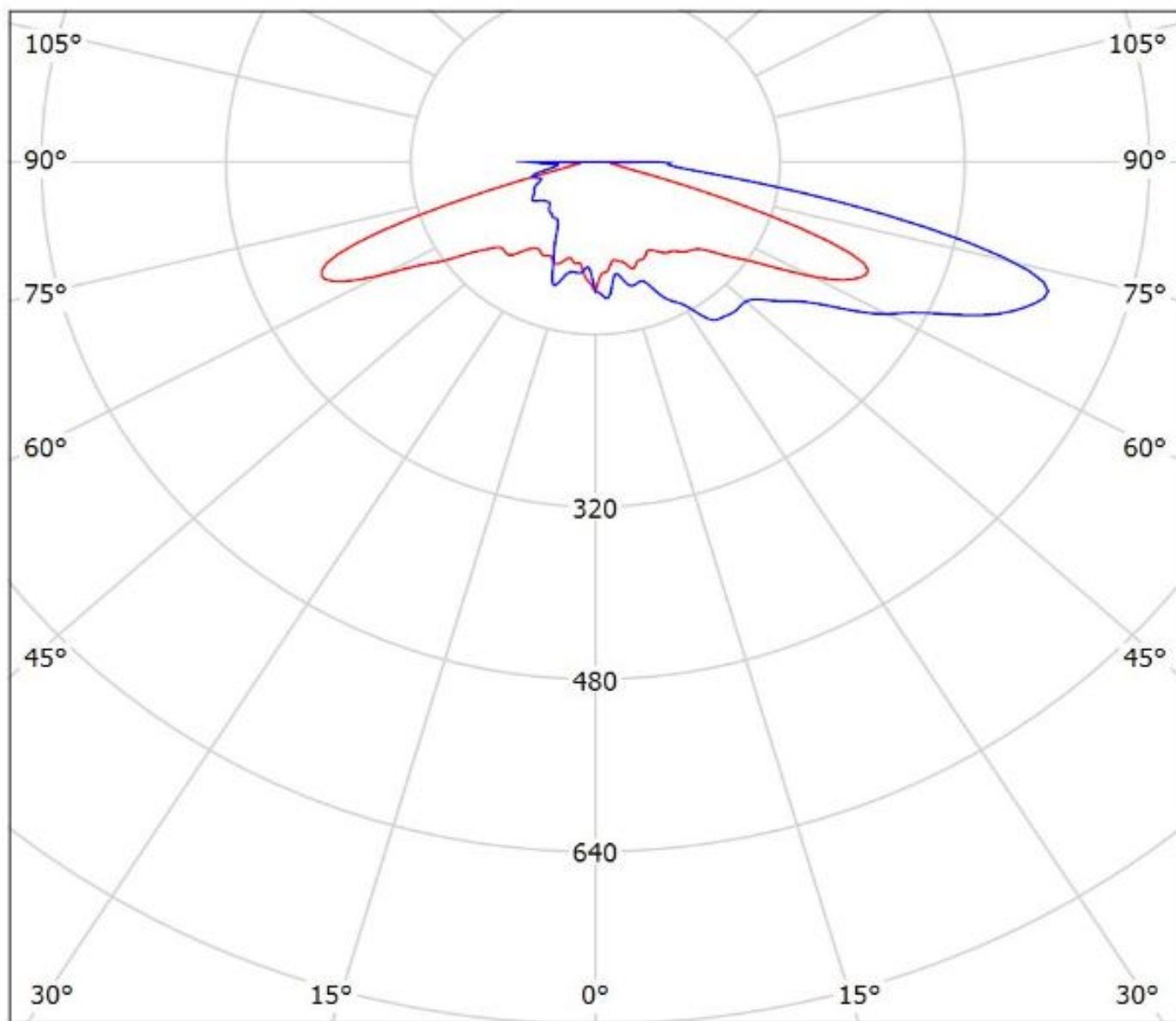

cd/klm

— C0 - C180 — C90 - C270

$\eta = 88\%$

Luminaire: LEDiL Oy C15014_STRADA-2X2-T4-B_(LH351D)
Lamps: 1 x Samsung_LH351D_524.264lm@250mA_P=2.7523W_I=0.250A

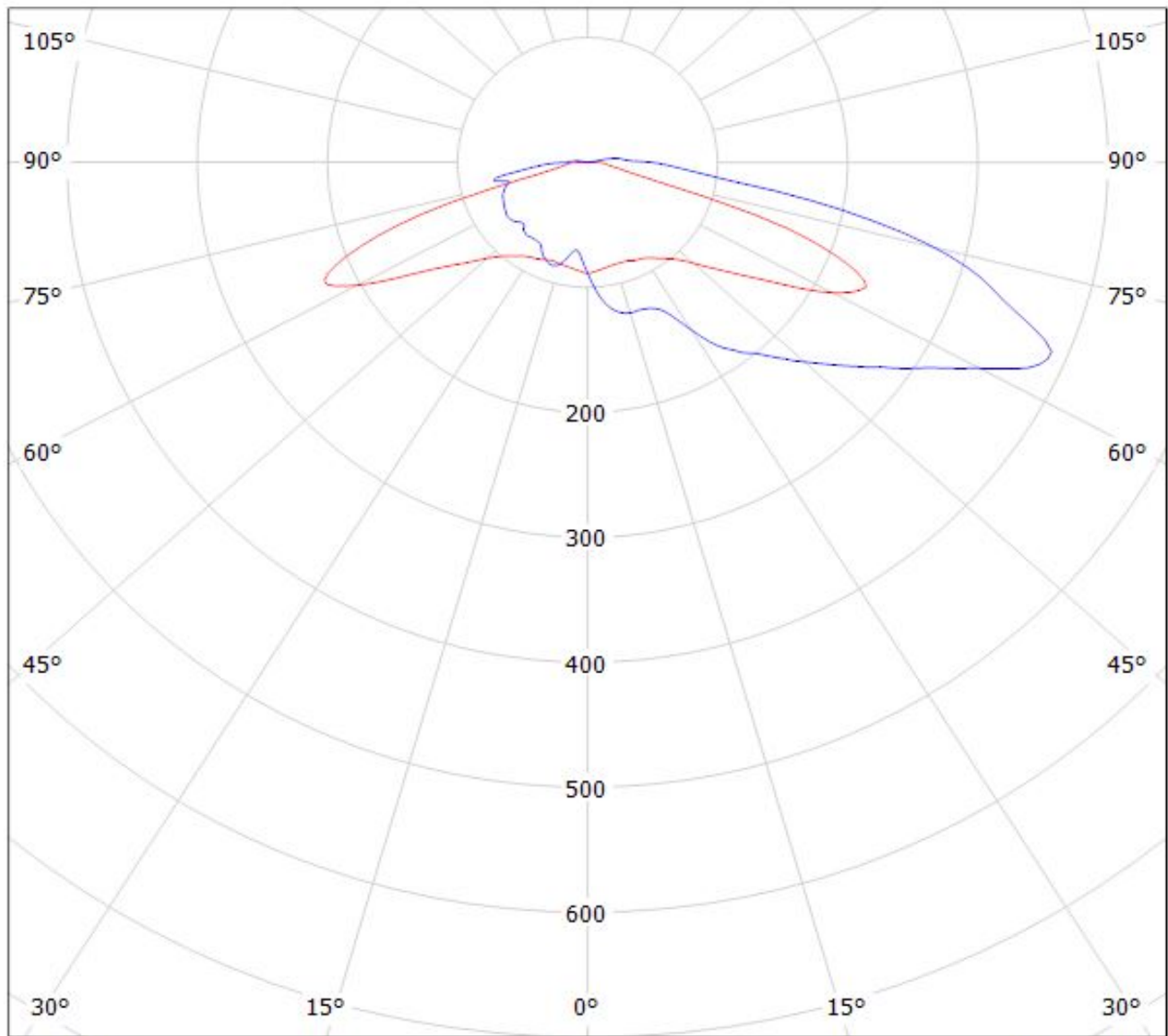

cd/klm

— C0 - C180

— C90 - C270

$\eta = 92\%$

Luminaire: Ledil C15014_STRADA-2X2-T4-B_(LH351C)

Lamps: 1 x Samsung_LH351C_518.223lm@250mA_P=2.85225W_I=0.25A

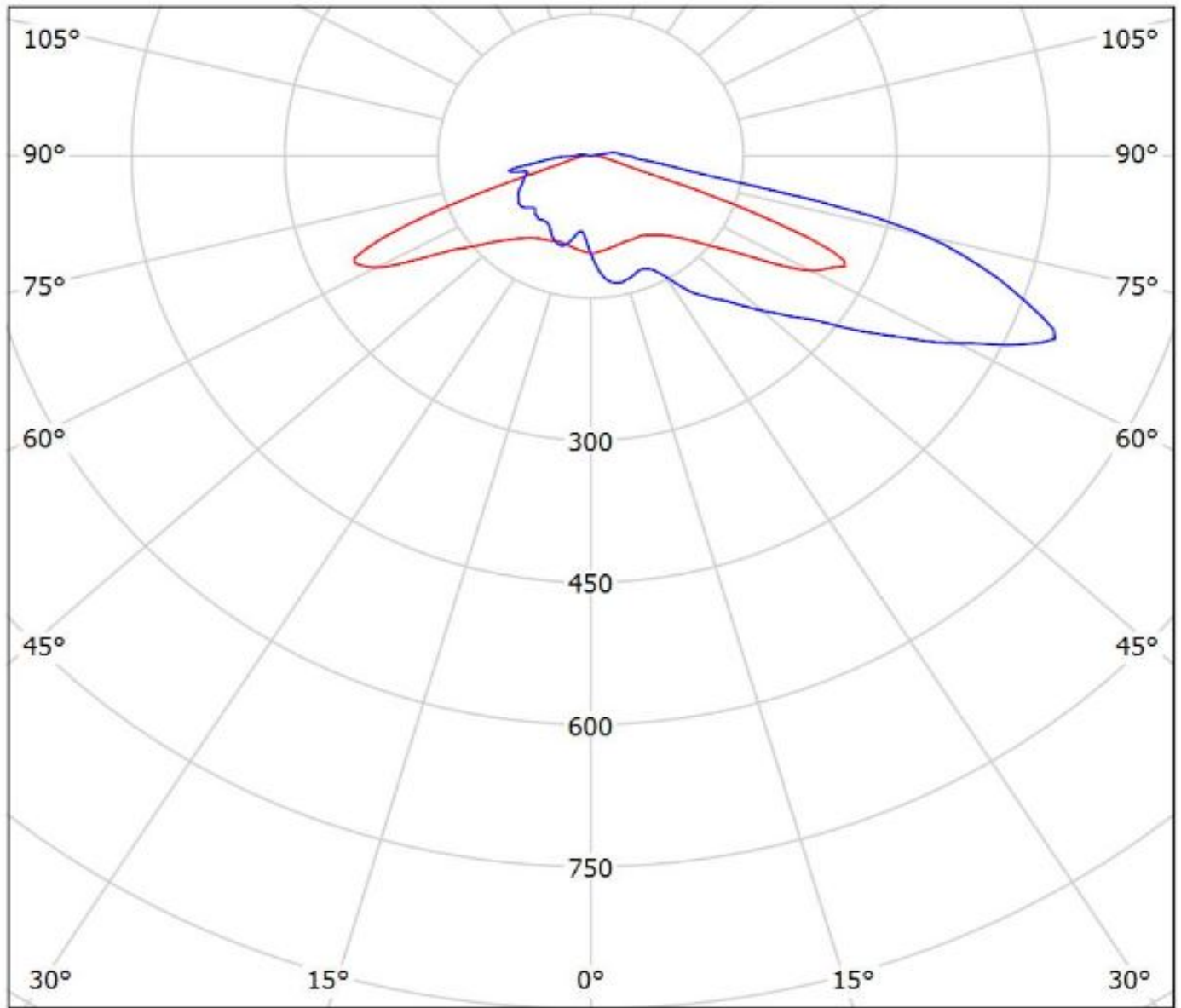

cd/klm

— C0 - C180

— C90 - C270

$\eta = 96\%$

Luminaire: Ledil C15014_STRADA-2X2-T4-B_(LH508A)

Lamps: 1 x Samsung_LH508A_2x2_2060.04lm@160mA_CCT=5000K_CRI=80_P=15.5405W_I=0.16A

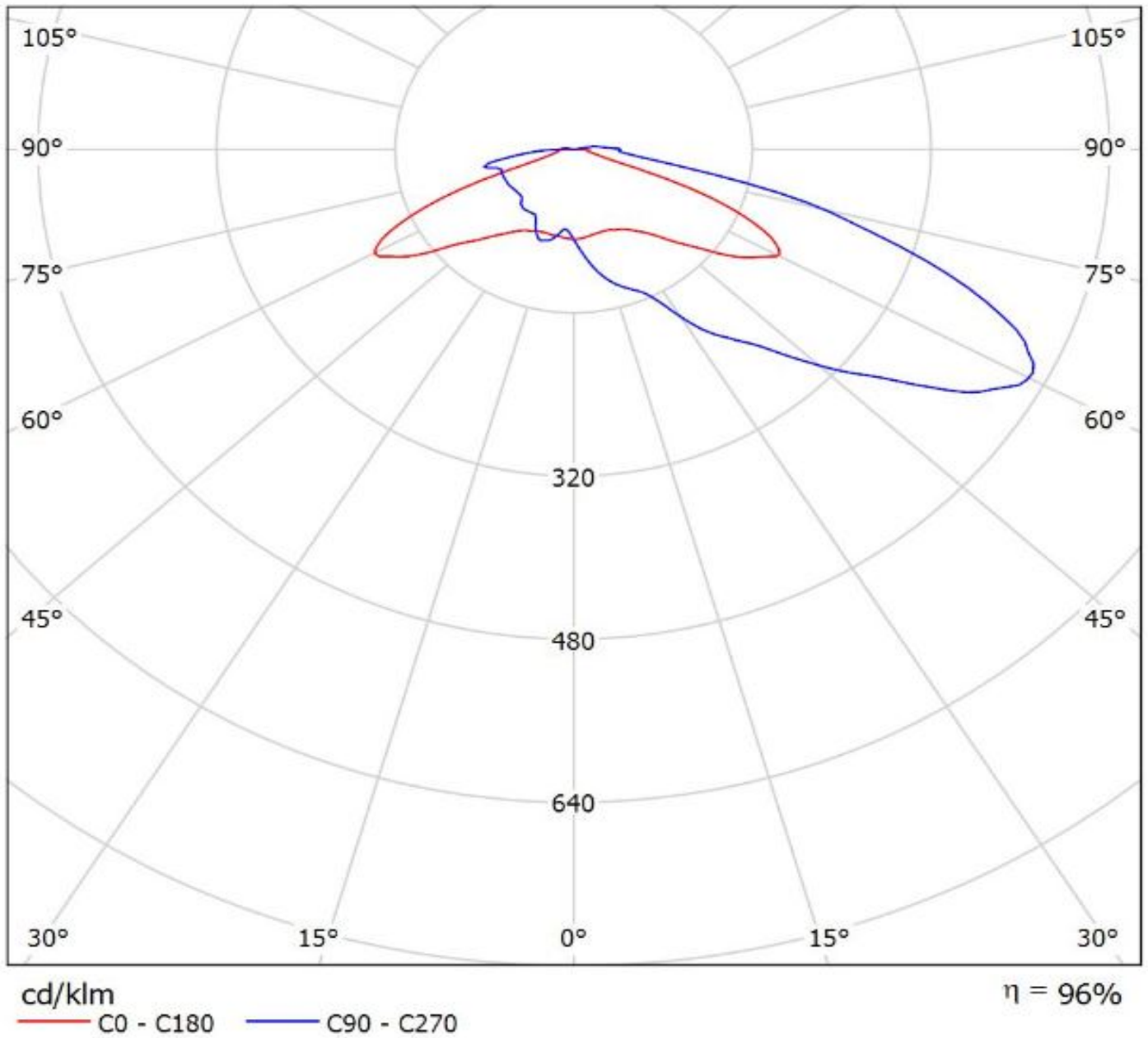

Luminaire: LEDiL Oy C15014_STRADA-2X2-T4-B_(Tridonic_Module_RLE_G1)
Lamps: 1 x Tridonic_Module_RLE_G1_4594.42lm@700mA_P=32.1515W_I=0.700A

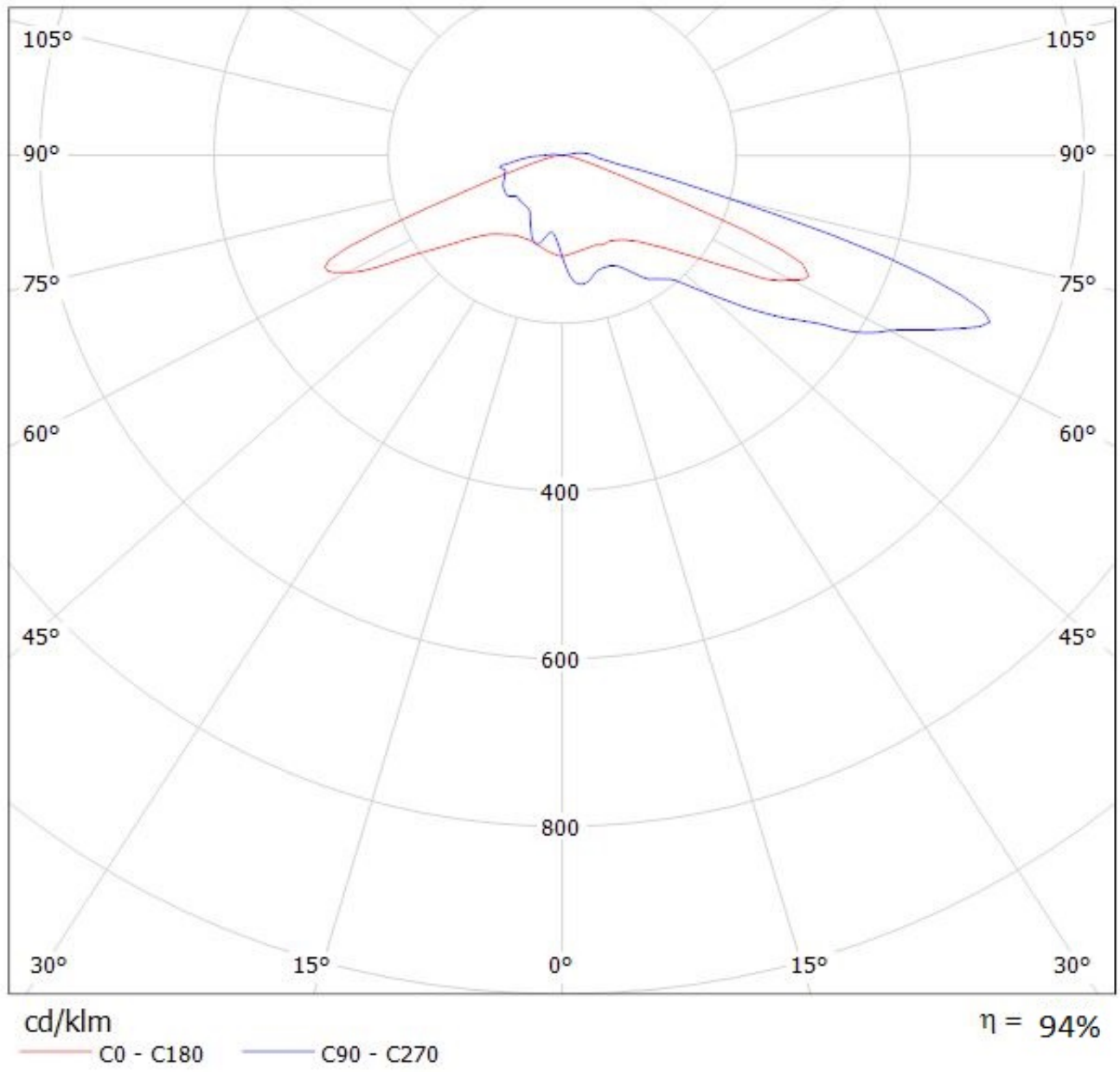

Luminaire: LEDiL Oy C15014_STRADA-2X2-T4-B_(Tridonic_Module_RLE_G1)
Lamps: 1 x Tridonic_Module_RLE_G1_4594.42lm@700mA_P=32.1515W_I=0.700A

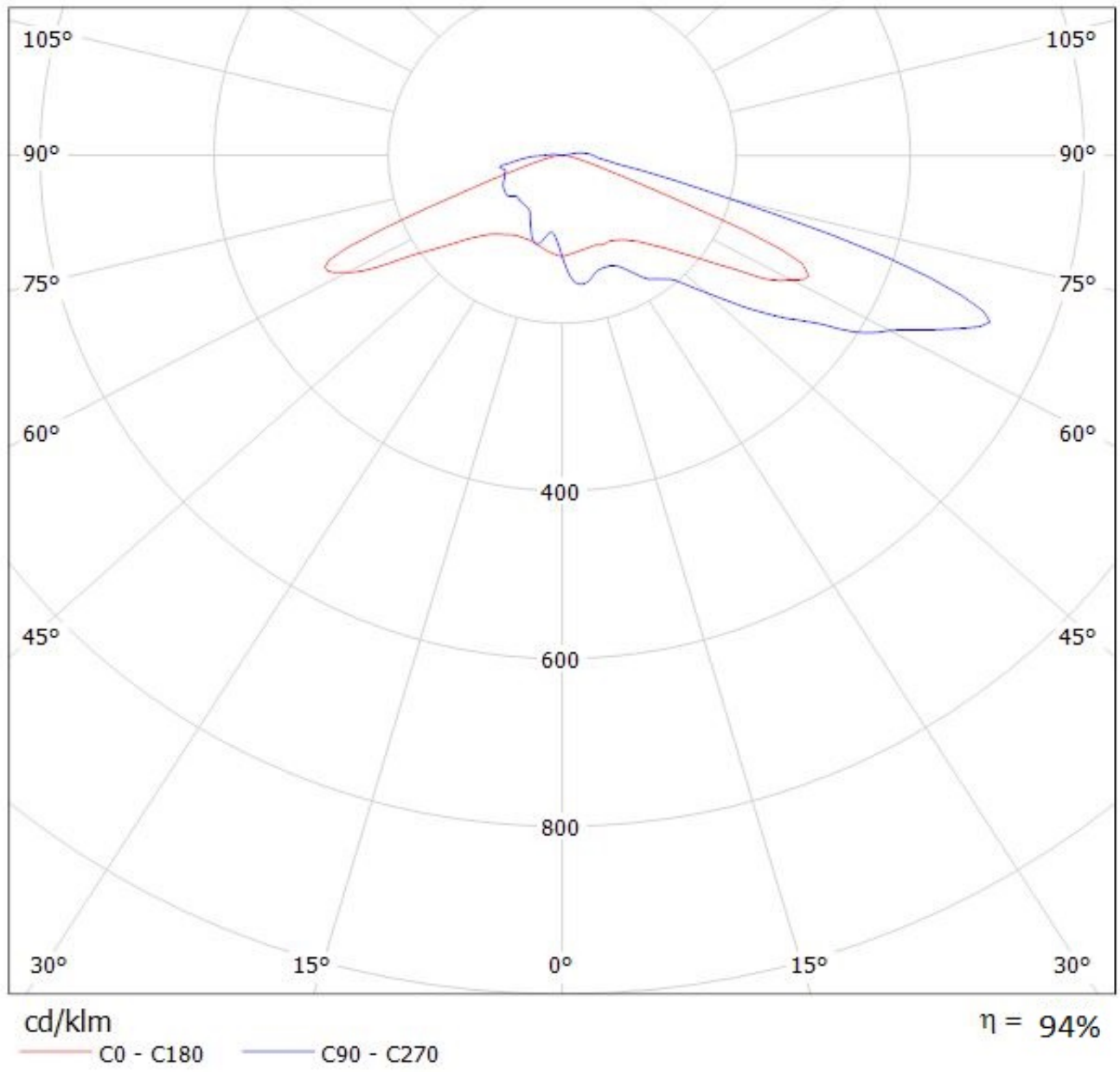

Luminaire: LEDiL Oy C15014_STRADA-2X2-T4-B_(Tridonic_Module_RLE_G1)
Lamps: 1 x Tridonic_Module_RLE_G1_2288lm@700mA_P=16W_I=0.700A

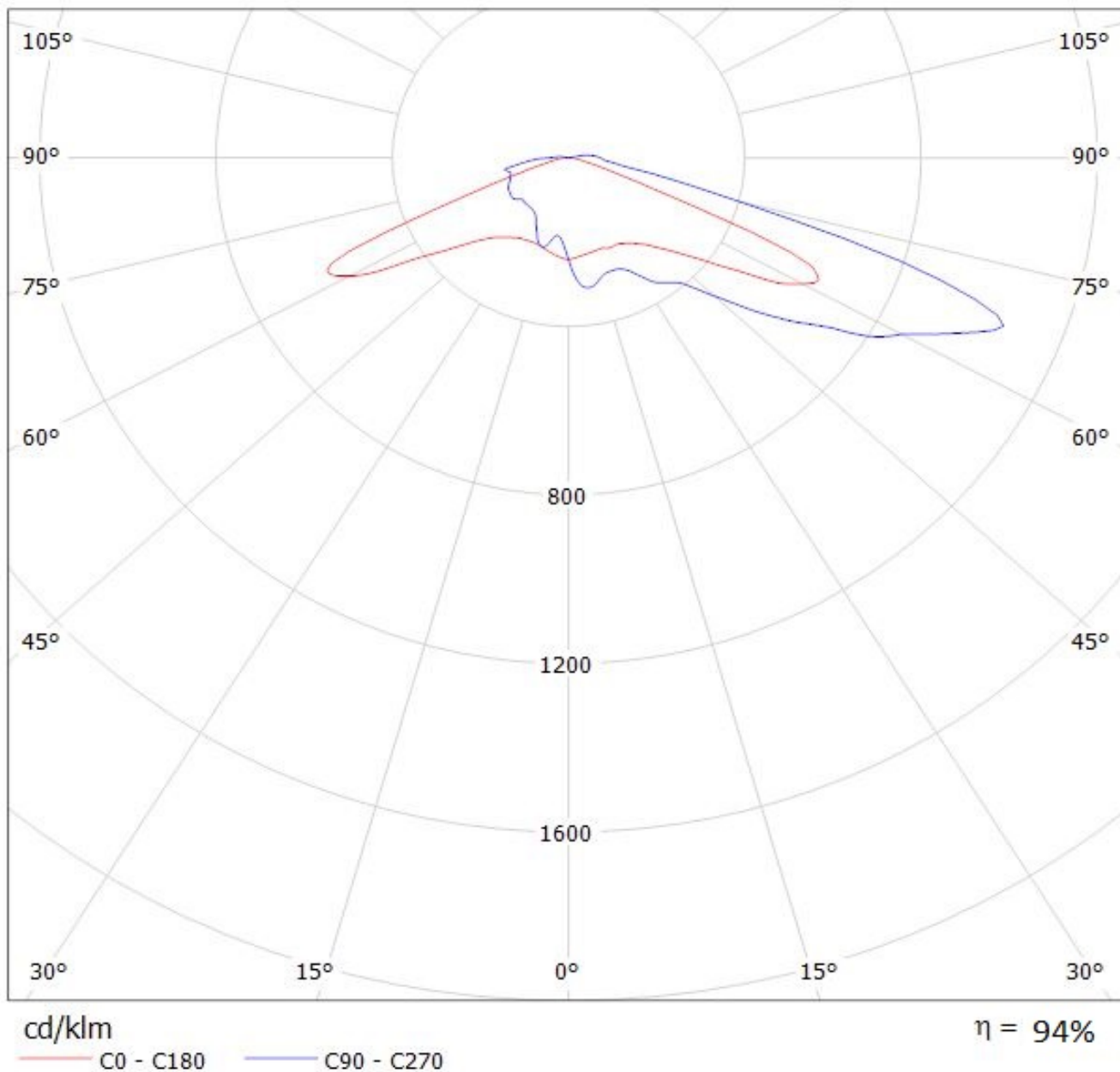

Luminaire: LEDiL Oy C15014_STRADA-2X2-T4-B_(Tridonic_Module_RLE_G1)
Lamps: 1 x Tridonic_Module_RLE_G1_2288lm@700mA_P=16W_I=0.700A

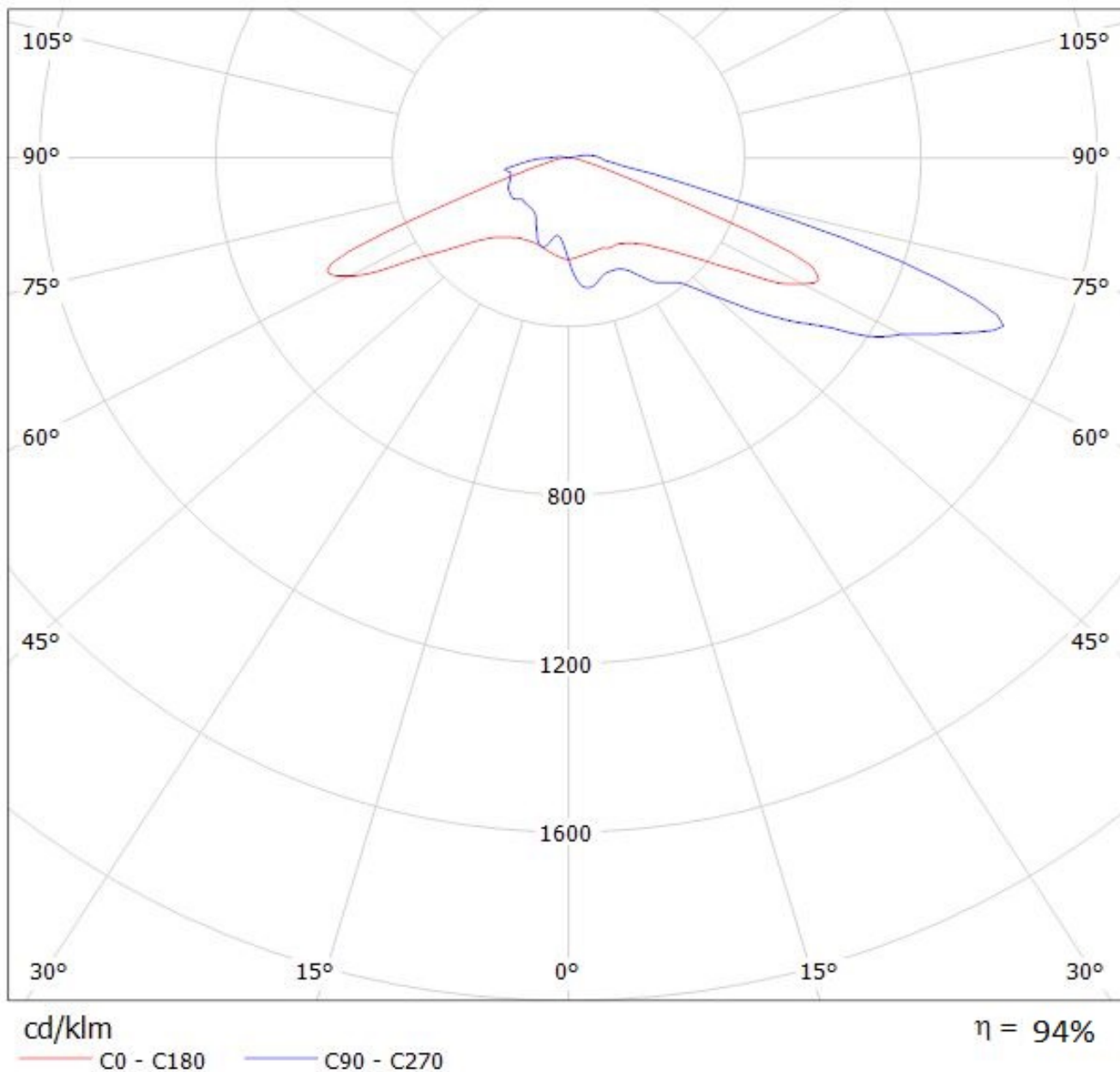

NOTE: The typical divergence will be changed by different color, chip size and chip position tolerance. The typical total divergence is the full angle measured where the luminous intensity is half of the peak value.