



# FLA-MSTR00002

Flexi Loop

SAFE SERIES CONNECTION

**SICK**  
Sensor Intelligence.



### Ordering information

Type	Part no.
FLA-MSTR00002	1067650

Other models and accessories → [www.sick.com/Flexi\\_Loop](http://www.sick.com/Flexi_Loop)



### Detailed technical data

#### Interfaces

IO-Link	✓
---------	---

#### Classifications

<b>ECl@ss 5.0</b>	27371990
<b>ECl@ss 5.1.4</b>	27371990
<b>ECl@ss 6.0</b>	27371819
<b>ECl@ss 6.2</b>	27371819
<b>ECl@ss 7.0</b>	27371819
<b>ECl@ss 8.0</b>	27371819
<b>ECl@ss 8.1</b>	27371819
<b>ECl@ss 9.0</b>	27371819
<b>ETIM 5.0</b>	EC001449
<b>ETIM 6.0</b>	EC001449
<b>UNSPSC 16.0901</b>	41113704

**Dimensional drawing** (Dimensions in mm (inch))

FLA-MSTR00002

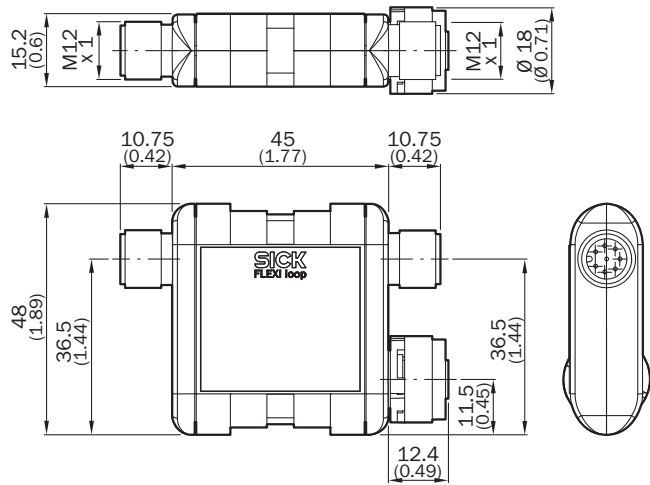

**PIN assignment**

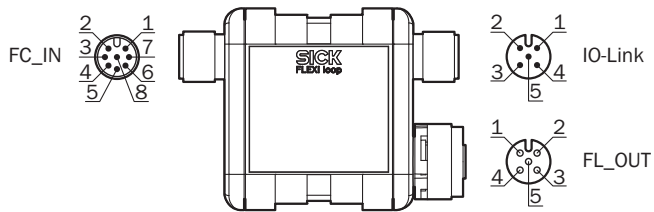

Con- nec- tion	Pin	Sig- nal	Description	Col- or-cod- ed con- nect- ing cable	
FC_IN	1	VDC	24 V supply voltage	White	
	2	VDC	24 V supply voltage		
	3	FC_A	Test input 1		Green
	4	FC_A	Safe output 1		Yellow
	5	GND	GND supply voltage		Gray
	6	GND	GND supply voltage		Pink
	7	FC_B	Test input 2		Blue
	8	FC_B	Safe output 2		Red
IO- Link or AUX_IN/ AUX_OUT	1	VDC	24 V IO-Link supply voltage. IO-Link and Flexi Loop must have separate supply voltages.	Brown	
	2	AUX_I	Non-safe input		White
	3	GND	GND supply voltage		Blue
	4	C/ Q or AUX_Q	IO-Link inter- face/non- safe output		Black
	5	NC	Not connected		Gray

The colors listed apply when using pre-assembled cables (no guarantee).

## Recommended accessories

Other models and accessories → [www.sick.com/Flexi\\_Loop](http://www.sick.com/Flexi_Loop)

	Brief description	Type	Part no.
Mounting brackets and plates			
	1 piece, Flexi Loop fixing clip	C-Fix bracket	2068830

## SICK AT A GLANCE

SICK is one of the leading manufacturers of intelligent sensors and sensor solutions for industrial applications. A unique range of products and services creates the perfect basis for controlling processes securely and efficiently, protecting individuals from accidents and preventing damage to the environment.

We have extensive experience in a wide range of industries and understand their processes and requirements. With intelligent sensors, we can deliver exactly what our customers need. In application centers in Europe, Asia and North America, system solutions are tested and optimized in accordance with customer specifications. All this makes us a reliable supplier and development partner.

Comprehensive services complete our offering: SICK LifeTime Services provide support throughout the machine life cycle and ensure safety and productivity.

For us, that is “Sensor Intelligence.”

## WORLDWIDE PRESENCE:

Contacts and other locations –[www.sick.com](http://www.sick.com)