

## PV FMM-G2C

### Description

TO-220F package type high power diodes suited for solar cell applications.

### Application

- Solar cells
- Bypass diode
  - For reverse current protection

### Features

- High withstand voltage
- Supports high power
- High heat dissipation

### Remarks

### Package

Package Name:TO220F-2



### Specifications

Forward Current	30A
Surge Forward Current	200A
Peak Reverse Voltage	1000V
Storage Temperature	
Max. Forward Voltage Drop	1.1V
Forward Current (Conditions)	30A
Max. Reverse Leakage Current	0.01 $\mu$ A
Reverse Leakage Current Under High Temperature	0.5 $\mu$ A
Junction Temperature (Conditions)	
Thermal Resistance	

### External Dimensions

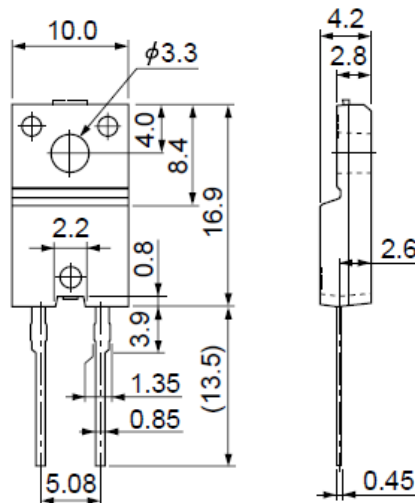

Data sheet

Generated by: <http://www.datasheetcatalog.com/>